

**Board of Trustees  
Board Meeting  
Barton Community College**

**January 14, 2020**

**Camp Aldrich Phase 1:**

**Detail:**

On August 8, 2018, Trails End Cabin was destroyed by a fire. Since that time, we have been working with the insurance adjustors to determine, and agree on, a replacement value. The insurance company has agreed to pay up to \$616,000 + contents + architectural fees (Barton will have a \$25,000 deductible). The stipulation would be that the facility must include all required code upgrades (Fire, ADA).

Various options were provided to the Board for their review. The different options and cost estimates would allow a replacement facility to be constructed in phases if necessary. Bids were requested for the full facility, which would allow between 160-192 beds (depending on configuration). The basic layout of the full facility is provided below.

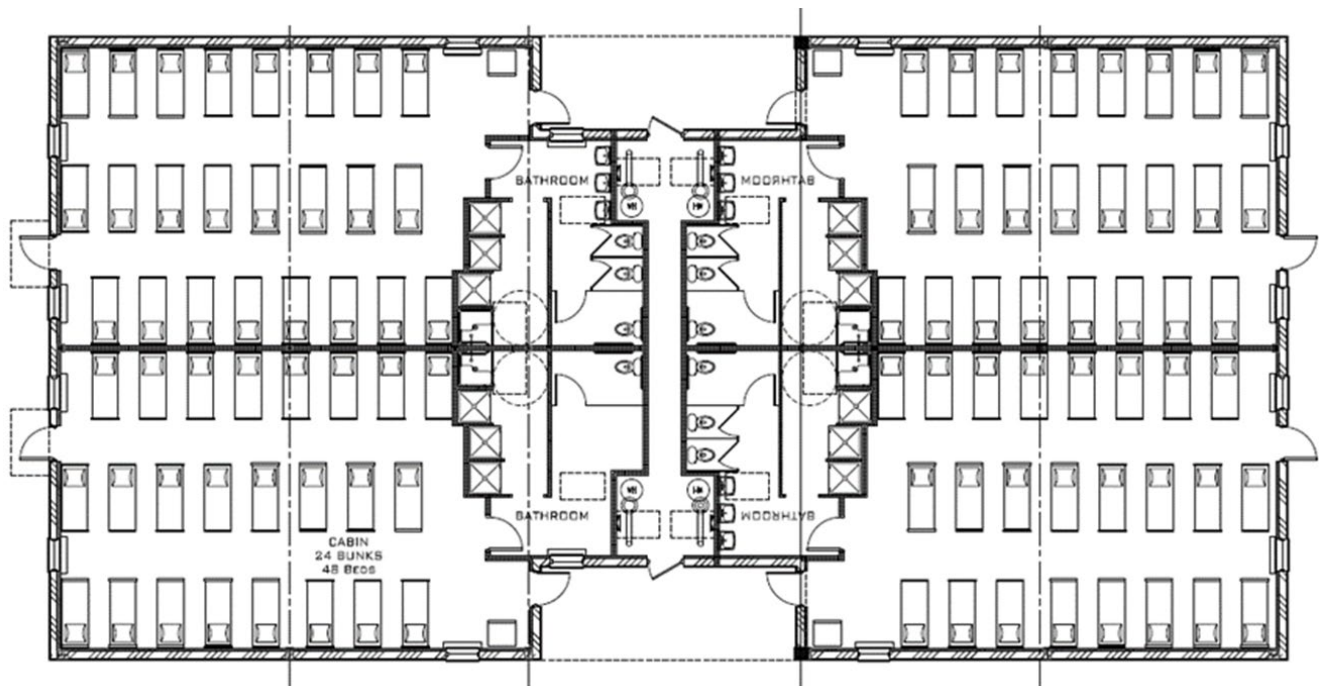

This facility is a basic design. It will have polished concrete floors and the interior walls will be skinned with horizontal metal. If is designed to provide space, energy efficiency, additional restroom facilities, and increased capacity.

The results of the bids are as follows:

<b>01-09-20 Camp Aldrich Trails End Bids:</b>			
	<b>Base Bid</b>	<b>Alternate Bid #1</b>	<b>Total Bid</b>
Joiner Construction (Ellinwood KS)	No Bid	\$0.00	N/A
Harbin Construction (Salina KS)	\$856,000.00	\$79,600.00	\$935,600.00
Brentwood Builders (Great Bend KS)	\$1,053,690.00	\$27,637.00	\$1,081,327.00
Wiens Construction (Hutchinson KS)	\$889,000.00	\$56,000.00	\$945,000.00

All three contractors estimate that the work can be completed by the end of May. These bids cover the construction of the new facility and demo of the remains of Trails End and the demo of Aldrich House. There will be additional costs/reimbursements for the contents and architectural fees (as well as possible change orders). The base bid includes a metal exterior for the building. Alternate #1, adds the same siding as the Dining and Events center (making the two facilities match in color and design).

The College has been attempting to raise additional funds via various Foundations for both Phase I (reconstruction) and Phase II (Pool & Shower house). To date \$366,000 has been raised. An additional application will be submitted to another Foundation requesting supplemental funding for both phases of the project.

**Recommendation:** It is recommended that the Board accept the low bid of \$935,000 from Harbin Construction to rebuild the facility.