

RESIDENCE HALLS

Our unique designs lend themselves to informal living while maintaining a sense of privacy. You'll have a choice of one of four designs. (Subject to availability.)

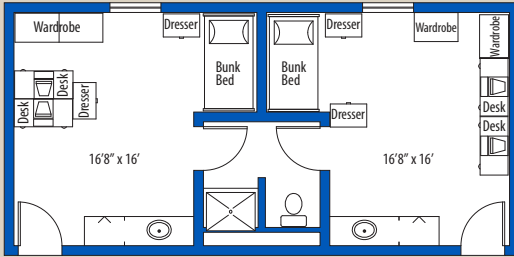

▲ Bluestem Hall: Twin rooms, double occupancy - Shared bath
Handicap accessible rooms available

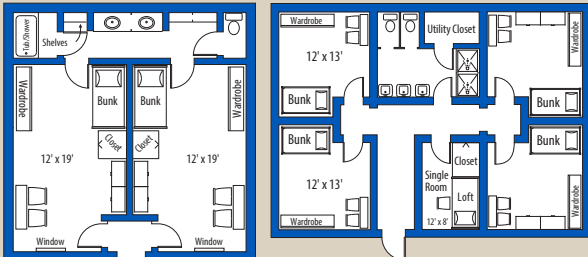

▲ Sunflower Halls:
Twin rooms, double occupancy
Shared bath

▲ Bison Halls:
There will be some variation between units
"Community Style" (9 people per unit)

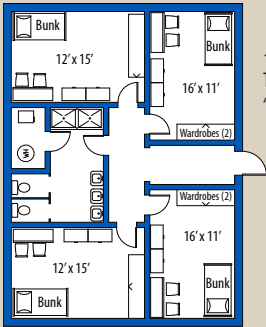

◀ Meadowlark Halls:
There will be some variation between units
"Community Style" (6-8 people per unit)

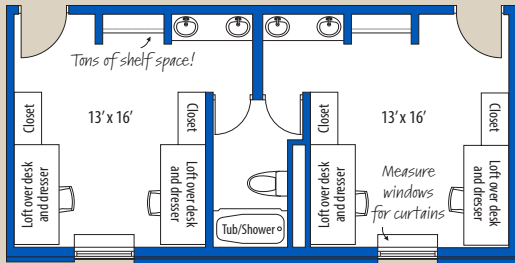

▲ Cottonwood Hall: Twin rooms, double occupancy - Shared bath
Handicap accessible rooms available



MOVIN' IN!

YOUR GUIDE TO RESIDENCE LIFE



DIRECTORY

For more information contact:

Barton Community College
Great Bend, Kansas 67530
(620) 792-2701 or (800) 748-7594

Financial Aid

Office of Financial Aid
(620) 792-9270
financialaid.bartonccc.edu

Applying for Admission

Office of Admissions
(620) 792-9286
GoBarton.com

Residence Life

Office of Residence Life
(620) 792-9281
housing.bartonccc.edu

BARTON

COMMUNITY COLLEGE

245 NE 30 RD • Great Bend, KS 67530

GoBarton.com

Non-Discrimination Notice: To provide equal employment, advancement and learning opportunities to all individuals, employment and student admission decisions at Barton will be based on merit, qualifications, and abilities. Barton County Community College does not discriminate on the basis of any characteristic protected by law in all aspects of employment and admission in its education programs or activities. Any person having inquiries concerning Barton County Community College's non-discrimination compliance policy, including the application of Equal Opportunity Employment, Titles IV, VI, VII, IX, Section 504 and the implementing regulations, is directed to contact the College's Compliance Officer, Barton County Community College, Room A-123, Great Bend, Kansas 67530, (620) 792-2701. Any person may also contact the Director, Office of Civil Rights, U.S. Department of Education, Washington, DC 20201.

BARTON

COMMUNITY COLLEGE

APPLY
ONLINE!
housing.bartonccc.edu



RESIDENCE HALL REQUIREMENTS

Barton requires all full-time Freshman students (those enrolled in 12 or more semester hours with a total of less than 24 successfully passed college credits) to live in college residence halls. A student is exempt from this requirement if he or she meets at least ONE of the following criteria:

- is married,
- is 21 years of age or older,
- has a child or children who reside with him or her,
- is a resident of Barton County or a border county and is residing with parents, legal guardian, or immediate family member of legal age.

ROOMMATES

To select a roommate each party must indicate the other as the requested roommate in eRez housing software. However, the College reserves the right to assign or reassign you to rooms at any time during the year, if the need for change arises.

If you request a specific roommate and if you both submit an application/contract, with the required application fee, at the same time then you may be assigned

Nothing spells fun more than living in a community of 442 of your fellow classmates from all across the world. You will have the opportunity to meet new people, begin life-long friendships, and develop life skills.

Barton considers Student Housing an important part of your total education. Comfortable living conditions have a major influence on your academics, habits, attitudes and ideals. Your social life, loyalty to the college, attitude toward others, and your sense of belonging evolve from the community you'll join in Student Housing.

together. We will make every effort to accommodate roommate requests, however, with numerous competing priorities and appeals, we may not be able to accommodate all requests. Once room assignments and roommate choices are made, notification will be sent out in early July via your Barton email account (cougar.bartonccc.edu).

FOOD SERVICE

Food service is included as part of the housing package. Menus are planned to meet the preferences and normal nutritional standards of college-age students. Food is served in the attractive surroundings of our Student Union.

Most meals are cafeteria style, and buffet dinners are served on special occasions. For the fall and spring semesters, a 19-meal per week plan is included. (Three meals served five days a week and four meals on the weekends.)

POLICIES

As part of the check-in process, you will complete a form to identify any damages or shortages in your room. When residence in Student Housing is terminated, the

housing staff will use the same form to determine any damage other than normal wear. You will be responsible for the furniture, equipment and general condition of your room.

Student Housing is closed during vacation periods for maintenance and repair.

The following may not be kept in rooms: pets, open heating element cooking equipment, fireworks, and firearms or ammunition, except as set forth in Policy 1160. It is against campus policy to gamble or to possess or use drugs on the College property. Similarly, it is against campus policy to possess or use alcoholic beverages on the College property except as set forth in Policy 1220.

You are responsible for cleanliness and orderliness of your room, and should cooperate in maintaining Student Housing and lounge areas. Barton's house-keeping staff will clean bathrooms weekly if the area is clear of all toiletries and personal items.



FEATURES

- Wireless internet campus-wide including student housing
- Three FREE Laundromats
- Meal plan includes 19 meals per week
- Housing for 442 students
- FREE cable and newly released movies available for streaming monthly
- FREE student housing parking
- Vending machines
- Room furniture includes a desk, wardrobe, and extra long twin bed for each resident
- Community meeting room with flat screen television
- ADA compliant rooms
- Community kitchen facilities available with stove, microwave, refrigerator and ice machine
- Designated storm shelter areas
- 24-hour security and camera surveillance

APPLYING

Rooms are reserved on a first come, first serve basis. Please complete the online application form and submit the application deposit. Application will be processed upon receipt of application deposit. All cancellations must be made in writing to the Office of Student Housing. Email housing@bartonccc.edu.

Note: Application deposits are non-refundable.

