

STUDENT HOUSING DEVELOPS COMMUNITY

When you think of Student Housing, perhaps a picture of buildings comes into your mind. Student Housing is buildings, but it's also people living together and forming communities. Our unique designs lend themselves to informal living while maintaining a sense of privacy. You'll have a choice of one of four designs. All rooms shown are double occupancy unless otherwise noted.

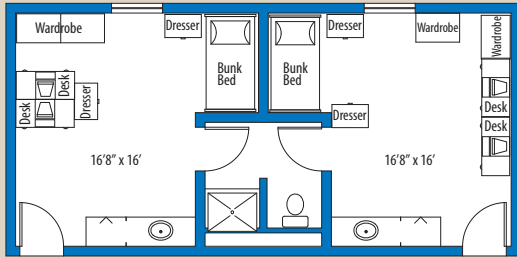

Bluestem Hall: Twin rooms, Double occupancy - Shared bath
Handicap accessible rooms available

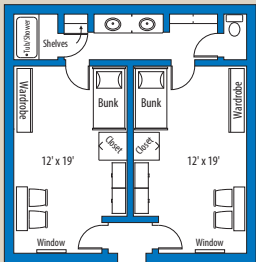

Sunflower Halls:
Twin rooms
Double occupancy
Shared bath

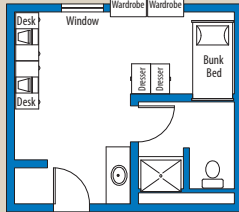

Bluestem Hall: Single rooms,
Double occupancy - Private bath

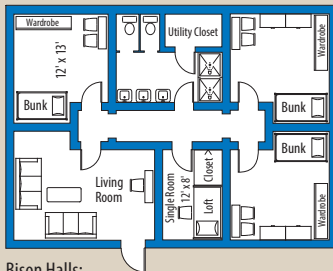

Bison Halls:
There will be some variation between units
"Community Style" (6-7 people per unit)

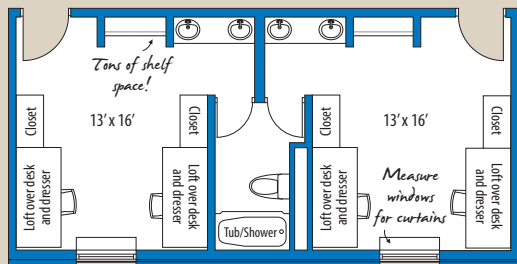

Cottonwood Hall: Twin rooms, Double occupancy - Shared bath
Handicap accessible rooms available

Each room is equipped with extra long (36" x 80") twin beds, mattress, mattress pad, closet, dresser, bookshelf, window shade, desk and chair.



DIRECTORY

For more information contact:

Barton Community College
Great Bend, Kansas 67530
(620) 792-2701 or (800) 748-7594

Applying for Admission

Office of Admissions
(620) 792-9286
GoBarton.com

Financial Aid

Office of Financial Aid
(620) 792-9270
financialaid.bartonccc.edu

Student Housing

Office of Student Housing
(620) 792-9285
housing.bartonccc.edu

BARTON

COMMUNITY COLLEGE

245 NE 30 RD · Great Bend, KS 67530

GoBarton.com

Non-Discrimination Notice: To provide equal employment, advancement and learning opportunities to all individuals, employment and student admission decisions at Barton will be based on merit, qualifications, and abilities. Barton County Community College does not discriminate on the basis of any characteristic protected by law in all aspects of employment and admission in its education programs or activities. Any person having inquiries concerning Barton County Community College's non-discrimination compliance policy, including the application of Equal Opportunity Employment, Titles IV, VI, VII, IX, Section 504 and the implementing regulations, is directed to contact the College's Compliance Officer, Barton County Community College, Room A-123, Great Bend, Kansas 67530, (620) 792-2701. Any person may also contact the Director, Office of Civil Rights, U.S. Department of Education, Washington, DC 20201.

MOVIN' IN!

YOUR GUIDE TO STUDENT HOUSING



APPLY
ONLINE!
housing.bartonccc.edu

BARTON

COMMUNITY COLLEGE

RESIDENCE HALL REQUIREMENTS

Barton requires all full-time Freshman students (those enrolled in 12 or more semester hours with a total of less than 24 successfully passed college credits) to live in college residence halls. A student is exempt from this requirement if he or she meets at least ONE of the following criteria:

- is married,
- is 21 years of age or older,
- has a child or children who reside with him or her,
- is a resident of Barton County or a border county and is residing with parents, legal guardian, or immediate family member of legal age.

ROOMMATES

To select a roommate each party must indicate the other as the requested roommate on the application. However, the College reserves the right to assign or reassign you to rooms at any time during the year, if the need for change arises.

If you request a specific roommate and if you both submit an application/contract, with the required application fee, at the same time then you may be

Nothing spells fun more than living in a community of 384 of your fellow classmates from all across the world. You will have the opportunity to meet new people, begin life-long friendships, and develop life skills.

Barton considers Student Housing an important part of your total education. Comfortable living conditions have a major influence on your academics, habits, attitudes and ideals. Your social life, loyalty to the college, attitude toward others, and your sense of belonging evolve from the community you'll join in Student Housing.

assigned together. We will make every effort to accommodate roommate requests, however, with numerous competing priorities and appeals, we may not be able to accommodate all requests. Once room assignments and roommate choices are made, notification will be sent out in early July via mail and Barton email. **Please remember to check for emails from Barton in the 'spam' folder of your bartoncougars.org gmail account. If you find emails from Barton in your 'spam' folder, please mark as 'not spam,' to ensure that you receive important and timely information from us.** (As the start of the fall semester draws closer, notification will be made only via email, phone, or upon check-in.)

FOOD SERVICE

Food service is included as part of the housing package. Menus are planned to meet the preferences and

normal nutritional standards of college-age men and women. Food is served in the attractive surroundings of our Student Union.

Most meals are cafeteria style, and buffet dinners are served on special occasions. For the fall and spring

semesters, a 19-meal per week plan is included. (Three meals served five days a week and four meals on the weekends.)

POLICIES

As part of the check-in process, you will complete a form to identify any damages or shortages in your room. When residence in Student Housing is terminated, the housing staff will use the same form to determine any damage other than normal wear. You will be responsible for the furniture, equipment and general condition of your room.

Student Housing is closed during vacation periods for maintenance and repair.

The following may not be kept in rooms: pets, open heating element cooking equipment, fireworks, and firearms or ammunition, except as set forth in Policy 1160. It is against campus policy to gamble or to possess or use drugs on the College property. Similarly, it is against campus policy to possess or use alcoholic beverages on the College property except as set forth in Policy 1220.

You are responsible for cleanliness and orderliness of your room, and should cooperate in maintaining Student Housing and lounge areas. Barton's house-keeping staff will clean bathrooms weekly if the area is clear of all toiletries and personal items.

FEATURES

- Wireless internet campus-wide including student housing
- Three FREE Laundromats
- Meal plan includes 19 meals per week
- Housing for 384 students
- FREE cable and 12 newly released movies available for streaming monthly
- FREE student housing parking
- Vending machines
- Room furniture includes a desk, wardrobe, and extra long twin bed for each resident
- Community meeting room with flat screen television
- ADA compliant rooms
- Community kitchen facilities available with stove, microwave, refrigerator and ice machine
- Designated storm shelter areas
- 24-hour security and camera surveillance
- Eco-friendly drinking water stations

APPLYING

Rooms are reserved on a first come, first serve basis. Please complete the online application form and submit the application fee. Application will be processed upon receipt of application fee. All cancellations must be made in writing to the Office of Student Housing. Email studenthousing@bartonccc.edu.

Note: Application fees are non-refundable.

