

Manufacturing Skills Program

bartonccc.edu

What drives you?
BARTON
COMMUNITY COLLEGE

For more information, contact:

Tina Grillot
Coordinator of Industrial
Technology Programs
grillott@bartonccc.edu
(620) 792-9325
(866) 813-2462



The Manufacturing Skills Program provides students with the skills necessary to obtain an entry level manufacturing job. The program covers various manufacturing skills, such as basic mathematics, industry standards, and blueprint reading.

Why Barton?

- Class size support student one-on-one attention.
- Hands-on opportunities providing real world experience.
- Student system to assist students inside and outside of the classroom.
- Curriculum established by business needs and validated by industry employers.
- Manufacturing Skills Program can be paired with Kansas WORKReady!

Occupational Outlook:

- Kansas Median Wages (2012-2022), \$12.40 hourly, \$25,800 annually.
- Employment (2010-2020), 5,860 employees.
- Projected Need (2010-2020), 6% increase.

Source: Career OneStop

Career Options:

- Entry level positions in food, paper, chemical, primary metal manufacturing and textile mills.

Industries that employed the largest number of manufacturing technicians included: machinery manufacturing, transportation equipment manufacturing, petroleum - coal products manufacturing, repair and maintenance, and plastics - rubber products manufacturing.

Non-discrimination Notice: Barton Community College is an equal opportunity provider and employer. Visit equal.bartonccc.edu for more information.

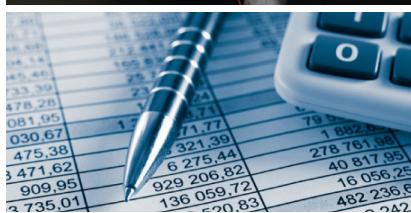
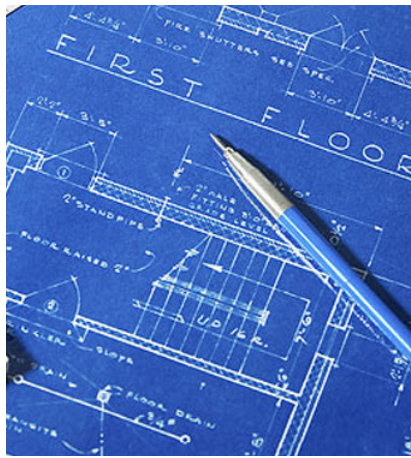

WWW.BARTONCCC.EDU

866-813-2462 © 245 NE 30 RD © GREAT BEND, KS 67530