

ABOUT CAMP ALDRICH

Camp Aldrich provides a relaxing setting for summer camps, business retreats, reunions, weddings, conferences and recreational events. This area is the most comprehensively developed camp site in central Kansas.

ACTIVITIES

Hay Rack Rides

Pulled with Tractor (weather permitting) tour Camp Aldrich property \$20/ride, typically accommodates about 20-25 individuals.

Bow Hunting

Limited hunting is available by reservation only. Hunting reservations include sleeping accommodations at Camp Aldrich. Please contact Camp Aldrich Facility Management at (620) 792-9340 for more information.

Sports & Playground Equipment

Softball, volleyball, horseshoes, basketball, and playground equipment are available year round (no charge).

Swimming Pool

(Available Memorial Day through Labor Day) - \$40/hr.



campaldrich.bartonccc.edu

DIRECTIONS

2 miles north of Hwy. 156

Between Claflin, KS and the
Cheyenne Bottoms Wildlife Area

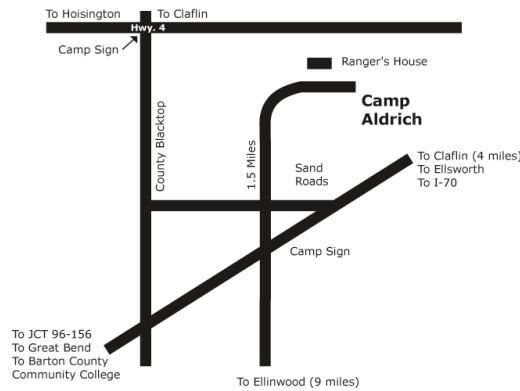

CONTACT INFORMATION

Facility Management

245 NE 30 RD
Great Bend, KS 67530

Email: campaldrich@bartonccc.edu

Office: (620) 792-9340

Fax: (620) 786-1163



Camp Aldrich

A learning facility of

BARTON
COMMUNITY COLLEGE

Please Note: Barton Community College assumes no liability for injuries resulting from the use of Camp Aldrich (including contact with wildlife and domestic animals).

Non-discrimination Notice: Barton Community College is an equal opportunity provider and employer. Visit equal.bartonccc.edu for more information.

CAMP ALDRICH



BOW HUNTING



LODGES



DINING & EVENTS CENTER

DINING AND EVENTS CENTER



- » Available year round.
- » Central heat and air.
- » Banquet seating for 300 people upstairs and a meeting room in the basement that will accommodate 150 people.
- » To aid in your presentations or programs, audio/visual equipment is available upon request.
- » You may contact Barton Community College's food service at (620) 792-9259 to cater meals ranging from banquets to picnics.
- » Or, you may choose to prepare your meals yourself, or make other catering arrangements. The Dining and Events Center also includes a fully equipped, industrial kitchen and a covered patio featuring two large barbecue grills.

SUNDOWNER LODGE



- » Available April 1st through October 31st.
- » Central heat and air.
- » Sleeping capacity of 16.
- » Indoor restroom/tub facilities.

All campers must provide their own sleeping bags/linens.

MARTIN LODGE



- » Available year round.
- » Central heat and air.
- » Sleeping capacity of 4. Two bedrooms with two beds each.
- » Indoor restroom/shower facilities.
- » Kitchen facilities.
- » WiFi, TV, DVD & Blue Ray available (hunting reservations only).

TRAIL'S END LODGE

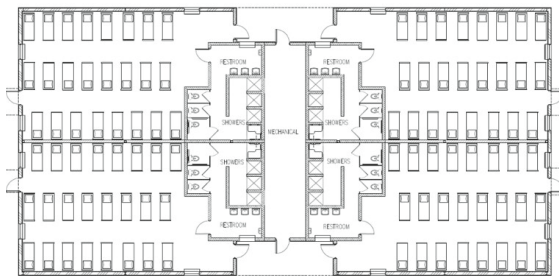

- » Available year round.
- » Central heat and air.
- » Four pods each with a sleeping capacity of 48.
- » Indoor restroom/shower facilities in each pod.
- » Wi-Fi available.



BATHHOUSE

- » Available April 1st through October 31st.
- » Centrally located and available to all groups.
- » Men's and women's restroom/shower facilities.

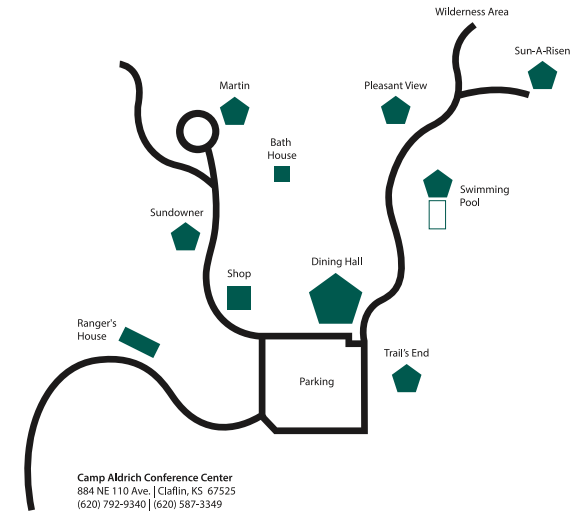

LODGE PRICING

LODGES	RATE PER DAY (Midnight to Midnight)	CAPACITY
Dining and Event Center	M-Th \$450 F-Su \$1,100*	300
Martin	\$180	4
Trail's End	\$180	48 per pod
Sundowner	\$180	16

* Premium - For a single event occurring on a Fri/Sat/Sun, the rate of \$1,100 will be charged for one day and the other premium days can be added for \$100 per day. An additional \$100 refundable damage deposit is required at the time of the contract. Please contact campaldrich@bartonccc.edu to verify the cost for an event.

Dining and Events Center (available year round) includes basement meeting room, kitchen and patio area. Beds may only be set up in basement if all other sleeping facilities are rented.