

CALENDAR VIEWBOOK  
2018-19



*Welcome to*  
**BARTON**  
COMMUNITY COLLEGE

---

*Established 1965*  
*Opened 1969*

**WHAT DRIVES YOU?**

GoBarton.com      

# Cativities

Memories fur  
the making!

BARTON HAS MORE THAN  
50 FUN STUDENT ACTIVITIES  
PLANNED THROUGH THE YEAR!

Hawaiian Luau

\$4 Movie Nights

Free Shoulder Massages

Dance Nights

Bowling Nights

Mix and Mingle Bingo

Casino Night

Ice Cream Socials

Late Night Breakfasts

Mardi Gras Celebration

Cinco de Mayo

Skating and Laser Tag Nights



# SEPTEMBER 2018

AUGUST 2018						
S	M	T	W	T	F	S
			1	2	3	4
5	6	7	8	9	10	11
12	13	14	15	16	17	18
19	20	21	22	23	24	25
26	27	28	29	30	31	

OCTOBER 2018						
S	M	T	W	T	F	S
	1	2	3	4	5	6
7	8	9	10	11	12	13
14	15	16	17	18	19	20
21	22	23	24	25	26	27
28	29	30	31			

## SUNDAY

## MONDAY

## TUESDAY

## WEDNESDAY

## THURSDAY

## FRIDAY

## SATURDAY

Women's Soccer at Rose State College 2 p.m.

# 2

BARTonline Fall Session 3 (6 weeks) Last Day to Add  
Men's Soccer at Northeast CC 4 p.m.

# 9

BARTonline Fall Session 3 (6 weeks) Last Day to Drop with 100% Refund

# 16

# 23

BARTonline Fall Session 1 (8 weeks) Last Day to Drop with a Grade of W  
M&W Tennis Oracle/ITA Central Regional Championships at Winfield, KS 9 a.m.

Labor Day (No Classes-Offices Closed)

# 3

BARTonline Fall Session 3 (6 weeks) Classes Begin  
Men's & Women's Golf Central Kansas Classic at McPherson, KS 9 a.m.  
Skating and Laser Tag 7-9 p.m., Up & Rolling Skate Center  
Planetarium Show: Fall Stars 7 p.m.

# 10

Constitution Day  
Volleyball vs Garden City CC 6:30 p.m.  
Planetarium Show: Four Planets! 7 p.m.

# 17

National Coffee Day 9-11 a.m., Learning Resource Center – Coffee Cove  
Bingo 6 p.m., Union  
Volleyball at Butler CC 6:30 p.m.  
Planetarium Show: Science Magic 7 p.m.

# 24

# 4

Men's & Women's Golf Central Kansas Classic at McPherson, KS 9 a.m.

# 11

# 18

# 25

Women's Soccer vs Garden City CC 2 p.m.  
Men's Soccer vs Garden City CC 4 p.m.

# 5

Women's Soccer vs Hesston College 2 p.m.  
Men's Soccer vs Hesston College 4 p.m.  
Beyond Words: History of the Graphic Novel Exhibit Begins, Shafer Gallery

# 12

Last Day to Drop Courses Recorded as W on transcript for 1st 8-week Session  
Women's Soccer vs Pratt CC 2 p.m.  
Men's Soccer vs Pratt CC 4 p.m.  
Volleyball at Colby CC 6:30 p.m.

# 19

Women's Soccer vs Northwest Kansas Technical College 2 p.m.  
Men's Soccer vs Northwest Kansas Technical College 4 p.m.  
Volleyball at Independence CC 6:30 p.m.  
Free Bowling 7:30-9 p.m., Walnut Bowl

# 26

\$4 Movie Night, Golden Belt Cinema 6

# 6

Free Shoulder Massages 6-9 p.m., Union – Game Room

# 13

\$4 Movie Night, Golden Belt Cinema 6

# 20

# 27

Volleyball vs Costal Bend College at Baytown, TX 9 a.m.  
Volleyball vs Navarro College at Baytown, TX 1 p.m.

# 7

# 14

Swimming at Oklahoma Baptist University Invitational at Shawnee, OK 4 p.m.

# 21

M&W Tennis Oracle/ITA Central Regional Championships at Winfield, KS 9 a.m.  
Volleyball vs Iowa Central CC at Arkansas City, KS 2 p.m.  
Volleyball vs Cowley CC at Arkansas City, KS 6 p.m.

# 28

Priority Deadline to Apply for Fall 2018 Graduation  
Volleyball vs Casper College 2 p.m.  
Volleyball vs Pratt CC 4 p.m.  
Women's Soccer vs Seminole State College at Midwest City, OK 4 p.m.  
Men's Soccer at Northern Oklahoma-Tonkawa 4 p.m.

Volleyball vs Cisco College at Baytown, TX 9 a.m.  
Volleyball vs Lee College at Baytown, TX 1 p.m.  
Men's Soccer at Iowa Western CC 4 p.m.  
Women's Soccer at Hutchinson CC 6 p.m.  
Topographies: Installations By Blivens and Heimbaugh Exhibit Ends, Shafer Gallery

Women's Soccer vs Dodge City CC 2 p.m.  
Men's Soccer vs Dodge City CC 4 p.m.

# 15

Tenth Annual Wounded Warrior Golf Tournament 9:30 a.m.  
Women's Soccer at Cloud County CC 2 p.m.  
Men's Soccer at Cloudy County CC 4 p.m.

# 22

M&W Tennis Oracle/ITA Central Regional Championships at Winfield, KS 9 a.m.  
Volleyball vs Carl Sandburg at Arkansas City, KS 10 a.m.  
Volleyball vs Northeastern Oklahoma A&M at Arkansas City, KS 2 p.m.  
Women's Soccer at Garden City CC 5 p.m.  
Men's Soccer at Garden City CC 7:30 p.m.

# 29

# Fall in Love with Barton

Don't furrget to register fur  
Senior Day November 14

REGISTRATION ENDS OCTOBER 31.  
CHECK [SENIORDAY.BARTONCCC.EDU](http://SENIORDAY.BARTONCCC.EDU)  
FOR DETAILS!

**SENIOR  
DAY**



# OCTOBER 2018

SEPTEMBER 2018						
S	M	T	W	T	F	S
						1
2	3	4	5	6	7	8
9	10	11	12	13	14	15
16	17	18	19	20	21	22
23	24	25	26	27	28	29
30						

NOVEMBER 2018						
S	M	T	W	T	F	S
						1 2 3
4	5	6	7	8	9	10
11	12	13	14	15	16	17
18	19	20	21	22	23	24
25	26	27	28	29	30	

## SUNDAY

## MONDAY

## TUESDAY

## WEDNESDAY

## THURSDAY

## FRIDAY

## SATURDAY

7

BARTonline Fall Session 1 (8 weeks) Ends  
Dance Theatre NDEO Conference at San Diego, CA TBA  
Barton Theatre Production, "Harvey," 2 p.m., Fine Arts Auditorium  
Avguste Antonov, Piano Recital, "Steinway Concert," 2 p.m., Morrison Chapel

14

BARTonline Fall Session 3 (6 weeks) Last Day to Drop with a Grade of W  
BARTonline Fall Session 4 (8 weeks) Last Day to Add  
Women's Golf Crossroad JUCO Invitational at Wentzville, MO 9 a.m.

21

BARTonline Fall Session 5 (6 weeks) Last Day to Add  
Men's & Women's Golf Barton Invitational 9 a.m.  
CKPTL Boys Recital, 2:30 p.m., Shafer Art Gallery

28

Men's & Women's Golf at KWU Fall Invitational 9 a.m.  
Volleyball at Dodge City CC 6:30 p.m.

1

Classes Begin – 2nd 8-week Session  
Men's Golf NJCAA District III Preview at Gothenburg, NE 9 a.m.  
Volleyball at Pratt CC 6:30 p.m.  
Planetarium Show: Biology Doubleheader 7 p.m.

8

BARTonline Fall Session 4 (8 weeks) Classes Begin  
Escape Room, Learning Resource Center – Library  
Women's Golf Crossroads JUCO Invitational at Wentzville, MO 9 a.m.  
Men's Golf Blue Devil Fall Classic at Kansas City, KS 9 a.m.  
Volleyball vs Seward County CC 6:30 p.m.

22

Men's Golf Park University Fall Classic at Kansas City, MO 9:30 a.m.  
Volleyball vs Hutchinson CC 6:30 p.m.

29

BARTonline Fall Session 5 (6 weeks) Classes Begin  
Women's Golf Sterling Fall Invitational at Hutchinson, KS TBA

Men's & Women's Golf at KWU Fall Invitational 9 a.m.

2

Men's Golf NJCAA District III Preview at Gothenburg, NE 9 a.m.  
Fall Student Production Auditions 5-6:30 p.m., Fine Arts Auditorium

9

Escape Room, Learning Resource Center – Library  
Men's Golf Blue Devil Fall Classic at Kansas City, KS 9 a.m.

16

Men's Golf Park University Fall Classic at Parkville, MO 9:30 a.m.

23

Spring 2019 Registration Begins (Current Students)  
Women's Golf Sterling Fall Invitational at Hutchinson, KS TBA  
Volleyball Region VI Tournament TBA  
Emotion Matrix Virtual Reality Video Game 5-9 p.m., Union

30

Women's Soccer vs Hutchinson CC 2 p.m.  
\$4 Movie Night, Golden Belt Cinema 6

Women's Soccer vs Hutchinson CC 2 p.m.  
\$4 Movie Night, Golden Belt Cinema 6

3

Women's Soccer at Dodge City CC 2 p.m.  
Men's Soccer at Dodge City CC 4 p.m.  
Fall Student Production Auditions 5-6:30 p.m., Fine Arts Auditorium  
Volleyball at Seward County CC 6:30 p.m.  
Planetarium Show: Solar System Doubleheader 7 p.m.  
Free Bowling 7:30-9 p.m., Walnut Bowl

17

Women's Golf Baker University Fall Invitational at Lawrence, KS 8 a.m.  
Escape Room, Learning Resource Center – Library  
Women's Soccer vs Cloud County CC 2 p.m.  
Men's Soccer vs Cloudy County CC 4 p.m.  
Volleyball vs Colby CC 6:30 p.m.  
Planetarium Show: Light! 7 p.m.

24

Volleyball vs Butler CC 6:30 p.m.

31

Women's Golf Baker University Invitational at Lawrence, KS 8 a.m.  
Escape Room, Learning Resource Center – Library  
\$4 Movie Night, Golden Belt Cinema 6

Dance Theatre NDEO Conference at San Diego, CA TBA

4

Bingo 6 p.m., Union  
Sneak Preview Concert : Music/Dance Theatre 7:30 p.m., Fine Arts Auditorium

11

Women's Golf Baker University Invitational at Lawrence, KS 8 a.m.  
Escape Room, Learning Resource Center – Library

18

\$4 Movie Night, Golden Belt Cinema 6

25

Student Recital 4 p.m., Morrison Chapel  
Karaoke 6-7:30 p.m., Union

22

BCAC Friends and Acquaintances Exhibit Begins, Shafer Gallery  
McKown Artist Ball, Shafer Gallery

Last Day – 1st 8-week Session  
Dance Theatre NDEO Conference at San Diego, CA TBA

5

Volleyball vs Labette CC 2 p.m.  
Volleyball vs Iowa Western CC 6 p.m.  
Swimming at Iowa Central CC 6:30 p.m.

12

Barton Theatre Production, "Harvey," 7:30 p.m., Fine Arts Auditorium

19

Last Day for Refund – 2nd 8-week Session

26

KTMA District V Auditions, 9-12 p.m., Morrison Chapel & F156  
Women's Soccer at Pratt CC 1 p.m.  
Men's Soccer at Pratt CC 3 p.m.

23

Women's Soccer at Northwest Kansas Technical College 2 p.m.  
Men's Soccer at Northwest Kansas Technical College 4 p.m.  
Volleyball at Garden City CC 6 p.m.  
Beyond Words: History of the Graphic Novel Exhibit Ends, Shafer Gallery

Dance Theatre NDEO Conference at San Diego, CA TBA  
Volleyball vs Cloud County CC 12 p.m.  
Women's Soccer at Hesston College 5 p.m.  
Volleyball vs Southeast CC 6 p.m.  
Swimming vs Midland University & Tabor College at Fremont, NE 7 p.m.  
Men's Soccer at Hesston College 7:30 p.m.  
Barton Theatre Production, "Harvey," 7:30 p.m., Fine Arts Auditorium

6

KTMA District V Auditions, 9-12 p.m., Morrison Chapel & F156  
Women's Soccer at Pratt CC 1 p.m.  
Men's Soccer at Pratt CC 3 p.m.

13

Women's Soccer at Northwest Kansas Technical College 2 p.m.  
Men's Soccer at Northwest Kansas Technical College 4 p.m.  
Volleyball at Garden City CC 6 p.m.  
Beyond Words: History of the Graphic Novel Exhibit Ends, Shafer Gallery

20

Volleyball vs Independence CC 2 p.m.  
Tabor Voice Festival at Tabor College TBA

27

BCAC Friends and Acquaintances Exhibit Begins, Shafer Gallery  
McKown Artist Ball, Shafer Gallery

24

Volleyball vs Southeast CC 6 p.m.  
Swimming vs Midland University & Tabor College at Fremont, NE 7 p.m.  
Men's Soccer at Hesston College 7:30 p.m.  
Barton Theatre Production, "Harvey," 7:30 p.m., Fine Arts Auditorium

# Meow is the Time to Come on a Campus Visit

We'd love to meet you!

Free

- PARKING!
- LUNCH!
- SMILES!
- T-SHIRT!
- APPLICATION FUR  
ADMISSION!

## Schedule a Tour!

Tours are scheduled

Monday - Friday 8:30 a.m. - 3 p.m.

Go online to [GoBarton.com/admissions](http://GoBarton.com/admissions)  
or call (800) 722-6842 to schedule a tour today!



# NOVEMBER 2018

OCTOBER 2018						
S	M	T	W	T	F	S
	1	2	3	4	5	6
7	8	9	10	11	12	13
14	15	16	17	18	19	20
21	22	23	24	25	26	27
28	29	30	31			

DECEMBER 2018						
S	M	T	W	T	F	S
						1
2	3	4	5	6	7	8
9	10	11	12	13	14	15
16	17	18	19	20	21	22
23	24	25	26	27	28	29
30	31					

## SUNDAY

## MONDAY

## TUESDAY

## WEDNESDAY

## THURSDAY

## FRIDAY

## SATURDAY

BARTonline Fall Session 5 (6 weeks) Last Day to Drop with 100% Refund  
 NATS Competition at Lincoln, NE  
 Wrestling OCU Open at Oklahoma City, OK 9 a.m.  
 Volleyball Region VI Tournament TBA

# 4

Last Day to Drop Courses Recorded as W on Transcript for Full Term Session  
 Barton Theatre Student Production 7:30 p.m., Fine Arts Auditorium  
 \$4 Movie Night, Golden Belt Cinema 6

# 5

Women's Basketball vs Kansas Wesleyan JV 5:30 p.m.  
 Men's Basketball vs Kansas Wesleyan JV 7:30 p.m.

# 6

Women's Basketball vs Sterling College JV 5:30 p.m.  
 Men's Basketball vs Sterling College JV 7:30 p.m.

# 7

**Senior Day**  
 Last Day to Drop Courses Recorded as W on Transcript for 2nd 8-week Session  
 Free Bowling 7:30-9 p.m., Walnut Bowl

# 14

NATS Competition at Lincoln, NE

# 1

Free Shoulder Massages 6-9 p.m., Union – Game Room

# 8

Bingo 6 p.m., Union  
 Instrumental Concert 7:30 p.m., Fine Arts Auditorium  
 Men's Basketball vs TBA 7:30 p.m.

# 15

NATS Competition at Lincoln, NE  
 Men's Basketball vs Lamar CC at Liberal, KS 1 p.m.

# 2

Women's Basketball vs Northeastern Oklahoma A&M 5:30 p.m.  
 Men's Basketball vs Redlands CC 7:30 p.m.

# 9

NATS Competition at Lincoln, NE  
 Swimming vs Midland University & Tabor College at Fremont, NE 1 p.m.  
 Men's Basketball vs Northern Oklahoma College-Enid at Liberal, KS 4 p.m.

# 3

Wrestling Swede Open at Lindsborg, KS 9 a.m.  
 Dance Theatre Audition for Spring 2019 10-11:15 a.m., Studio 34  
 Women's Basketball vs Murray State 5:30 p.m.  
 Swimming Mustang Invitational at Sioux City, IA TBA

# 10

Wrestling UNK Holiday Inn Open at Kearney, NE 9 a.m.  
 Swimming vs William Jewel College & Iowa Central CC at Liberty, MO TBA

# 17

# 11

# 12

# 13

Thanksgiving Break (Campus Closed)

Thanksgiving Break (Campus Closed)

# 16

Men's Basketball vs Midland College at McKinney, TX 5 p.m.

# 18

# 19

# 20

# 21

# 22

# 23

# 24

Library Fall Finals Extended Hours  
 Skating & Laser Tag 7-9 p.m., Up & Rolling Skate Center

Library Fall Finals Extended Hours

Library Fall Finals Extended Hours  
 History of Dance 7:30 p.m., Studio 34  
 Women's Basketball vs Hesston College 5:30 p.m.  
 Men's Basketball vs TBA 7:30 p.m.

Library Fall Finals Extended Hours  
 Student Recital 4 p.m., Morrison Chapel  
 \$4 Movie Night, Golden Belt Cinema 6

Swimming Hendrix Invitational at Conway, AR TBA

# 25

# 26

# 27

# 28

# 29

# 30



# Happy Paw-lidays!

Get a jumpstart on your future with BARTonline!

## WINTER INTERSESSION – 4 WEEK

December 10 - January 6

### Spring 2019

Session 1	8 week	January 14 - March 10
Session 2	16 week	January 21 - May 12
Session 3	6 week	February 11 - March 24
Session 4	8 week	March 18 - May 12
Session 5	6 week	April 1 - May 12

## SPRING INTERSESSION – 4 WEEK

April 15 - May 12

### Summer 2019

Session 1	6 weeks	May 13 - June 23
Session 2	8 weeks	June 10 - August
Session 3	6 weeks	June 24 - August 4

**BARTonline.org**  
YOUR COMMUNITY COLLEGE SOLUTION



# DECEMBER 2018

NOVEMBER 2018						
S	M	T	W	T	F	S
				1	2	3
4	5	6	7	8	9	10
11	12	13	14	15	16	17
18	19	20	21	22	23	24
25	26	27	28	29	30	

JANUARY 2019						
S	M	T	W	T	F	S
		1	2	3	4	5
6	7	8	9	10	11	12
13	14	15	16	17	18	19
20	21	22	23	24	25	26
27	28	29	30	31		

## SUNDAY

## MONDAY

## TUESDAY

## WEDNESDAY

## THURSDAY

## FRIDAY

## SATURDAY

BARTonline Fall Session 2 (16 weeks) Last Day to Drop with a Grade of W  
 BARTonline Fall Session 4 (8 weeks) Last Day to Drop with a Grade of W  
 BARTonline Fall Session 5 (6 weeks) Last Day to Drop with a Grade of W  
 Holiday Open House, Shafer Gallery  
 Wrestling Bob Smith Open at Hays, KS 9 a.m.  
 Dress Rehearsal for Holiday Concert 7:30 p.m., Fine Arts Auditorium

Summer 2019 Registration Begins  
 Holiday Concert 7:30 p.m., Fine Arts Auditorium

Late Night Breakfast 8-9 p.m., Union

First Day of Finals  
 Women's Basketball at Coffeyville CC 5:30 p.m.  
 Men's Basketball at Coffeyville CC 7:30 p.m.

Finals

Finals

Women's Basketball at Cowley CC 4 p.m.  
 Men's Basketball at Cowley CC 6 p.m.  
 Swimming Hendrix Invitational at Conway, AR TBA  
 Jingle Bell Swing 8-11 p.m.

1

Airport/Bus Transportation, Sign up Required, Wichita TBA  
 Wrestling Doane Open at Crete, NE 9 a.m.  
 Women's Basketball vs Independence CC 5:30 p.m.  
 Men's Basketball vs Independence CC 7:30 p.m.  
 BCAC Friends and Acquaintances Exhibit Ends, Shafer Gallery

BARTonline Fall Session 2 (16 weeks) Ends  
 BARTonline Fall Session 4 (8 weeks) Ends  
 BARTonline Fall Session 5 (6 weeks) Ends  
 BARTonline Winter Intercession (4 weeks) Last Day to Add  
 Wrestling 9th Annual Reece Wright-Conklin Jet Invitational at Wichita, KS 9 a.m.

Last Day of Finals  
 Last Day - Full Term and 2nd 8-week Sessions  
 BARTonline Winter Intercession (4 weeks) Classes Begin  
 BARTonline Winter Intercession (4 weeks) Last Day to Drop with 100% Refund  
 Women's Basketball at Neosho County CC 5:30 p.m.  
 Dance Theatre 2nd Audition for Spring 2019 6-7:15 p.m., Studio 34  
 Men's Basketball at Neosho County CC 7:30 p.m.

No Class/Campus Open

No Class/Campus Open

No Class/Campus Open

No Class/Campus Open

2

No Class/Campus Open

No Class/Campus Open

Christmas/New Year Break Begins  
 Campus Closed

Campus Closed

Campus Closed

16

17

18

19

20

21

22

23

Campus Closed  
 Christmas Eve  
 24

Campus Closed  
 Christmas Day

Campus Closed

Campus Closed

Campus Closed  
 Women's Basketball Hutchinson Classic at Hutchinson, KS TBA

Women's Basketball Hutchinson Classic at Hutchinson, KS TBA

30

Christmas Eve  
 31

25

26

27

28

29

WHAT DRIVES YOU?

CollegeNEWS | news.bartoncc.edu

**We're a Smitten Kitten  
fur YOU!**



**JUNIOR  
DAY**



**DON'T FURGET TO REGISTER FUR JUNIOR DAY FEBRUARY 13!  
REGISTRATION ENDS FEBRUARY 1.  
CHECK JUNIORDAY.BARTONCCC.EDU FUR DETAILS!**

# JANUARY 2019

DECEMBER 2018						
S	M	T	W	T	F	S
						1
2	3	4	5	6	7	8
9	10	11	12	13	14	15
16	17	18	19	20	21	22
23	24	25	26	27	28	29
30	31					

FEBRUARY 2019						
S	M	T	W	T	F	S
						1 2
3	4	5	6	7	8	9
10	11	12	13	14	15	16
17	18	19	20	21	22	23
24	25	26	27	28		

SUNDAY	MONDAY	TUESDAY	WEDNESDAY	THURSDAY	FRIDAY	SATURDAY
		New Year's Day Campus Closed	No Classes/Offices Open		Wrestling NWCA Multi-Divisional National Duals NJCAA at Louisville, KY TBA	Airport/Bus Station Pick up, Wichita TBA Wrestling NWCA Multi-Divisional National Duals NJCAA at Louisville, KY TBA Women's Basketball vs Butler CC 5:30 p.m. Men's Basketball vs Butler CC 7:30 p.m.
		<b>1</b>	<b>2</b>	<b>3</b>	<b>4</b>	<b>5</b>
	Classes Begin – Full Term and 1st 8-week Session Late Registration Begins		Women's Basketball at Cloud County CC 6 p.m. Men's Basketball at Cloud County CC 8 p.m. \$4 Movie Night, Golden Belt Cinema 6		Late Registration Ends	Women's Basketball vs Allen County CC 5:30 p.m. Men's Basketball vs Allen County CC 7:30 p.m.
<b>6</b>	<b>7</b>	<b>8</b>	<b>9</b>	<b>10</b>	<b>11</b>	<b>12</b>
BARTonline Spring Session 1 (8 weeks) Last Day to Add Wrestling Kansas Cup at Hays, KS 9 a.m.	BARTonline Spring Session 1 (8 weeks) Classes Begin Rehearsals for Community Choir Begin Women's Basketball vs Pratt CC 5:30 p.m. Men's Basketball vs Pratt CC 7:30 p.m.	Audition for Spring Play, "Rumors," 5-6:30 p.m., Fine Arts Auditorium	Audition for Spring Play, "Rumors," 5-6:30 p.m., Fine Arts Auditorium Women's Basketball at Dodge City CC 5:30 p.m. Wrestling vs Cloud County CC 7 p.m. Men's Basketball at Dodge City CC 7:30 p.m. Free Bowling 7:30-9 p.m., Walnut Bowl		Last Day for Refund – Full Term and 1st 8-week Session Wrestling Midwest Duals at Kearney, NE TBA BaRTaRT: BCC Student/Faculty Exhibit Begins, Shafer Gallery	Swimming Colorado College Classic at Colorado Springs, CO TBA Women's Basketball vs Colby CC 5:30 p.m. Men's Basketball vs Colby CC 7:30 p.m.
<b>13</b>	<b>14</b>	<b>15</b>	<b>16</b>	<b>17</b>	<b>18</b>	<b>19</b>
BARTonline Spring Session 1 (8 weeks) Last Day to Drop with 100% Refund BARTonline Spring Session 2 (16 weeks) Last Day to Add Wrestling Central Missouri Open at Warrensburg, MO 9 a.m. Swimming Colorado College Classic at Colorado Springs, CO TBA	Martin Luther King Jr. Day (Campus Closed) BARTonline Spring Session 2 (16 weeks) Classes Begin		Women's Basketball at Northwest Kansas Technical College 6 p.m. Wrestling vs Northwest Kansas Technical College 7 p.m. Men's Basketball at Northwest Kansas Technical College 8 p.m.	\$4 Movie Night, Golden Belt Cinema 6		Women's Basketball at Seward County CC 6 p.m. Men's Basketball at Seward County CC 8 p.m. Swimming vs Oklahoma Christian University & University of St. Mary TBA
<b>20</b>	<b>21</b>	<b>22</b>	<b>23</b>	<b>24</b>	<b>25</b>	<b>26</b>
BARTonline Spring Session 2 (16 weeks) Last Day to Drop with 100% Refund	Bingo 6 p.m., Union	Kansas Day, Learning Resource Center - Library	Wrestling at Colby CC TBA Women's Basketball vs Hutchinson CC 5:30 p.m. Men's Basketball vs Hutchinson CC 7:30 p.m.	Free Shoulder Massages 6-9 p.m., Union – Game Room		
<b>27</b>	<b>28</b>	<b>29</b>	<b>30</b>	<b>31</b>		

CollegeNEWS | news.bartoncc.edu

WHAT DRIVES YOU?



# Cat Naps Rock!

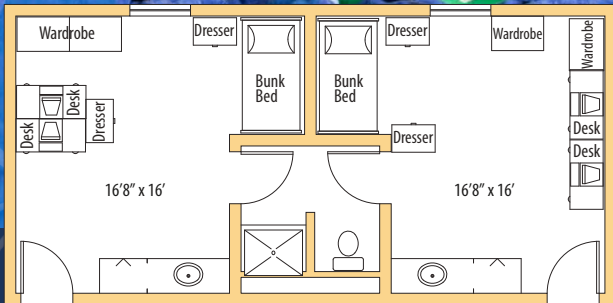

Bluestem Hall: Twin suite, double occupancy - Handicap accessible rooms available

## FEATURES

- \* Wireless Internet
- \* Three FREE Laundromats
- \* 19 meals per week
- \* Single room options
- \* FREE cable
- \* 12 newly released movies each month
- \* FREE parking
- \* Vending machines
- \* Room furniture includes a desk, wardrobe and twin bed
- \* Community room with TV and game consoles
- \* ADA compliant rooms
- \* Community kitchen facilities
- \* Designated storm shelter areas
- \* 24-hour security and camera surveillance
- \* Purified water stations

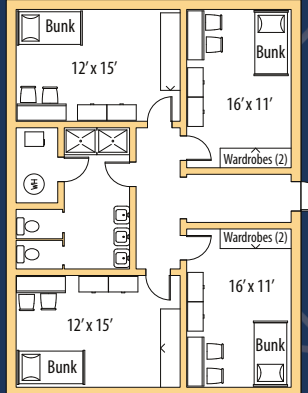

Meadowlark Halls:  
There will be some variation between units  
"Community Style" (6-7 people per unit)

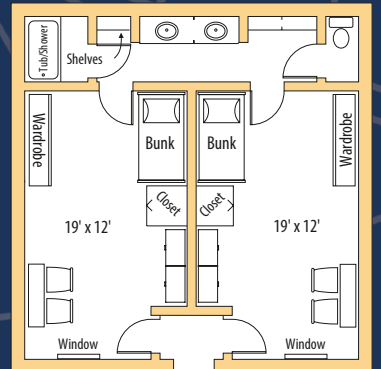

Sunflower Halls:  
Two rooms, double occupancy  
"Apartment Style" (2 people per room)

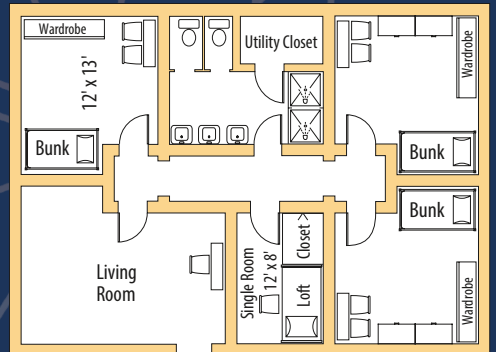

Bison Halls:  
There will be some variation between units  
"Community Style" (6-7 people per unit)

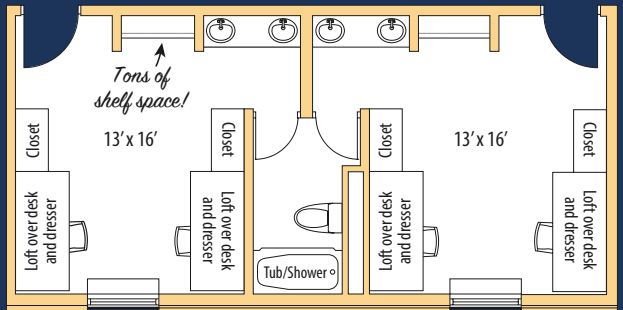

Cottonwood Hall: Handicap accessible rooms available  
"Traditional Style" (2 people per room)

# FEBRUARY 2019

JANUARY 2019						
S	M	T	W	T	F	S
			1	2	3	4
6	7	8	9	10	11	12
13	14	15	16	17	18	19
20	21	22	23	24	25	26
27	28	29	30	31		

MARCH 2019						
S	M	T	W	T	F	S
						1
						2
3	4	5	6	7	8	9
10	11	12	13	14	15	16
17	18	19	20	21	22	23
24	25	26	27	28	29	30
						31

## SUNDAY

## MONDAY

## TUESDAY

## WEDNESDAY

## THURSDAY

## FRIDAY

## SATURDAY

Wrestling Conference Dual Championships at Pratt, KS TBA  
Super Bowl Party 5:30 p.m., Union

# 3

BARTonline Spring Session 3 (6 weeks) Last Day to Add  
Irena Ravinskaya "Steinway Concert," 2 p.m., Morrison Chapel

# 10

BARTonline Spring Session 3 (6 weeks) Last Day to Drop with a Grade of W

# 17

Baseball vs Western Nebraska CC 1 p.m.

# 24

# 4

BARTonline Spring Session 3 (6 weeks) Classes Begin  
Women's Basketball at Colby CC 5:30 p.m.  
Men's Basketball at Colby CC 7:30 p.m.

# 11

\$4 Movie Night, Golden Belt Cinema

# 18

Softball at Sterling College JV TBA

# 25

# 5

Softball vs Bethany College JV 1 p.m.

# 12

Softball at Northern Oklahoma-Tonkawa TBA

# 19

# 26

# 6

Women's Basketball at Pratt CC 6 p.m.  
Men's Basketball at Pratt CC 8 p.m.  
\$4 Movie Night, Golden Belt Cinema 6

### Junior Day

Last Day to Drop Courses Recorded as W on Transcript for 1st 8-week Session  
Women's Basketball vs Northwest Kansas Technical College 5:30 p.m.  
Men's Basketball vs Northwest Kansas Technical College 7:30 p.m.

# 13

Baseball vs McCook CC 2 p.m.  
Women's Basketball at Hutchinson CC 5:30 p.m.  
Men's Basketball at Hutchinson CC 7:30 p.m.  
Free Bowling 7:30-9 p.m., Walnut Bowl

# 20

Career Fair

# 27

# 7

Valentine's Day  
Valentine Give Away 11-12:30 p.m., Union

# 14

# 21

Baseball at Dodge City CC 1 p.m.  
Softball vs Northern Oklahoma-Tonkawa TBA  
Women's Basketball Region VI Division I First Round TBA  
Men's Basketball Region VI Division I First Round TBA  
Bingo 6 p.m., Union

# 28

Priority Deadline to Apply for Spring 2019 Graduation

# 1

Baseball at Carl Albert State College 12 p.m.  
Softball Cisco College Tournament TBA

# 8

Baseball vs Clarendon College at Oklahoma City, OK 1 p.m.  
Baseball vs Seminole State College at Edmond, OK 6:30 p.m.  
Softball at North Arkansas College TBA

# 15

# 22

# 2

Wrestling Conference Dual Championships at Pratt, KS TBA  
Women's Basketball vs Garden City CC 5:30 p.m.  
Men's Basketball vs Garden City CC 7:30 p.m.  
Swimming Iowa Lakes Virtual Meet at Great Bend, KS TBA

Baseball at Carl Albert State College 12 p.m.  
Women's Basketball vs Dodge City CC 5:30 p.m.  
Men's Basketball vs Dodge City CC 7:30 p.m.  
Softball Cisco College Tournament TBA

# 9

Baseball vs Indian Hills CC at Oklahoma City, OK 10 a.m.  
Softball at North Arkansas College TBA  
Women's Basketball vs Seward County CC 5:30 p.m.  
Wrestling NJCAA West/Central District Championships at Parsons, KS TBA  
Men's Basketball vs Seward County CC 7:30 p.m.  
BaRTaRT: BCC Student/Faculty Exhibit Ends, Shafer Gallery

Baseball vs Western Nebraska CC 1 p.m.  
Women's Basketball at Garden City CC 2 p.m.  
Men's Basketball at Garden City CC 4 p.m.

# 23

WHAT DRIVES YOU?

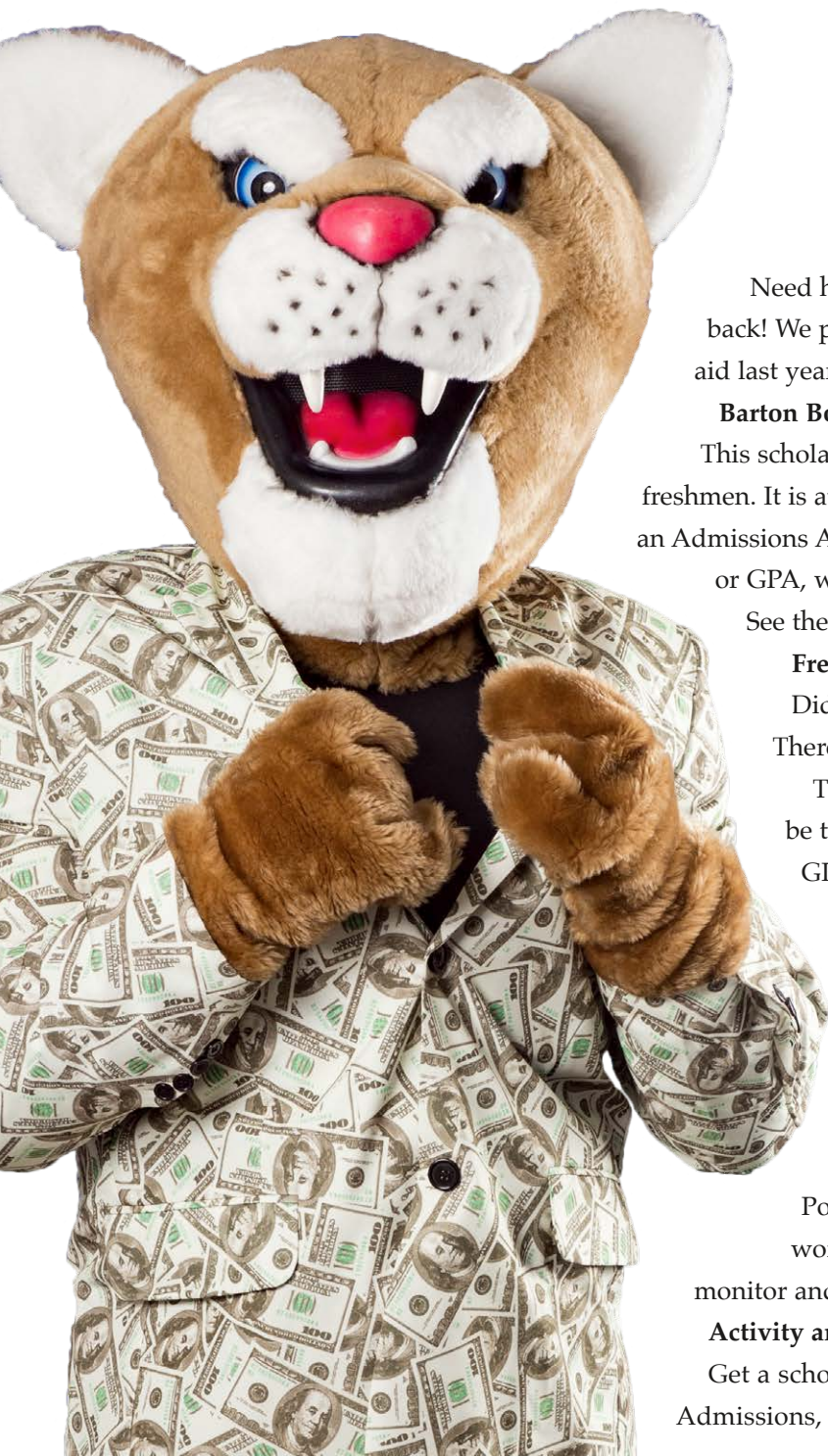

# Make Your Dreams Pawsible

Need help paying for college? We've got your back! We paid out more than \$8 million in financial aid last year!

## **Barton Bound Scholarships**

This scholarship is geared toward incoming freshmen. It is automatically applied upon completion of an Admissions Application and is based on ACT scores or GPA, whichever yields a higher reward amount. See the chart for the various levels.

## **Fresh Start Scholarship**

Did you take a year off after high school? There's a scholarship just for you!

The Barton Fresh Start Scholarship would be targeted to students with a high school GPA of 3.0 or above, who had not attended college after graduating from high school, or went to another college and are transferring to Barton to complete their degree.

## **Campus Employment**

Get an on-campus job that aligns with your career and education goals! Positions include photographer, office worker, bookstore employee, art gallery attendant, lifeguard, maintenance worker, computer lab monitor and more!

## **Activity and Departmental Scholarships**

Get a scholarship for your skills or hobbies! Areas offering Activity and Departmental awards include: Admissions, Agriculture, Art, Automotive, Band, Business, Cheer, Criminal Justice, Drama, Early

## 2018-2019 COST INFORMATION

- Fill out the free application for Federal Student Aid at [fafsa.ed.gov](http://fafsa.ed.gov) (Barton's Code: 004608)
- Payment options also available

### Legal Residence in-state and out-of-state\*

Cost per credit hour	\$112
----------------------	-------

\*Subject to change by the State of Kansas

### Online Costs

BARTonline	\$150 per semester credit hour
EduKan	\$150 per semester credit hour

### Annual Cost Estimates

Tuition	\$3,584	*based on 16 credit hours per semester x 2 semesters
Books	\$ 830	(estimated)
Housing	\$5,793	(19 meals per week)
TOTAL COST**	\$10,207	

The Barton Board of Trustees has the right to change tuition without notice. \*A scholarship of \$7 per credit hour applies to Barton County residents. \*\*Cost is estimated based on basic charges and do not include other personal costs or costs associated with various classes nor cost of online courses.



Childhood, Engineering, EMS, HALO, Medical Assistant, MLT, Music, Natural Gas, Nursing, Networking and Student Senate.

### Foundation Scholarships

Thanks to the generosity of many donors, endowments and annually funded scholarships with a wide variety of criteria are available to assist students.

Scholarship application priority deadline is June 1 prior to the academic year. The application can be found at [bartonccfoundation.org](http://bartonccfoundation.org).

## BARTON BOUND SCHOLARSHIPS

The Barton Bound Scholarship would be targeted to students graduating from high school in May (for fall awarding) and December (for spring awarding). The award would be automatic upon completion of an Admissions Application and based upon either their high school GPA or ACT score whichever would provide the higher award. The scholarship would be automatically renewed annually based upon the spring Barton GPA. The student must be enrolled full-time (12+ hours). The student does not have to be seeking a degree or certificate at Barton but must be a Kansas resident. As with all other Barton tuition scholarships, for online classes the tuition amount covered is equal to the same amount as that for face to face classes.

For more information, visit [financialaid.bartonccc.edu](http://financialaid.bartonccc.edu)

AWARD	AWARD AMOUNT	KANSAS HS GPA	OR	ACT SCORE
Elite Award	Tuition & Books	3.5 and above	or	26+
Excellence Award	\$1,000	3.0 - 3.49	or	24 - 25
Honor Award	\$800	2.5 - 2.99	or	22 - 23
Achievement Award	\$500	2.0 - 2.49	or	20 - 21

Fur more information,  
visit [financialaid.bartonccc.edu](http://financialaid.bartonccc.edu)

**Live Every Day Like  
it's Saturday**

**Happy Spring  
Break!**





# MARCH 2019

FEBRUARY 2019						
S	M	T	W	T	F	S
					1	2
3	4	5	6	7	8	9
10	11	12	13	14	15	16
17	18	19	20	21	22	23
24	25	26	27	28		

APRIL 2019						
S	M	T	W	T	F	S
	1	2	3	4	5	6
7	8	9	10	11	12	13
14	15	16	17	18	19	20
21	22	23	24	25	26	27
28	29	30				

## SUNDAY MONDAY TUESDAY WEDNESDAY THURSDAY FRIDAY SATURDAY

3

BARTonline Spring Session 1 (8 weeks) Last Day to Drop with a Grade of W  
Barton Theatre Production, "Rumors," Fine Arts Auditorium 2 p.m.  
Women's Basketball Region VI Division I Playoffs at Wichita, KS TBA  
Men's Basketball Region VI Division I Playoffs at Wichita, KS TBA

10

BARTonline Spring Session 3 (6 weeks) Last Day to Drop with a Grade of W  
BARTonline Spring Session 4 (8 weeks) Last Day to Add

24

31

BARTonline Spring Session 5 (6 weeks) Last Day to Add  
Community Choir Dress Rehearsal 7:30 p.m.

4

Classes Begin – 2nd 8-week Session  
Baseball at McPherson College JV 4 p.m.  
Women's Basketball Region VI Division I Playoffs at Wichita, KS TBA  
Men's Basketball Region VI Division I Playoffs at Wichita, KS TBA

11

BARTonline Spring Session 4 (8 weeks) Classes Begin  
\$4 Movie Night, Golden Belt Cinema 6

25

Softball vs Sterling College JV 2 p.m.  
Bingo 6 p.m., Union

5

Barton Music Department hosts Central Prairie League Music Festival  
Women's Basketball Region VI Division I Playoffs at Wichita, KS TBA  
Men's Basketball Region VI Division I Playoffs at Wichita, KS TBA

12

Baseball vs Tabor College TBA  
Women's Basketball NJCAA Division I National Championship TBA  
Men's Basketball NJCAA Division I National Championship at Hutchinson, KS TBA

26

Original Play Auditions 5-6:30 p.m., Fine Arts Auditorium

6

Women's Basketball Region VI Division I Playoffs at Wichita, KS TBA  
Men's Basketball Region VI Division I Playoffs at Wichita, KS TBA  
Swimming NJCAA Swimming & Diving Championships at Buffalo, NY TBA  
Softball vs Hutchinson CCTBA

13

Softball at Colby CCTBA

27

Softball vs Pratt CCTBA  
Original Play Auditions 5-6:30 p.m., Fine Arts Auditorium  
Free Bowling 7:30-9 p.m., Walnut Bowl

7

Pi Day, Learning Resource Center – Library  
Baseball vs Garden City CC 1 p.m.  
Swimming NJCAA Swimming & Diving Championships at Buffalo, NY TBA  
\$4 Movie Night, Golden Belt Cinema 6

14

Baseball vs Pratt CC 1 p.m.  
Free Shoulder Massages 6-9 p.m., Union – Game Room

28

Baseball at Seward County CC 1 p.m.

8

Last Day for Refund – 2nd 8-week Session  
Swimming NJCAA Swimming & Diving Championships at Buffalo, NY TBA

15

22

29

9

Baseball at Garden City CC 1 p.m.  
Swimming NJCAA Swimming & Diving Championships at Buffalo, NY TBA

16

23

30

Dance Theatre Audition for Fall 2019 10-11:15 a.m., Studio 34  
Baseball vs Seward County CC 1 p.m.  
Softball vs Dodge City CCTBA

CollegeNEWS | news.bartonccc.edu

WHAT DRIVES YOU?

# Kitten Involved on Campus

Have fun!

Enhance your college experience!

Meet new people!

Get involved!

## STUDENT ACTIVITIES & ORGANIZATIONS

Alpha Sigma Lambda

Campus Christian Fellowship

Cheer Squad

Collegiate Farm Bureau

Collegiate Music Educators National Conference

Community Student Organization

Computer Club

Concert Band

Concert Choir

Contagious

Cougar Dance Team

Da Capo

Dante Deo

Dolce

Gay Straight Alliance Club

Hilltop Singers

Hispanic American Leadership Organization (HALO)

Jazz Band

Journalism Crew

Lambda Alpha Epsilon

Latter Day Saints Student Association

Multicultural Society

National Association for Music Education

National Honor Societies

Nursing Club

Orchestra

Pep Band

Phi Theta Kappa

Pom Squad

Spark

Stage Band

St. Justa Pottery Guild

Student Ambassadors

Student Government Association

Theatre

Young Democrats



# APRIL 2019

MARCH 2019						
S	M	T	W	T	F	S
					1	2
3	4	5	6	7	8	9
10	11	12	13	14	15	16
17	18	19	20	21	22	23
24	25	26	27	28	29	30
31						

MAY 2019						
S	M	T	W	T	F	S
					1	2
3	4	5	6	7	8	9
10	11	12	13	14	15	16
17	18	19	20	21	22	23
24	25	26	27	28	29	30
31						

## SUNDAY

## MONDAY

## TUESDAY

## WEDNESDAY

## THURSDAY

## FRIDAY

## SATURDAY

BARTonline Spring Session 5 (6 weeks)  
Classes Begin  
Baseball vs Mcpherson College JV 2 p.m.  
Community Concert Choir 7:30 p.m.

**1**

**2**

Softball vs Independence CCTBA  
Ice Cream Social 7:30-8:30 p.m., Union

**3**

Last Day to Drop Courses Recorded as W on Transcript for Full Term Session  
Baseball vs Colby CC 1 p.m.  
Student Recital 4 p.m., Morrison Chapel

**4**

Softball at Garden City CCTBA

**5**

KSHSAA Regional Music Contest at Barton  
Baseball at Colby CC 1 p.m.  
Softball at Seward County CCTBA

**6**

BARTonline Spring Session 5 (6 weeks)  
Last Day to Drop with 100% Refund

**7**

**8**

Summer and Fall 2019 Registration Begins (Current Students)  
Barton County Campus No Day Classes  
Hispanic Culture Day  
Jazz Band/Hilltop Singers Tour

**9**

Summer and Fall 2019 Registration Begins (New Students)  
Softball at Hutchinson CCTBA  
\$4 Movie Night, Golden Belt Cinema 6

**10**

Baseball at Cloud County CC 1 p.m.  
Barton Orchestra Concert 7:30 p.m., Shafer Gallery

**11**

Hilltop Singers Tour

**12**

Hilltop Singers Tour  
Baseball vs Cloud County CC 1 p.m.  
Softball vs Butler CC TBA

**13**

BARTonline Spring Intersession (4 weeks)  
Last Day to Add  
Hilltop Singers Tour

**14**

BARTonline Spring Intersession (4 weeks)  
Classes Begin  
Hilltop Singers Tour

**15**

Enrollment Day 1 p.m. & 6 p.m.  
Baseball at Pratt CC 4 p.m.  
Softball at Bethany College JV 5 p.m.  
Hawaiian Night 5 p.m./Entertainment TBA 8 p.m., Union

**16**

Enrollment Day 9 a.m. & 1 p.m.  
Softball at Pratt CCTBA  
Free Bowling 7:30-9 p.m., Walnut Bowl

**17**

18th & Vine Jazz Festival at Kansas City  
Baseball vs Butler CC 1 p.m.  
Art and Science Encounters: Karel Van Kempen Exhibit Ends, Shafer Gallery

**18**

Good Friday (Campus Closed)

**19**

Baseball at Butler CC 1 p.m.

**20**

BARTonline Spring Intersession (4 weeks)  
Last Day to Drop with 100% Refund

**21**

Easter Monday (Campus Closed)

**22**

Enrollment Day 1 p.m. & 6 p.m.  
Baseball at Hutchinson CC 5 p.m.

**23**

Last Day to Drop Courses Recorded as W on Transcript for 2nd 8-week Session  
Enrollment Day 9 a.m. & 1 p.m.

**24**

Barton Theatre Original Plays Series TBA, Fine Arts Auditorium 7:30 p.m.  
Student Recital 4 p.m., Morrison Chapel  
Baseball at Hesston College 5 p.m.  
One Act Plays 7:30 p.m., Fine Arts Auditorium  
\$4 Movie Night, Golden Belt Cinema 6

**25**

**26**

Baseball vs Hesston College 2 p.m.

**27**

Library Spring Finals Extended Hours

**28**

Library Spring Finals Extended Hours  
Vortex: High School Art Exhibit Begins, Shafer Gallery  
Skating & Laser Tag 7-9 p.m., Up & Rolling Skate Center

**29**

Library Spring Finals Extended Hours  
Dance Theatre Spring Concert 7:30 p.m., Fine Arts Auditorium

**30**

# Cathletics

Striving for  
purrfection

## MEN'S SPORTS

Baseball  
Basketball  
Cross Country  
Golf  
Soccer  
Swimming  
Tennis  
Track  
Wrestling

## WOMEN'S SPORTS

Basketball  
Cross Country  
Golf  
Soccer  
Softball  
Swimming  
Tennis  
Track  
Volleyball

[BartonSports.com](http://BartonSports.com)

HOME TO 56  
NATIONAL  
CHAMPIONSHIPS!



# MAY 2019

APRIL 2019						
S	M	T	W	T	F	S
	1	2	3	4	5	6
7	8	9	10	11	12	13
14	15	16	17	18	19	20
21	22	23	24	25	26	27
28	29	30				

JUNE 2019						
S	M	T	W	T	F	S
						1
2	3	4	5	6	7	8
9	10	11	12	13	14	15
16	17	18	19	20	21	22
23	24	25	26	27	28	29
30						

SUNDAY	MONDAY	TUESDAY	WEDNESDAY	THURSDAY	FRIDAY	SATURDAY
			Library Spring Finals Extended Hours Enrollment Day 1 p.m.	Library Spring Finals Extended Hours Music Endowment Concert 7:30 p.m., Fine Arts Auditorium	Softball Region VI Division I Tournament at Dodge City, KS TBA	Vortex: High School Art Exhibit Ends, Shafer Gallery Softball Region VI Division I Tournament at Dodge City, KS TBA
			<b>1</b>	<b>2</b>	<b>3</b>	<b>4</b>
BARTonline Spring Session 2 (16 weeks) Last Day to Drop with a Grade of W BARTonline Spring Session 4 (8 weeks) Last Day to Drop with a Grade of W BARTonline Spring Session 5 (6 weeks) Last Day to Drop with a Grade of W BARTonline Spring Intersession (4 weeks) Last Day to Drop with a Grade of W Softball Region VI Division I Tournament at Dodge City, KS TBA	First Day of Finals Late Night Breakfast 8-9 p.m./Photobooth 8-10 p.m., Union	Finals	Finals	Last Day of Finals Last Day – Full Term and 2nd 8-week Sessions \$4 Movie Night, Gold Belt Cinema 6 Steve Dudek Retrospective Exhibit Begins, Shafer Gallery	Commencement	
	<b>6</b>	<b>7</b>	<b>8</b>	<b>9</b>	<b>10</b>	<b>11</b>
BARTonline Spring Session 2 (16 weeks) Ends BARTonline Spring Session 4 (8 weeks) Ends BARTonline Spring Session 5 (6 weeks) Ends BARTonline Spring Intersession (4 weeks) Ends	Dance Theatre Audition for Spring 2019 6-7:15 p.m., Studio 34		Enrollment Day 1 p.m.		Summer Hours (Campus Closed)	
<b>12</b>	<b>13</b>	<b>14</b>	<b>15</b>	<b>16</b>	<b>17</b>	<b>18</b>
			Enrollment Day 1 p.m. Softball NJCAA Division I Championship at St. George, UT TBA	Summer 2019 Registration Ends Softball NJCAA Division I Championship at St. George, UT TBA	Summer Hours (Campus Closed) Softball NJCAA Division I Championship at St. George, UT TBA	Softball NJCAA Division I Championship at St. George, UT TBA
<b>19</b>	<b>20</b>	<b>21</b>	<b>22</b>	<b>23</b>	<b>24</b>	<b>25</b>
	Memorial Day (Campus Closed)		Enrollment Day 1 p.m.		Summer Hours (Campus Closed)	
<b>26</b>	<b>27</b>	<b>28</b>	<b>29</b>	<b>30</b>	<b>31</b>	

CollegeNEWS | news.bartoncccd.edu

WHAT DRIVES YOU?

# Keeping a Pawsitive Catitude

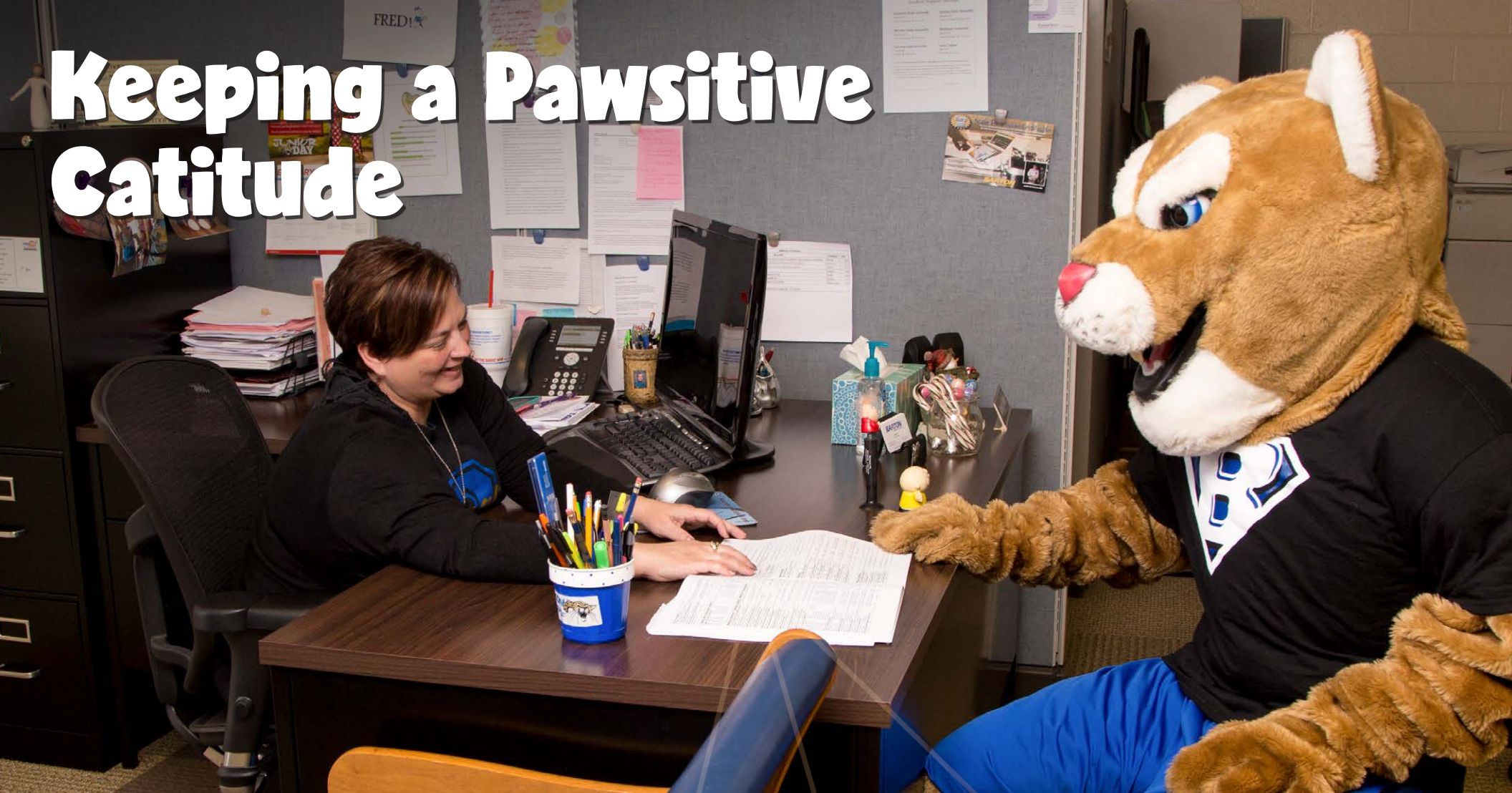

**Achieve  
Greatness  
(WE'LL HELP!)**

**Academic Advising**

**Campus Security**

24-hour security officers support a safe campus

**TRiO**

FREE services for eligible students

**Tutoring**

FREE peer and professional tutoring

**Counseling Services**

Professional and personal counseling

**Health Services**

FREE basic services

**Career Center**

Student Employment Opportunities

# JUNE 2019

MAY 2019						
S	M	T	W	T	F	S
			1	2	3	4
5	6	7	8	9	10	11
12	13	14	15	16	17	18
19	20	21	22	23	24	25
26	27	28	29	30	31	

JULY 2019						
S	M	T	W	T	F	S
	1	2	3	4	5	6
7	8	9	10	11	12	13
14	15	16	17	18	19	20
21	22	23	24	25	26	27
28	29	30	31			

SUNDAY	MONDAY	TUESDAY	WEDNESDAY	THURSDAY	FRIDAY	SATURDAY
						Term Begins Priority Deadline to Apply for Summer 2019 Graduation
						<b>1</b>
	Summer 2019 Classes Begin – Full Term and 1st 4-week Session		Last Day for Late Enrollment for Full Term and 1st 4-week Session Last Day for Refund – Full Term and 1st 4-week Session Enrollment Day 1 p.m.		Summer Hours (Campus Closed)	
<b>2</b>	<b>3</b>	<b>4</b>	<b>5</b>	<b>6</b>	<b>7</b>	<b>8</b>
			Enrollment Day 1 p.m.		Summer Hours (Campus Closed)	
<b>9</b>	<b>10</b>	<b>11</b>	<b>12</b>	<b>13</b>	<b>14</b>	<b>15</b>
			Enrollment Day 1 p.m.	Last Day to Drop Courses Recorded as W on Transcript for 1st 4-week Session	Summer Hours (Campus Closed)	Steve Dudek Retrospective Exhibit Ends, Shafer Gallery
<b>16</b>	<b>17</b>	<b>18</b>	<b>19</b>	<b>20</b>	<b>21</b>	<b>22</b>
<b>23</b>				Last Day – 1st 4-week Session	Summer Hours (Campus Closed)	
<b>30</b>	<b>24</b>	<b>25</b>	<b>26</b>	<b>27</b>	<b>28</b>	<b>29</b>



JIMMY LAWSON - DANNY BIGGS FIELD

	BALL	STRIKE	OUT														
AT BAT				1	2	3	4	5	6	7	8	9	10	R	H	E	
VISITOR																	
HOME																	

385

**Love Barton**  
**Love Meowica**



# JULY 2019

JUNE 2019						
S	M	T	W	T	F	S
						1
2	3	4	5	6	7	8
9	10	11	12	13	14	15
16	17	18	19	20	21	22
23	24	25	26	27	28	29
30						

AUGUST 2019						
S	M	T	W	T	F	S
						1
						2
3	4	5	6	7	8	9
10	11	12	13	14	15	16
17	18	19	20	21	22	23
24	25	26	27	28	29	30
31						

SUNDAY	MONDAY	TUESDAY	WEDNESDAY	THURSDAY	FRIDAY	SATURDAY
	Summer 2019 Classes Begin – 2nd 4-week Session		Last Day for Late Enrollment for 2nd 4-week Session Last Day for Refund – 2nd 4-week Session	Independence Day (Campus Closed)	Summer Hours (Campus Closed)	
	1	2	3	4	5	6
7	8	9	Enrollment Day 1 p.m. 10	Last Day to Drop Courses Recorded as W on Transcript for Full Term Session 11	Summer Hours (Campus Closed) 12	13
14	15	16	Enrollment Day 1 p.m. 17	18	Summer Hours (Campus Closed) 19	20
21	Last Day to Drop Courses Recorded as W on Transcript for 2nd 4-week Session 22	23	Enrollment Day 1 p.m. 24	25	Summer Hours (Campus Closed) 26	27
28	Last Day – Full Term 2nd 4-week Sessions 29	30	Term Ends 31			

CollegeNEWS | news.bartonccc.edu

WHAT DRIVES YOU?

# Programs of Study

## Transfer Programs

Transfer programs are designed to prepare you for transferring to a four-year college or university.

## Career Programs

Career programs offer you an opportunity to pursue certificate and degree programs designed to prepare you for employment in the workplace and/or transfer to a university.

## Location

Campus locations where program may be completed

BC = Barton County

FL = Ft. Leavenworth

FR = Ft. Riley

GV = Grandview Plaza

Outreach sites may be available

### AGRICULTURE

Agribusiness (AS)  
Agricultural Economics (AS)  
Agricultural Education (AS)  
Agriculture Business Mgmt (AAS)  
Agriculture Communications (AS)  
Agriculture Transfer Option (AS)  
Agronomy (AS)  
Animal Science (AS)  
Beef Cattle Production (CERT1, CERT2)  
Crop Protection (CERT1, CERT2, AAS)  
Food Science (AS)  
Forestry (AS)  
Golf Course Management (AS)  
Horticulture/Turf Management (AS)  
Milling Science (AS)  
Park Mgmt & Conservation (AS)  
Scale Technician (CERT1)

### AUTOMOTIVE TECHNOLOGY

Automotive Technology (CERT1, CERT2, CERT3, AAS)

### BUSINESS/ECONOMICS

Accounting (AS, ONLINE)  
Agribusiness (AS)  
Agricultural Economics (AS)

Agriculture Business Mgmt (AAS)  
Bus Management & Leadership (CERT1, AAS, ONLINE)  
Business (AS, ONLINE)  
Business Admin Technology (AAS, ONLINE)  
Economics (AS, ONLINE)  
Finance (AS, ONLINE)  
Golf Course Management (AS)  
Management (AS, ONLINE)  
Marketing (AS, ONLINE)  
Park Mgmt & Conservation (AS)  
Public Administration (AS)  
Tech Accounting Specialist (AAS, ONLINE)

### COMMUNICATION

English (AA, ONLINE)  
Journalism (AA)  
Modern Languages (AA)  
Speech Communications (AA)

### COMPUTER/INFORMATION TECHNOLOGY

Computer Information Systems (AS)  
Computer Science (AS)  
Networking Specialist (CERT2, AAS, ONLINE)

### EARLY CHILDHOOD

Child Development (CERT1, ONLINE)  
Early Childhood (AAS, ONLINE)  
Early Childhood Education (AS, ONLINE)

### EDUCATION

Art Education (AA)  
Early Childhood Education (AS, ONLINE)  
Elementary Education (AS)  
Math Education (AS, ONLINE)  
Music Education (AA)  
Physical Education (AS)  
Secondary Education (AA, AS, ONLINE)  
Special Education (AS)

### FINE AND PERFORMING ARTS

Art (AA)  
Art Education (AA)  
Dance (AA)  
Graphic Design (AA)  
Music (AA)  
Music Education (AA)  
Photography (AA)  
Theatre (AA)

### GENERAL STUDIES

General Studies (AGS, ONLINE)

### HEALTH PROFESSIONS

Adv Emergency Med Tech AEMT (SAPP++)  
Certified Medication Aide (SAPP++)  
Certified Nurse Aide (SAPP++)  
Dietary Management (AS, ONLINE)  
Dietary Manager (CERT1, ONLINE)  
Dietetics (AS, ONLINE)  
Emergency Medical Responder (SAPP++)  
EMS Instructor Coordinator (SAPP++)  
EMT (SAPP+)  
Medical Admin Technology (AAS, ONLINE)  
Medical Assistant (CERT2, AAS)  
Medical Coding (CERT2, ONLINE)  
Medical Lab Technician (AAS, ONLINE)  
Mental Health Technician (CERT3)  
Nursing - PN (CERT3)  
Nursing - Transfer (AS)  
Nutrition and Health (AS, ONLINE)  
Paramedic (CERT3, AAS)  
Pharmacy (AS, ONLINE)  
Pharmacy Technician (CERT1, ONLINE)  
Phlebotomy Training (SAPP+)  
Physical Therapy (AS, ONLINE)  
Registered Nursing (AAS)

### HEALTH, PHYSICAL EDUCATION, RECREATION

Athletic Training (AS)  
Exercise Science (AS)  
Physical Education (AS)  
Sports Management (AS)

### HUMANITIES AND SOCIAL SCIENCES

Anthropology Cultural Studies (AA, ONLINE)  
History (AA, ONLINE)  
Philosophy (AA)  
Political Science (AA, ONLINE)  
Psychology (AS, ONLINE)  
Religion (AA)  
Sociology (AA, ONLINE)

### INDUSTRIAL/ENERGY TECHNOLOGY

Gas Measurement (CERT2++)  
Natural Gas Trans/Distrib Tech (CERT2, AAS)  
Scale Technician (CERT1)  
Welding Technology (CERT1)

### LIBERAL STUDIES

Liberal Studies (AA, AS, ONLINE)

### MILITARY STUDIES/LEADERSHIP

Military Leadership (CERT2++)  
Military Logistics (CERT2++)  
Military Dangerous Materials Handling (CERT2++)  
Technical Studies (AAS++)

### PRE-PROFESSIONAL

Architectural Engineering (AS)  
Architecture (AS)  
Chiropractic (AS, ONLINE)  
Dental Hygiene (AS)  
Dentistry (AS, ONLINE)  
Engineering Tech (AS)  
Health Information Mgmt (AS, ONLINE)  
Law (AA, ONLINE)  
Medicine (AS, ONLINE)  
Mortuary Science (AS)  
Occupational Therapy (AS)  
Optometry (AS)  
Pharmacy (AS, ONLINE)  
Physical Therapy (AS, ONLINE)  
Physical Therapy Assistant (AS)  
Physicians Assistant (AS, ONLINE)  
Radiology Technology (AS, ONLINE)  
Respiratory Therapy (AS)  
Social Work (AA)  
Veterinary Medicine (AS, ONLINE)

### PUBLIC SAFETY, CORRECTIONS & SECURITY

Adv Emergency Med Tech AEMT (SAPP++)  
Corrections (CERT1, AAS, ONLINE)  
Criminal Justice (AA, CERT3, AAS)  
Emerg Mgmt/Homeland Security (CERT2, AAS, ONLINE)  
EMT (SAPP+)  
Hazardous Materials Mgmt (CERT2, AAS, ONLINE)  
Occupational Safety & Health (CERT1, AAS, SAPP, ONLINE)  
Paramedic (CERT3, AAS)

### SCIENCE AND MATH

Biology (AS, ONLINE)  
Chemistry (AS, ONLINE)  
Engineering (AS)  
Geology (AS)  
Mathematics (AS, ONLINE)  
Physical Sciences (AS, ONLINE)  
Physics (AS)  
Wildlife Science (AS, ONLINE)

# Come Visit Us!

Tours are scheduled Monday through Friday, 8:30 a.m. - 3 p.m. Tour times fill quickly, so don't delay!

Give us at least a week's notice, and we'll get your visit scheduled to fit YOUR needs!

Call (800) 722-6842 to schedule a tour today! [bartonccc.edu/admissions](http://bartonccc.edu/admissions)

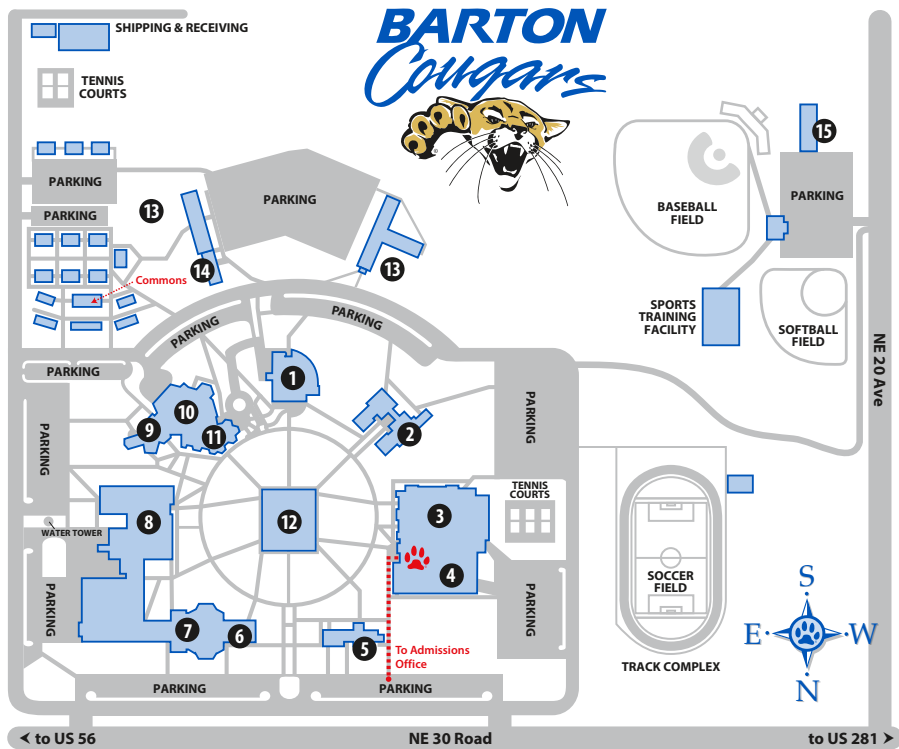

- |                                   |  |
|-----------------------------------|--|
| ① U-Building, Union               | ⑨ F-30, Seminar Room                       |
| ② C-Building, Classroom           | ⑩ F-Building, Fine Arts                    |
| ③ P-Building, Physical Education  | ⑪ Shafer Gallery                           |
| ④ Kirkman Student Activity Center | ⑫ L-Building, Learning Resources Center    |
| ⑤ A-Building, Administration      | ⑬ Student Housing                          |
| ⑥ Planetarium                     | ⑭ Child Development Center                 |
| ⑦ S-Building, Science & Math      | ⑮ Midwest Utility Pipeline Training Center |
| ⑧ T-Building, Technical Education |  |

*The Mission of Barton Community College is to provide quality educational opportunities that are accessible, affordable, continuously improving and student focused. Barton is driven to provide an educational system that is learning-centered, innovative, meets workforce needs, and strengthens communities.*

# BARTON

## COMMUNITY COLLEGE

245 NE 30 RD • Great Bend, KS 67530  
(800) 722-6842 • GoBarton.com

# About our campuses

## GREAT BEND CAMPUS

[bartonccc.edu](http://bartonccc.edu)

Barton's main campus is located high atop a hill on 160 acres three miles northeast of Great Bend. The main campus includes eight primary buildings, four phases of student housing, the Cougar fields, and the Midwest Utility Pipeline Training Center.

## FORT RILEY CAMPUS

[fr.bartonccc.edu](http://fr.bartonccc.edu)

Barton's proud association with Fort Riley and the U.S. Army began in 1984 with a single training contract. The Fort Riley campus administration building is located in Building 211 on the main post of Fort Riley. The campus also provides instructional services for Troop School, BSEP and LSEC, which are located on Custer Hill.

In addition, BARTonline, Barton's premier site for online courses, is administered from the Fort Riley campus.

Courses also are offered at a nearby outreach site located at Grandview Plaza, which is home to the Hazardous

Materials Handling and Emergency Management, Emergency Medical Technician, and Paramedic programs.

## FORT LEAVENWORTH CAMPUS





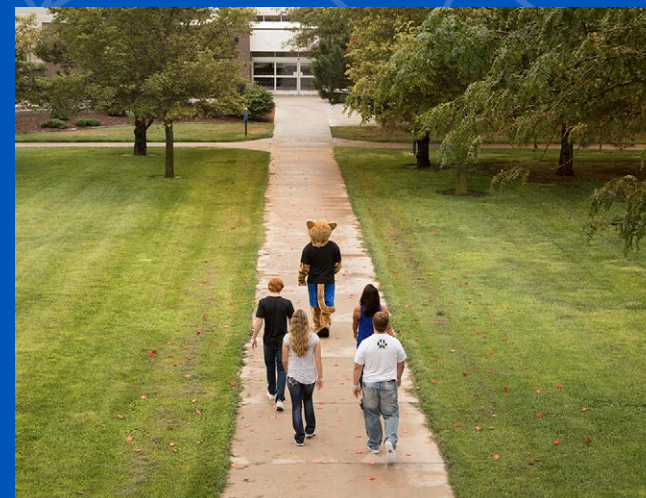

[fl.bartonccc.edu](http://fl.bartonccc.edu)

Barton opened a campus on Fort Leavenworth in 2012. With nearly three decades of experience operating a military-based campus at Fort Riley, Barton was well-equipped to hit the ground running. The Fort Leavenworth campus office is located in the basement of the Army Education



Center at 120 Dickman Ave. Fort Leavenworth, KS 66027. The campus also provides instructional services for BSEP and LSEC and a criminal justice program.

# Cougar Checklist

-  **Campus Tour** | A great way to see if Barton is the place for you!
-  **Admissions/Scholarship Application** | Application available online.
-  **Submit ACT Scores or other test scores** | Haven't taken any assessment tests? No problem! Just give us a call and we'll get you taken care of.
-  **Submit completed transcript** | Completed high school transcript must be mailed directly to Barton Community College to be official. Unofficial transcripts can be used for advising and obtaining academic information (GPA, ACT Scores, etc.)
-  **Housing Application** | Submit application and deposit early to get your first choice! Application available online.
-  **Financial Aid** | Cost should not be a reason to rule out college! Visit [fafsa.ed.gov](http://fafsa.ed.gov) for federal assistance or call us for even more options!



## Want to get started?

For more information, call the Admissions Office at (800) 722-6842 or (620) 792-9286

# Directory Information

GOBARTON.COM

### BARTON COUNTY CAMPUS

Local: (620) 792-2701  
Toll-Free: (800) 748-7594  
Address:  
245 NE 30 RD  
Great Bend, KS 67530

### FORT RILEY CAMPUS

Local: (785) 784-6606  
Toll-Free: (877) 620-6606  
Address:  
Bldg. 211 Custer Ave., P.O. Box 2463  
Fort Riley, KS 66442  
FR.bartonccc.edu

### FORT LEAVENWORTH CAMPUS

Local: (913) 684-9384  
Toll-Free: (855) 509-3374  
Address:  
120 Dickman Ave.  
Fort Leavenworth, KS 66027  
FL.bartonccc.edu

### GRANDVIEW PLAZA OUTREACH SITE

Local: (785) 238-8550  
Toll-Free: (877) 771-0255  
Address:  
100 Continental Avenue  
Grandview Plaza, KS 66441

### ONLINE LEARNING OPPORTUNITIES

BARTonline.org      edukan.org  
(866) 455-2828      (877) 433-8526

**Non-Discrimination Notice:** To provide equal employment, advancement and learning opportunities to all individuals, employment and student admission decisions at Barton will be based on merit, qualifications, and abilities. Barton Community College does not discriminate on the basis of any characteristic protected by law in all aspects of employment and admission in its education programs or activities. Any person having inquiries concerning Barton Community College's non-discrimination compliance policy, including the application of Equal Opportunity Employment, Titles IV, VI, VII, IX, Section 504 and the implementing regulations, is directed to contact the College's Compliance Officer, Barton Community College, Room A-123, Great Bend, Kansas 67530, (620) 792-2701. Any person may also contact the Director, Office of Civil Rights, U.S. Department of Education, Washington, DC 20201.

