

BARTON

COMMUNITY COLLEGE

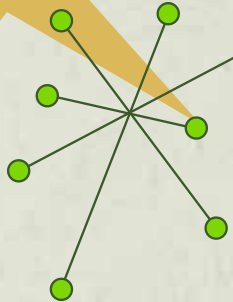

Calendar Viewbook 2019-20

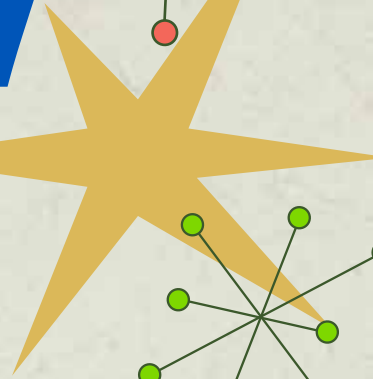
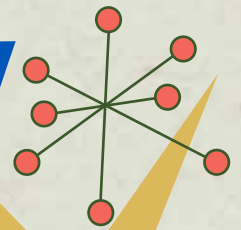

GoBarton.com

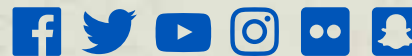



Memories for the making!

Barton has more than 50 fun student activities planned through the year!

Hawaiian Luau
\$3 Movie Nights
Free Shoulder Massages
Dance Nights

Bowling Nights
Mix and Mingle Bingo
Casino Night
Ice Cream Socials

Late Night Breakfasts
Mardi Gras Celebration
Cinco de Mayo
Skating and Laser Tag Nights

SEPTEMBER 2019

AUGUST 2019						
S	M	T	W	T	F	S
				1	2	3
4	5	6	7	8	9	10
11	12	13	14	15	16	17
18	19	20	21	22	23	24
25	26	27	28	29	30	31

OCTOBER 2019						
S	M	T	W	T	F	S
			1	2	3	4
5	6	7	8	9	10	11
12	13	14	15	16	17	18
19	20	21	22	23	24	25
26	27	28	29	30	31	

SUNDAY

Priority Deadline to Apply for Fall 2019 Graduation

1

Men's Soccer vs Rose State College 4:30 p.m.

8

15

22

Men's & Women's Bowling Sandhills Collegiate Classic at Lincoln, NE TBA

29

MONDAY

Labor Day (No Classes-Offices Closed)

2

BARTonline Fall 2019 Session 3 (6-Weeks) Begins
Men's & Women's Golf Swede Invitational at Salina, KS 9 a.m.

9

Men's & Women's Golf Central Kansas Classic at McPherson, KS 9 a.m.
Volleyball at Hutchinson CC 6:30 p.m.

16

Men's & Women's Golf Crossroads JUCO Invitational at Wentzville, MO 9 a.m.
Volleyball at Colby CC 6:30 p.m.
S3 Movie Night, Golden Belt Cinema 6

23

30

TUESDAY

3

Men's & Women's Golf Swede Invitational at Salina, KS 9 a.m.

10

Constitution Day
Men's & Women's Golf Central Kansas Classic at McPherson, KS 9 a.m.
Board Game Night, Learning Resource Center - Library

17

Men's & Women's Golf Crossroads JUCO Invitational at Wentzville, MO 9 a.m.

24

WEDNESDAY

Women's Soccer at Garden City CC 4 p.m.
Men's Soccer at Garden City CC 7 p.m.

4

Women's Soccer at Hesston College 5 p.m.
Volleyball vs Dodge City CC 6:30 p.m.
Men's Soccer at Hesston College 7:30 p.m.

11

Last Day to Drop Courses Recorded as W on Transcript (1st 8-Week Session)
Women's Soccer at Pratt CC 2 p.m.
Men's Soccer at Pratt CC 4:30 p.m.
Free Bowling 7:30-9 p.m., Walnut Bowl

18

Emotion Matrix Virtual Reality Video Game 4:30-8:30 p.m., Union
Volleyball at Butler CC 6:30 p.m.

25

THURSDAY

Learn about Barton Clubs & Organizations 6:30-7:30 p.m., Union

5

S3 Movie Night, Golden Belt Cinema 6

12

Free Shoulder Massages 6-9 p.m., Union - Game Room

19

26

FRIDAY

Volleyball at Cloud County CC 5 p.m.
Volleyball vs TBA at Concordia, KS TBA

6

13

20

Volleyball vs Northeastern Oklahoma at Arkansas City, KS 10 a.m.
Volleyball vs Central Nebraska at Arkansas City, KS 2 p.m.

27

SATURDAY

Women's Soccer vs Hutchinson CC 2 p.m.
Men's Soccer vs Western Texas College 4:30 p.m.

7

Women's Soccer vs Dodge City CC 2 p.m.
Men's Soccer vs Dodge City CC 4:30 p.m.

14

Swimming at Sam Freas Invitational at Edmond, OK 1 p.m.
Women's Soccer vs Cloud County CC 2 p.m.
Volleyball vs Seward County CC 2 p.m.
Men's Soccer vs Cloud County CC 4:30 p.m.

21

Volleyball vs Longview at Arkansas City, KS 8 a.m.
Barton's 50th Birthday Party: Open House 11 a.m. -4 p.m., Barton County Campus
Volleyball at Cowley CC 12 p.m.
Women's Soccer vs Garden City CC 2 p.m.
Men's Soccer vs Garden City CC 4:30 p.m.
Men's & Women's Bowling Sandhills Collegiate Classic at Lincoln, NE TBA



**Fall in Love
with Barton**

*Don't forget to register
for Senior Day
November 13!*



**SENIOR
DAY** 

Registration ends October 31.
Check seniorday.bartonccc.edu for details!

OCTOBER 2019

SEPTEMBER 2019						
S	M	T	W	T	F	S
1	2	3	4	5	6	7
8	9	10	11	12	13	14
15	16	17	18	19	20	21
22	23	24	25	26	27	28
29	30					

NOVEMBER 2019						
S	M	T	W	T	F	S
						1
						2
3	4	5	6	7	8	9
10	11	12	13	14	15	16
17	18	19	20	21	22	23
24	25	26	27	28	29	30

SUNDAY

MONDAY

TUESDAY

WEDNESDAY

THURSDAY

FRIDAY

SATURDAY

BARTonline Fall 2019 Session 1 (8-Weeks) Ends

Fall 2019 Classes Begin (2nd 8-Week Session)
Men's & Women's Golf Blue Devil Fall Classic at Kansas City, KS 9 a.m.
Volleyball at Dodge City CC 6:30 p.m.

Men's & Women's Golf Blue Devil Fall Classic at Kansas City, KS 9 a.m.
Save a Life Tour 4:30-8:30 p.m., Union

Women's Soccer at Hutchinson CC 6 p.m.
Volleyball at Garden City CC 6:30 p.m.

\$3 Movie Night, Golden Belt Cinema 6

Fall 2019 Classes End (1st 8-Week Session)
Volleyball vs Labette CC 2 p.m.
Swimming Sunflower Showdown at Topeka, KS 2 p.m.
Volleyball vs Iowa Western CC 6 p.m.

Women's Soccer vs Hesston College 2 p.m.
Volleyball vs Cloud County CC 2 p.m.
Men's Soccer vs Hesston College 4:30 p.m.
Volleyball vs Pratt CC 6 p.m.

6

7

8

9

10

11

12

Men's & Women's Bowling Andy B's Invitational at Springfield, MO TBA

BARTonline Fall 2019 Session 4 (8-Weeks) Begins
Candy Corn Guessing Jar Contest Begins, Library
Men's & Women's Golf Barton Invitational 9 a.m.
Skating & Laser Tag 7-9 p.m., Up & Rolling Skate Center

Men's & Women's Golf Barton Invitational 9 a.m.

Women's Soccer at Dodge City CC 1:30 p.m.
Men's Soccer at Dodge City CC 4 p.m.

Women's Soccer at Cloud County CC 2 p.m.
Men's Soccer at Cloud County CC 4:30 p.m.
Volleyball at Pratt CC 6:30 p.m.
Free Bowling 7:30-9 p.m., Walnut Bowl

Last Day for Refund (2nd 8-Week Session)
Swimming vs Midland University & Sterling College at Fremont, NE 2 p.m.
The Light of Future Past: Photography and Film Work of Blair Hays Exhibit Ends, Shafer Gallery

Women's Soccer vs Pratt CC 2 p.m.
Volleyball vs Independence CC 2 p.m.
Men's Soccer vs Pratt CC 4:30 p.m.
Men's & Women's Bowling Andy B's Invitational at Springfield, MO TBA

13

14

15

16

17

18

19

BARTonline Fall 2019 Session 3 (6-Weeks) Ends
Men's & Women's Bowling Mid-States Championships Tournament at Wichita, KS TBA

Women's Soccer vs Ottawa University JV 2 p.m.
Volleyball vs Butler CC 6:30 p.m.

Volleyball vs Colby CC 6:30 p.m.

\$3 Movie Night, Golden Belt Cinema 6

Candy Corn Guessing Jar Contest Ends, Library

Men's & Women's Bowling 11th Annual Hammer Lions Classic at St. Charles, MO TBA

20

21

22

23

24

25

26

Men's & Women's Bowling 11th Annual Hammer Lions Classic at St. Charles, MO TBA

BARTonline Fall 2019 Session 5 (6-Weeks) Begins
Volleyball vs Hutchinson CC 6:30 p.m.

Spring 2020 Enrollment Begins (Current Students)

Spring 2020 Enrollment Begins (New Students)
Volleyball at Independence CC 6:30 p.m.

Senior Day Registration deadline

27

28

29

30

31

Come on a Campus Visit

We'd love to meet you!



WELCOME

NOVEMBER 2019

OCTOBER 2019						
S	M	T	W	T	F	S
		1	2	3	4	5
6	7	8	9	10	11	12
13	14	15	16	17	18	19
20	21	22	23	24	25	26
27	28	29	30	31		

DECEMBER 2019						
S	M	T	W	T	F	S
1	2	3	4	5	6	7
8	9	10	11	12	13	14
15	16	17	18	19	20	21
22	23	24	25	26	27	28
29	30	31				

SUNDAY

MONDAY

TUESDAY

WEDNESDAY

THURSDAY

FRIDAY

SATURDAY

Daylight Savings Time Ends
Men's & Women's Bowling Jayhawk Collegiate Challenge at Lawrence, KS TBA

3

Bad Art Night, Library
Read to Preschoolers Week Begins, Library

10

Men's & Women's Bowling Bronco Open at Hastings, NE TBA
Swimming A3 Performance Invitational at Mesa, CO TBA

17

24

Last Day to Drop Courses Recorded as W on Transcript (Full Term Session)
\$3 Movie Night, Golden Belt Cinema 6

4

Women's Basketball vs Kansas Wesleyan University JV 5:30 p.m.
Men's Basketball vs Tabor College JV 7:30 p.m.

11

Swimming A3 Performance Invitational at Mesa, CO TBA
Bookmobile, Library

18

Thanksgiving Break (No Classes, Campus Open)
Jack Kilby Science Day
Men's Basketball at TBD, TBA

25

5

12

Women's Basketball at Iowa Western CC 6 p.m.

19

Thanksgiving Break (No Classes, Campus Open)

26

6

Women's Basketball vs Sterling College JV 5:30 p.m.

SENIOR DAY
Last Day to Drop Courses Recorded as W on Transcript (2nd 8-Week Session)
Free Bowling 7:30-9 p.m., Walnut Bowl

13

\$3 Movie Night, Golden Belt Cinema 6

20

Thanksgiving Break (Campus Closed)

27

7

Free Shoulder Massages 6-9 p.m., Union - Game Room

14

21

Thanksgiving Break (Campus Closed)

28

1

Swimming UNK Quad at Kearney, NE TBA
Volleyball vs Garden City CC 6:30 p.m.
Barton County Arts Council Friends and Acquaintances Art Exhibit Begins, Shafer Gallery

8

Swimming Mustang Pre-Invitational at Sioux City, IA TBA
Women's Basketball vs TBA at Hutchinson, KS 1 p.m.
Men's Basketball vs TBD at Hutchinson, KS TBA

Women's Basketball vs TBD 5:30 p.m.
Men's Basketball vs TBD 7:30 p.m.

15

Women's Basketball at Redlands CC 5:30 p.m.
Men's Basketball vs TBD at Council Bluffs, IA TBA

22

Thanksgiving Break (Campus Closed)

29

2

Men's & Women's Bowling Jayhawk Collegiate Challenge at Lawrence, KS TBA
Swimming UNK Quad at Kearney, NE TBA
Wrestling Cowboy Open at Laramie, WY 9 a.m.
Women's Basketball vs Redlands CC 5:30 p.m.
Men's Basketball vs McPherson College JV 7:30 p.m.

9

Swimming Mustang Invitational at Sioux City, IA TBA
Wrestling OCU Open at Oklahoma City, OK 9 a.m.
Women's Basketball vs TBA at Hutchinson, KS 1 p.m.
Men's Basketball vs TBD at Hutchinson, KS TBA
Men's Basketball vs Murray State College at Hutchinson, KS 4 p.m.

Men's & Women's Bowling Bronco Open at Hastings, NE TBA
Swimming A3 Performance Invitational at Mesa, CO TBA
Wrestling Swede Open at Lindsborg, KS 9 a.m.
Women's Basketball vs Labette CC 5:30 p.m.
Men's Basketball vs Monroe CC 7:30 p.m.

16

Men's Basketball vs Cloud County CC at Iowa Western Classic 2 p.m.
Wrestling UNK Holiday Inn Open at El Reno, OK 5:30 p.m.
Men's Basketball at Iowa Western 7 p.m.

23

Women's Basketball vs Cowley CC 5:30 p.m.
Men's Basketball vs Cowley CC 7:30 p.m.

30

Learning wherever you are

Get a jumpstart on your future with BARTonline!

WINTER INTERSESSION 2019

4 weeks December 9 - January 5

SPRING 2020

Session 1	8 weeks	January 13 - March 8
Session 2	16 weeks	January 20 - May 10
Session 3	6 weeks	February 10 - March 22
Session 4	8 weeks	March 16 - May 10
Session 5	6 weeks	March 30 - May 10

SPRING INTERSESSION 2020

4 weeks April 13 - May 10

SUMMER 2020

Session 1	6 weeks	May 18 - June 28
Session 2	8 weeks	June 1 - July 26
Session 3	6 weeks	June 15 - August 9

FALL 2020

Session 1	4 weeks	August 10 - October 4
Session 2	3 weeks	August 17 - December 6
Session 3	6 weeks	September 9 - October 18
Session 4	6 weeks	October 12 - December 6
Session 5	6 weeks	October 26 - December 6
Session 6	4 weeks	December 7 - January 3



BARTonline

online.bartonccc.edu

DECEMBER 2019

NOVEMBER 2019						
S	M	T	W	T	F	S
					1	2
3	4	5	6	7	8	9
10	11	12	13	14	15	16
17	18	19	20	21	22	23
24	25	26	27	28	29	30

JANUARY 2020						
S	M	T	W	T	F	S
			1	2	3	4
5	6	7	8	9	10	11
12	13	14	15	16	17	18
19	20	21	22	23	24	25
26	27	28	29	30	31	

SUNDAY	MONDAY	TUESDAY	WEDNESDAY	THURSDAY	FRIDAY	SATURDAY
Holiday Open House, Shafer Gallery 1-4 p.m.	Summer 2020 Enrollment Begins	Late Night Breakfast 8-9 p.m., Union	First Day of Finals Women's Basketball vs Coffeyville CC 5:30 p.m. Men's Basketball vs Coffeyville CC 7:30 p.m.	Finals	Finals	Swimming Hendrix Invitational at Conway, AR TBA Wrestling Bob Smith Open at Hays, KS 9 a.m. Women's Basketball at Independence CC 5:30 p.m. Men's Basketball at Independence CC 7:30 p.m. Airport/Bus Transportation, Sign up Required, Wichita TBA
1	2	3	4	5	6	
BARTonline Fall Session 2 (16-Weeks) Ends BARTonline Fall Session 4 (8-Weeks) Ends BARTonline Fall Session 5 (6-Weeks) Ends	Last Day of Finals Fall 2019 Classes End (Full Term and 2nd 8-Week Sessions) BARTonline Winter Intersession (4-Weeks) Begins Bookmobile, Library	No Classes, Campus Open Bookmobile, Library	No Classes, Campus Open Women's Basketball vs Neosho County CC 5:30 p.m. Men's Basketball vs Neosho County CC 7:30 p.m.	No Classes, Campus Open	No Classes, Campus Open Barton County Arts Council Friends and Acquaintances Art Exhibit Ends, Shafer Gallery	Wrestling Beaver Open at Pratt, KS 9 a.m.
8	9	10	11	12	13	14
	No Classes, Campus Open Crafting Seminar, Library	No Classes, Campus Open	No Classes, Campus Open	Christmas/New Year Break Begins Campus Closed	Campus Closed	
15	16	17	18	19	20	21
	Campus Closed	Campus Closed Christmas Eve	Campus Closed Christmas Day	Campus Closed	Campus Closed	
22	23	24	25	26	27	28
	Campus Closed	Campus Closed Fall 2019 Term Ends New Year's Eve				
29	30	31				

We're a
Smitten
Kitten
for you!

*Don't forget to
register for
Junior Day
February 12!*



Registration ends January 31. Check juniorday.bartonccc.edu for details!

JANUARY 2020

DECEMBER 2019						
S	M	T	W	T	F	S
1	2	3	4	5	6	7
8	9	10	11	12	13	14
15	16	17	18	19	20	21
22	23	24	25	26	27	28
29	30	31				

FEBRUARY 2020						
S	M	T	W	T	F	S
						1
2	3	4	5	6	7	8
9	10	11	12	13	14	15
16	17	18	19	20	21	22
23	24	25	26	27	28	29

SUNDAY MONDAY TUESDAY WEDNESDAY THURSDAY FRIDAY SATURDAY

			New Year's Day (Campus Closed) Spring 2020 Term Begins	No Classes, Campus Open		Airport/Bus Transportation Pick up, Wichita TBA Women's Basketball at Butler CC 1 p.m. Men's Basketball at Butler CC 3 p.m.
			1	2	3	4
BARTonline Winter Intersession (4-Weeks) Ends	Spring 2020 Classes Begin (Full Term and 1st 8-Week Sessions)		Women's Basketball vs Cloud County CC 5:30 p.m. Men's Basketball vs Cloud County CC 7:30 p.m.	\$3 Movie Night, Golden Belt Cinema 6	Spring 2020 Enrollment Ends Wrestling NJCAA D1 Dual Tournament at Miami, OK TBA	Men's & Women's Bowling SWIBC at Richardson, TX TBA Wrestling NJCAA D1 Dual Tournament at Miami, OK TBA Swimming at University of Missouri-St Louis 1 p.m. Women's Basketball at Allen County CC 2 p.m. Men's Basketball at Allen County CC 4 p.m.
5	6	7	8	9	10	11
Karaoke, Library Men's & Women's Bowling SWIBC at Richardson, TX TBA	BARTonline Spring 2020 Session 1 (8-Weeks) Begins Women's Basketball at Pratt CC 5:30 p.m. Men's Basketball at Pratt CC 7:30 p.m.		Wrestling at Cloud County CC TBA Women's Basketball vs Dodge City CC 5:30 p.m. Men's Basketball vs Dodge City CC 7:30 p.m.	Free Shoulder Massages 6-9 p.m., Union – Game Room	Last Day for Refund (Full Term and 1st 8-Week Sessions) Swimming Colorado College Classic at Colorado Springs, CO TBA	Men's & Women's Bowling KEGEL/ISBPA Midwest Collegiate Classic at Addison, IL TBA Swimming Colorado College Classic at Colorado Springs, CO TBA Women's Basketball at Colby CC 6 p.m. Men's Basketball at Colby CC 8 p.m.
12	13	14	15	16	17	18
Men's & Women's Bowling KEGEL/ISBPA Midwest Collegiate Classic at Addison, IL TBA Swimming Colorado College Classic at Colorado Springs, CO TBA Wrestling 10th Annual Reece Wright-Conklin Jet Invitational at Wichita, KS 9 a.m.	Martin Luther King, Jr. Day (No Classes, Campus Closed) BARTonline Spring 2020 Session 2 (16-Weeks) Begins	Sunflower Guessing Jar Contest Begins, Library \$3 Movie Night, Golden Belt Cinema 6	Wrestling at NW Kansas Technical College TBA Women's Basketball vs NW Kansas Technical College 5:30 p.m. Men's Basketball vs NW Kansas Technical College 7:30 p.m.			Wrestling York Open at York, NE 9 a.m. Swimming Barton Winter Classic 1 p.m. Women's Basketball vs Seward County CC 5:30 p.m. Men's Basketball vs Seward County CC 7:30 p.m.
19	20	21	22	23	24	25
			Wrestling vs Colby CC TBA Women's Basketball at Hutchinson CC 5:30 p.m. Men's Basketball at Hutchinson CC 7:30 p.m. Free Bowling 7:30-9 p.m., Walnut Bowl	Sunflower Guessing Jar Contest Ends, Library	Junior Day Registration deadline	
26	27	28	29	30	31	

Dorm Life Rocks!

FEATURES

- ❖ Wireless Internet
- ❖ Three FREE Laundromats
- ❖ 19 meals per week
- ❖ Single room options
- ❖ FREE cable
- ❖ 12 newly released movies each month
- ❖ FREE parking
- ❖ Vending machines
- ❖ Room furniture includes a desk, wardrobe and twin bed
- ❖ Community room with TV and game consoles
- ❖ ADA compliant rooms
- ❖ Community kitchen facilities
- ❖ Designated storm shelter areas
- ❖ 24-hour security and camera surveillance
- ❖ Purified water stations
- ❖ Ice machines

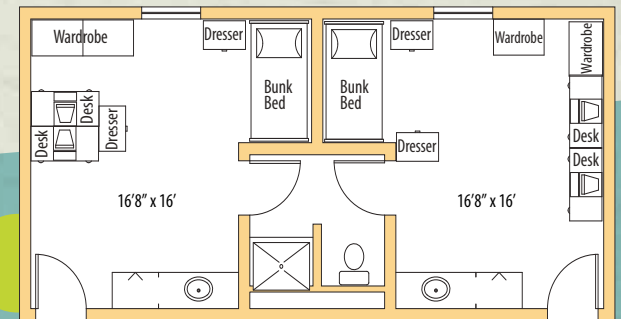

Bluestem Hall: Twin suite, double occupancy - Handicap accessible rooms available

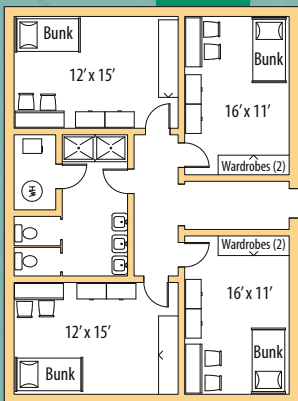

Meadowlark Halls:
There will be some variation between units
"Community Style" (6-7 people per unit)

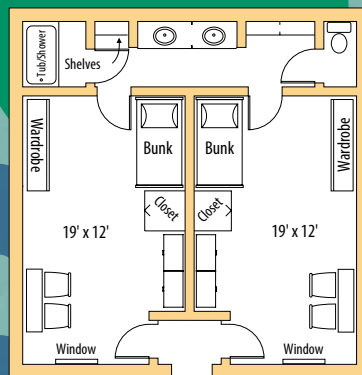

Sunflower Halls:
Two rooms, double occupancy
"Apartment Style" (2 people per room)

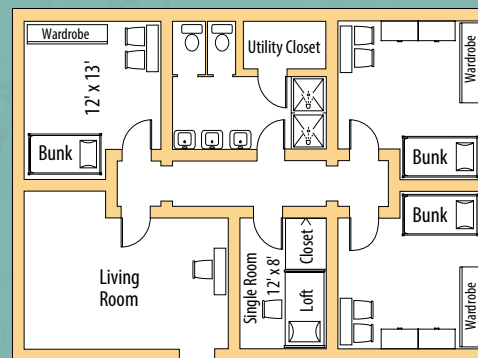

Bison Halls:
There will be some variation between units
"Community Style" (6-7 people per unit)

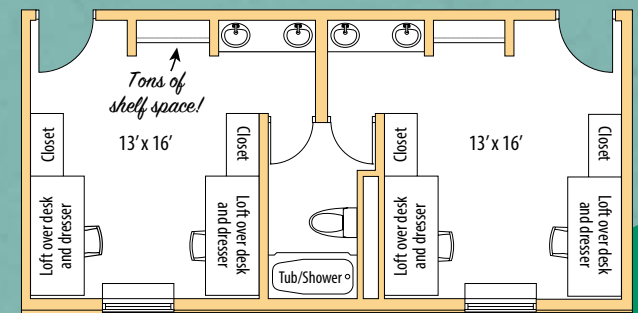

Cottonwood Hall: Handicap accessible rooms available
"Traditional Style" (2 people per room)

FEBRUARY 2020

JANUARY 2020						
S	M	T	W	T	F	S
			1	2	3	4
5	6	7	8	9	10	11
12	13	14	15	16	17	18
19	20	21	22	23	24	25
26	27	28	29	30	31	

MARCH 2020						
S	M	T	W	T	F	S
1	2	3	4	5	6	7
8	9	10	11	12	13	14
15	16	17	18	19	20	21
22	23	24	25	26	27	28
29	30	31				

SUNDAY

MONDAY

TUESDAY

WEDNESDAY

THURSDAY

FRIDAY

SATURDAY

Men's & Women's Bowling McKendree Baker Challenge at Fairview Heights, IL TBA
Super Bowl party 5:30 p.m., Union

2

Wrestling KJCCC Conference Duals at Colby, KS TBA

9

Men's & Women's Bowling 50th Annual Columbia 300 Hoosier Classic at Indianapolis, IN TBA

16

Baseball vs Western Nebraska CC 1 p.m.

23

3

BARTonline Spring 2020 Session 3 (6-Weeks) Begins
Women's Basketball vs Colby CC 5:30 p.m.

10

\$3 Movie Night, Golden Belt Cinema 6

17

24

4

Baseball vs Hesston College TBD

18

Mardi Gras Celebration 11-1:15 p.m., Union
Softball vs Cowley County CC 1 p.m.

25

5

JUNIOR DAY
Last Day to Drop Courses Recorded as W on Transcript (1st 8-Week Session)
Women's Basketball at NW Kansas Technical College 7 p.m.
Men's Basketball at NW Kansas Technical College 9 p.m.
Free Bowling 7:30-9 p.m., Walnut Bowl

12

Women's Basketball vs Hutchinson CC 5:30 p.m.
Men's Basketball vs Hutchinson CC 7:30 p.m.

19

Career Fair
Baseball vs Kansas Wesleyan University JV 1 p.m.
Women's Basketball Region VI Division I First Round TBA
Men's Basketball Region VI 1st Round TBA

26

6

\$3 Movie Night, Golden Belt Cinema 6

13

Softball vs Sterling JV 1 p.m.

20

27

7

Softball vs TBD at Cisco, TX TBA
Baseball at Carl Albert State College 12 p.m.

14

Valentine's Day
Valentine Give Away 11-12:30 p.m., Union
Men's & Women's Bowling 50th Annual Columbia 300 Hoosier Classic at Indianapolis, IN TBA
Baseball at Rose State College 3 p.m.

21

Spring 2020 Classes End (1st 8-Week Session)
Softball vs TBD at Altus, OK TBA

28

Priority Deadline to Apply for Spring 2020 Graduation
Men's & Women's Bowling McKendree Baker Challenge at Fairview Heights, IL TBA
Softball vs Lamar CC 1 p.m.
Women's Basketball at Garden City CC 2 p.m.
Men's Basketball at Garden City CC 4 p.m.

8

Wrestling KJCCC Conference Duals at Colby, KS TBA
Softball vs TBD at Cisco, TX TBA
Baseball at Carl Albert State College 12 p.m.
Women's Basketball at Dodge City CC 1 p.m.
Men's Basketball at Dodge City CC 3 p.m.

15

Men's & Women's Bowling 50th Annual Columbia 300 Hoosier Classic at Indianapolis, IN TBA
Softball vs Hesston College 1 p.m.
Baseball at Rose State College 1 p.m.
Women's Basketball at Seward County CC 6 p.m.
Men's Basketball at Seward County CC 8 p.m.

22

Wrestling NJCAA West/Central District Championships at Miami, OK TBA
Softball vs TBD at Harrison TBA
Baseball vs Western Nebraska CC 1 p.m.
Women's Basketball vs Garden City CC 5:30 p.m.
Men's Basketball vs Garden City CC 7:30 p.m.

29

Women's Basketball Region VI Division I Quarterfinals at Dodge City, KS TBA
Softball vs TBD at Altus, OK TBA



Make Your Dreams Happen

Need help paying for college? We've got your back! We paid out more than \$8 million in financial aid last year!

Barton Bound Scholarships

This scholarship is geared toward incoming freshmen. It is automatically applied upon completion of an Admissions Application and is based on ACT scores or GPA, whichever yields a higher reward amount. See the chart for the various levels.

- To qualify for a Barton Bound scholarship, students must submit an admissions application no later than May 1st. (Students graduating from High School in December have a December 1st application deadline.)
- Only full-time students (12 hours or more) are eligible to receive the Barton Bound scholarships.
- The student will be offered the highest award possible based on their official HS transcript and/or ACT scores.
- Students must complete a Free Application for Federal Student Aid (FAFSA) and send it to Barton before any institutional scholarships will be awarded.
www.fafsa.gov school code 004608
- Students taking courses that are covered by our UOF scholarships, such as LSEC, BSEP, TROOP, are not eligible for this scholarship.
- Barton institutional scholarships will not be applied toward any EduKan courses.
- The scholarship will be available up to six full-time semesters, automatically renewing based on enrollment and the students cumulative Barton GPA at the end of the spring semester. The

2019-2020 COST INFORMATION

➔ Fill out the free application for Federal Student Aid at fafsa.ed.gov (Barton's Code: 004608)

➔ Payment options also available

Cost per credit hour

In-District - \$107

In-State - \$114

Out-of-State - \$134

International - \$197

**Subject to change by the State of Kansas*

Online Costs

BARTonline \$150 per semester credit hour

EduKan \$150 per semester credit hour

Annual Cost Estimates - In-state

TOTAL COST \$10,271**

**based on 16 credit hours per semester x 2 semesters, estimated books cost and housing

Annual Cost Estimates - Out-of-state

TOTAL COST \$11,741**

**based on 16 credit hours per semester x 2 semesters, estimated books cost and housing

*The Barton Board of Trustees has the right to change tuition without notice. **Cost is estimated based on basic charges and do not include other personal costs or costs associated with various classes nor cost of online courses.



student will not have to complete a new scholarship application for renewal of their award.

- Returning Barton students may not apply for an academic scholarship, only new /incoming students are eligible to apply.
- In addition to an academic scholarship, a student may receive federal, state, and local aid, and Barton performance or work study awards.
- Book scholarship recipients who fail to return their books by the established deadline will be charged the full price for the books. Additionally, failure to return the books to the Barton bookstore will result in the loss of the tuition/book scholarship during future semesters

Campus Employment

Get an on-campus job that aligns with your career and education goals! Positions include photographer, office worker, bookstore employee, art gallery attendant, lifeguard, maintenance worker, computer lab monitor and more!

Activity and Departmental Scholarships

Get a scholarship for your skills or hobbies! Areas offering Activity and Departmental awards include: Admissions, Agriculture, Art, Automotive, Band, Business, Cheer, Criminal Justice, Drama, Early Childhood, Engineering, EMS, HALO, Medical Assistant, MLT, Music, Natural Gas, Nursing, Networking and Student Senate.

Foundation Scholarships

Thanks to the generosity of many donors, endowments and annually funded scholarships with a wide variety of criteria are available to assist students.

Scholarship application priority deadline is June 1 prior to the academic year. The application can be found at bartonccfoundation.org.

Barton Bound Scholarships

For more information, visit financialaid.bartonccc.edu

AWARD	AWARD AMOUNT	KANSAS HS GPA	OR	ACT SCORE
Excellence Award	Tuition & Books	3.6 and above	or	26+
Honor Award	\$1,000	3.0 - 3.59	or	24 - 25
Achievement Award	\$800	2.5 - 2.99	or	22 - 23

For more information, visit financialaid.bartonccc.edu

Are you ready to take the next step?

Enrollment Days

Wednesday, April 15	1 p.m. & 6 p.m.
Tuesday, April 21	9 a.m. & 1p.m.
Wednesday, April 22	1 p.m. & 6 p.m.
Wednesday, April 29	9 a.m. & 1 p.m.
Wednesday, May 13	1 p.m.
Wednesday, May 20	1 p.m.
Wednesday, June 3	1 p.m.
Wednesday, June 10	1 p.m.
Wednesday, June 17	1 p.m.
Tuesday, June 23	1 p.m.
Wednesday, July 8	1 p.m.
Wednesday, July 15	1 p.m.
Wednesday, July 22	1 p.m.
Wednesday, July 29	1 p.m.



Look what you can
do in    day!

- Meet with an academic advisor
- Plan and enroll for classes
- Meet with a Financial Aid Advisor
- Make payment arrangements with the Business Office
- Meet with Student Support Services
- Take assessment test (if needed)

MARCH 2020

FEBRUARY 2020						
S	M	T	W	T	F	S
						1
2	3	4	5	6	7	8
9	10	11	12	13	14	15
16	17	18	19	20	21	22
23	24	25	26	27	28	29

APRIL 2020						
S	M	T	W	T	F	S
						1
						2
						3
						4
5	6	7	8	9	10	11
12	13	14	15	16	17	18
19	20	21	22	23	24	25
26	27	28	29	30		

SUNDAY	MONDAY	TUESDAY	WEDNESDAY	THURSDAY	FRIDAY	SATURDAY
<p>Men's Basketball Region VI Quarterfinals at Dodge City, KS TBA</p> <p>1</p> <p>Daylight Savings Time Begins BARTonline Spring 2020 Session 1 (8-Weeks) Ends</p>	<p>Spring 2020 Classes Begin (2nd 8-Week Session)</p> <p>Baseball at Kansas Wesleyan University JV 1 p.m.</p> <p>Women's Basketball Region VI Division I Semifinals at Dodge City, KS TBA</p> <p>Men's Basketball Region VI Semifinals at Dodge City, KS TBA</p> <p>2</p> <p>Baseball vs North Iowa Area CCTBA</p> <p>\$3 Movie Night, Golden Belt Cinema 6</p>	<p>Women's Basketball Region VI Division I Championship at Dodge City, KS TBA</p> <p>Men's Basketball Region VI Championship at Dodge City, KS TBA</p> <p>3</p>	<p>Swimming NJCAA Swimming & Diving Championships at Fort Pierce, FL TBA</p> <p>Softball at NW Kansas Technical College TBA</p> <p>4</p> <p>Softball at Hutchinson CCTBA</p> <p>Free Bowling 7:30-9 p.m., Walnut Bowl</p>	<p>Swimming NJCAA Swimming & Diving Championships at Fort Pierce, FL TBA</p> <p>Men's & Women's Bowling NJCAA Bowling Championships at Cheektowga, NY TBA</p> <p>Baseball at Hutchinson CC 1 p.m.</p> <p>Free Shoulder Massages 6-9 p.m., Union - Game Room</p> <p>5</p> <p>Baseball vs Colby CC 1 p.m.</p>	<p>Last Day for Refund (2nd 8-Week Session)</p> <p>Swimming NJCAA Swimming & Diving Championships at Fort Pierce, FL TBA</p> <p>Men's & Women's Bowling NJCAA Bowling Championships at Cheektowga, NY TBA</p> <p>Wrestling NJCAA National Championships at Council Bluffs, IA TBA</p> <p>6</p>	<p>Swimming NJCAA Swimming & Diving Championships at Fort Pierce, FL TBA</p> <p>Men's & Women's Bowling NJCAA Bowling Championships at Cheektowga, NY TBA</p> <p>Wrestling NJCAA National Championships at Council Bluffs, IA TBA</p> <p>Baseball vs Hutchinson CC 1 p.m.</p> <p>Softball vs Independence CC 1 p.m.</p> <p>7</p> <p>Softball at Pratt CCTBA</p> <p>Baseball at Colby CC 1 p.m.</p>
<p>8</p>	<p>9</p>	<p>10</p>	<p>11</p>	<p>12</p>	<p>13</p>	<p>14</p>
	<p>Spring Break (No Classes, Campus Open)</p> <p>BARTonline Spring 2020 Session 4 (8-Weeks) Begins</p> <p>Men's Basketball NJCAA Division I Championship Tournament at Hutchinson, KS TBA</p>	<p>Spring Break (No Classes, Campus Open)</p>	<p>Spring Break (No Classes, Campus Open)</p>	<p>Spring Break (Campus Closed)</p> <p>Baseball at Dodge City CC 1 p.m.</p>	<p>Spring Break (Campus Closed)</p>	<p>Baseball vs Dodge City CC 1 p.m.</p> <p>Softball at Colby CC 1 p.m.</p>
<p>15</p> <p>BARTonline Spring 2020 Session 3 (6-Weeks) Ends</p> <p>Softball vs Northern Oklahoma College - Tonkawa 1 p.m.</p>	<p>16</p> <p>Murder Mystery Scavenger Hunt Begins, Library</p>	<p>17</p> <p>Baseball vs Redlands CC 12 p.m.</p>	<p>18</p> <p>Softball vs Butler CC 1 p.m.</p>	<p>19</p> <p>Baseball vs Coffeyville CCTBD</p> <p>\$3 Movie Night, Golden Belt Cinema 6</p>	<p>20</p>	<p>21</p> <p>Baseball vs Coffeyville CCTBD</p> <p>Softball at Dodge City CCTBA</p>
<p>22</p>	<p>23</p>	<p>24</p>	<p>25</p>	<p>26</p>	<p>27</p>	<p>28</p>
	<p>BARTonline Spring 2020 Session 5 (6-Weeks) Begins</p> <p>Murder Mystery Scavenger Hunt Ends, Library</p> <p>Skating & Laser Tag 7-9 p.m., Up & Rolling Skate Center</p>					
<p>29</p>	<p>30</p>	<p>31</p>				



College is what you make of it

*Have fun!
Enhance your college experience!
Get involved!
Meet new people!*



Student Activities & Organizations

Alpha Sigma Lambda
Art Club
Barton Collegiate Farm Bureau
Barton Spark
Barton STEM
Barton Student Chapter of American
Choral Directors Association (ACDA)
Barton Theatre
Cheerleaders, Yell Leaders, and Mascots
Christian Challenge
Community Student Organization

Computer Club
Concert Band
Concert Choir
Contagious
Cougar Danz Force
Da Capo
Dante Deo
Dolce
Hilltop Singers
Hispanic American Leadership Organization (HALO)
Jazz Band

Kappa Beta Chi Chapter
National Association for Music Education
(NAfME)
Non-Traditional National Honor Society
Nursing Club
Orchestra
Pep Band
Phi Theta Kappa
Student Ambassadors
Student Government Association

APRIL 2020

MARCH 2020						
S	M	T	W	T	F	S
1	2	3	4	5	6	7
8	9	10	11	12	13	14
15	16	17	18	19	20	21
22	23	24	25	26	27	28
29	30	31				

MAY 2020						
S	M	T	W	T	F	S
						1
2	3	4	5	6	7	8
9	10	11	12	13	14	15
16	17	18	19	20	21	22
23	24	25	26	27	28	29
30	31					

SUNDAY

MONDAY

TUESDAY

WEDNESDAY

THURSDAY

FRIDAY

SATURDAY

1

2

3

4

5

6

7

8

9

10

11

12

13

14

15

16

17

18

19

20

21

22

23

24

25

26

27

28

29

30

31

Ice Cream Social 7:30-8:30 p.m., Union

Last Day to Drop Courses Recorded as W on Transcript (Full Term Session)
Baseball vs Seward County CC 1 p.m.

Softball vs Garden City CC 1 p.m.

Baseball at Seward County CC 1 p.m.
Softball vs Seward County CC 1 p.m.

53 Movie Night, Golden Belt Cinema 6

Hispanic Culture Day
Advisement Day (Barton County Campus Day Classes Cancelled, Night Classes Held)
Summer and Fall 2020 Enrollment Begins (Current Students)

Summer and Fall 2020 Enrollment Begins (New Students)
Softball vs Hutchinson CC 1 p.m.

Baseball at Butler CC 1 p.m.

Good Friday (No Classes, Campus Closed)

Baseball at Butler CC 1 p.m.

Baseball at Pratt CC 1 p.m.

Easter

Easter Monday (No Classes, Campus Closed)
BARTonline Spring Intersession (4-Weeks) Begins

Free Bowling 7:30-9 p.m., Walnut Bowl
Softball at Butler CC TBA
Enrollment Days 1 p.m. & 6 p.m.

Baseball vs Pratt CC 1 p.m.
Softball at Independence CCTBA

Baseball at Pratt CC 1 p.m.

Stress Re-Duck-Sion Event Begins, Library
Baseball vs McPherson College JV 4 p.m.
S3 Movie Night, Golden Belt Cinema 6

Last Day to Drop Courses Recorded as W on Transcript (2nd 8-Week Session)
Enrollment Days 9 a.m. & 1 p.m.

Softball vs Pratt CC 1 p.m.

Enrollment Days 1 p.m. & 6 p.m.

Softball vs Pratt CC 1 p.m.

Enrollment Days 9 a.m. & 1 p.m.

Baseball at Garden City CC 1 p.m.
Pizza 8-8:30pm | Matt the Knife 8:30 p.m., Union

Baseball vs Garden City CC 1 p.m.
Softball vs SE Nebraska CC 2 p.m.

Stress Re-Duck-Sion Event Ends, Library

Enrollment Days 9 a.m. & 1 p.m.

Baseball vs Cloud County CC 1 p.m.
Learn the Right Way to Check out of Housing 6:30 p.m., Union

Congrats graduates! You did it.

You're on the path to becoming a Cougar!

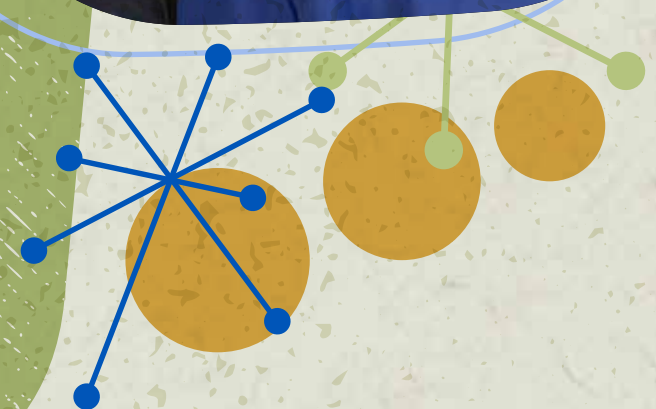

MAY 2020

APRIL 2020						
S	M	T	W	T	F	S
			1	2	3	4
5	6	7	8	9	10	11
12	13	14	15	16	17	18
19	20	21	22	23	24	25
26	27	28	29	30		

JUNE 2020						
S	M	T	W	T	F	S
	1	2	3	4	5	6
7	8	9	10	11	12	13
14	15	16	17	18	19	20
21	22	23	24	25	26	27
28	29	30				

SUNDAY	MONDAY	TUESDAY	WEDNESDAY	THURSDAY	FRIDAY	SATURDAY
					Softball Region VI Tournament at Dodge City, KS TBA	Baseball at Cloudy County CC 1 p.m. Softball Region VI Tournament at Dodge City, KS TBA
					1	2
	First Day of Finals Late Night Breakfast 8-9 p.m. Photo Booth 8-10 p.m., Union	Finals	Finals	Last Day of Finals Spring 2020 Classes End (Full Term and 2nd 8-Week Sessions) Baseball Region VI Playoffs TBA – 1st Round \$3 Movie Night, Golden Belt Cinema 6	50th Commencement Baseball Region VI Playoffs TBA – 1st Round	Airport/Bus Transportation, Sign up Required, Wichita TBA Baseball Region VI Playoffs TBA – 1st Round
3	4	5	6	7	8	9
BARTonline Spring 2020 Session 2 (16-Weeks) Ends BARTonline Spring 2020 Session 4 (8-Weeks) Ends BARTonline Spring 2020 Session 5 (6-Weeks) Ends BARTonline Spring Intersession (4-Weeks) Ends	Summer Hours Begin (Thru July 31st)		Softball NJCAA District E Championship TBA Baseball Central District Tournament at Wichita, KS TBA Enrollment Days 1 p.m.	Softball NJCAA District E Championship TBA Baseball Central District Tournament at Wichita, KS TBA	Summer Hours (Campus Closed) Baseball Central District Tournament at Wichita, KS TBA	Baseball Central District Tournament at Wichita, KS TBA
10	11	12	13	14	15	16
Baseball Central District Tournament at Wichita, KS TBA			Softball NJCAA Division I Championship at St. George, UT TBA Enrollment Days 1 p.m.	Summer 2020 Enrollment Ends	Summer Hours (Campus Closed)	Baseball NJCAA Division I World Series at Grand Junction, CO TBA
17	18	19	20	21	22	23
	Memorial Day (No Classes, Campus Closed)				Summer Hours (Campus Closed)	
24	25	26	27	28	29	30
Spring 2020 Term Ends						
31						

Supporting you when you need it



Achieve Greatness
(We'll help!)

Academic Advising

Help select classes



Campus Security

24-hour security officers support
a safe campus



TRiO

FREE services for eligible students



Tutoring

FREE peer and professional tutoring



Counseling Services

Professional and personal counseling



Health Services

FREE basic services



Career Center

Student Employment Opportunities

JUNE 2020

MAY 2020						
S	M	T	W	T	F	S
					1	2
3	4	5	6	7	8	9
10	11	12	13	14	15	16
17	18	19	20	21	22	23
24	25	26	27	28	29	30
31						

JULY 2020						
S	M	T	W	T	F	S
			1	2	3	4
5	6	7	8	9	10	11
12	13	14	15	16	17	18
19	20	21	22	23	24	25
26	27	28	29	30	31	

SUNDAY	MONDAY	TUESDAY	WEDNESDAY	THURSDAY	FRIDAY	SATURDAY
	Summer 2020 Term Begins Priority Deadline to Apply for Summer 2020 Graduation Summer 2020 Classes Begin (Full Term and 1st 4-Week Sessions)	Last Day for Summer 2020 Enrollment (Full Term and 1st 4-Week Sessions) Last Day for Refund (Full Term and 1st 4-Week Sessions)	Enrollment Days 1 p.m.		Summer Hours (Campus Closed)	
	1	2	3	4	5	6
			Enrollment Days 1 p.m.		Summer Hours (Campus Closed)	
7	8	9	10	11	12	13
			Enrollment Days 1 p.m.	Last Day to Drop Courses Recorded as W on Transcript (1st 4-Week Session)	Summer Hours (Campus Closed)	
14	15	16	17	18	19	20
		Enrollment Days 1 p.m.		Summer 2020 Classes End (1st 4-Week Session)	Summer Hours (Campus Closed)	
21	22	23	24	25	26	27
	Summer 2020 Classes Begin (2nd 4-Week Session)					
28	29	30				

MEN'S SPORTS

- Baseball
- Basketball
- Bowling
- Cross Country
- Golf
- Soccer
- Swimming
- Tennis
- Track
- Wrestling

WOMEN'S SPORTS

- Basketball
- Bowling
- Cross Country
- Golf
- Soccer
- Softball
- Swimming
- Tennis
- Track
- Volleyball

Striving for Excellence

Home to 57 National Championships!



JULY 2020

JUNE 2020						
S	M	T	W	T	F	S
	1	2	3	4	5	6
7	8	9	10	11	12	13
14	15	16	17	18	19	20
21	22	23	24	25	26	27
28	29	30				

AUGUST 2020						
S	M	T	W	T	F	S
						1
2	3	4	5	6	7	8
9	10	11	12	13	14	15
16	17	18	19	20	21	22
23	24	25	26	27	28	29
30	31					

SUNDAY	MONDAY	TUESDAY	WEDNESDAY	THURSDAY	FRIDAY	SATURDAY
			Summer 2020 Enrollment Ends (2nd 4-Week Session) Last Day for Refund (2nd 4-Week Session)		Summer Hours (Campus Closed)	Independence Day
			1	2	3	4
			Last Day to Drop Courses Recorded as W on Transcript (Full Term Session) Enrollment Days 1 p.m.		Summer Hours (Campus Closed)	
5	6	7	8	9	10	11
			Enrollment Days 1 p.m.		Summer Hours (Campus Closed)	
12	13	14	15	16	17	18
	Last Day to Drop Courses Recorded as W on Transcript (2nd 4-Week Session)		Enrollment Days 1 p.m.	Summer 2020 Classes End (Full Term and 2nd 4-Week Sessions)	Summer Hours (Campus Closed)	
19	20	21	22	23	24	25
			Enrollment Days 1 p.m.		Summer 2020 Term Ends	
26	27	28	29	30	31	

Programs of Study

Transfer Programs

Transfer programs are designed to prepare you for transferring to a four-year college or university.

Career Programs

Career programs offer you an opportunity to pursue certificate and degree programs designed to prepare you for employment in the workplace and/or transfer to a university.

Location

Campus locations where program may be completed

BC = Barton County

FL = Ft. Leavenworth

FR = Ft. Riley

GV = Grandview Plaza

Outreach sites may be available

AGRICULTURE

Agribusiness (AS - BC)
Agricultural Economics (AS - BC)
Agricultural Education (AS - BC)
Agriculture Business Mgmt (AAS - BC)
Agriculture Communications (AS - BC)
Agriculture Transfer Option (AS - BC)
Agronomy (AS - BC)
Animal Science (AS - BC)
Beef Cattle Production (CERT2 - BC)
Crop Protection (CERT2, AAS - BC)
Food Science (AS - BC)
Forestry (AS - BC)
Golf Course Management (AS - BC)
Horticulture/Turf Management (AS - BC)
Milling Science (AS - BC)
Park Mgmt & Conservation (AS - BC)
Scales Technician (CERT1 - BC)

AUTOMOTIVE TECHNOLOGY

Automotive Tech (CERT1, CERT2, CERT3, AAS - BC)

BUSINESS/ECONOMICS

Accounting (AS, ONLINE - BC)
Agribusiness (AS - BC)

Agricultural Economics (AS - BC)
Agriculture Business Mgmt (AAS - BC)
Bus Mgmt & Leadership (CERT1, AAS - ONLINE, BC, FR)
Business (AS - ONLINE, BC)
Business Admin Technology (AAS - ONLINE, BC)
Economics (AS - ONLINE, BC)
Finance (AS - ONLINE, BC)
Golf Course Management (AS - BC)
Management (AS - ONLINE, BC)
Marketing (AS - ONLINE, BC)
Park Mgmt & Conservation (AS - BC)
Public Administration (AS - BC)
Tech Accounting Specialist (AAS - ONLINE, BC)

COMMUNICATION

English (AA - ONLINE, BC)
Journalism (AA - BC)
Modern Languages (AA - BC)
Speech Communications (AA - BC)

COMPUTER/INFORMATION TECHNOLOGY

Computer Information Systems (AS - BC)
Computer Science (AS - BC)
Networking Specialist (CERT2, AAS - ONLINE)

EARLY CHILDHOOD

Child Development (CERT1 - ONLINE, BC)
Early Childhood (AAS - ONLINE, BC)
Early Childhood Education (AS - ONLINE, BC)

EDUCATION

Art Education (AA - BC)
Early Childhood Education (AS - ONLINE, BC)
Elementary Education (AS - BC)
Math Education (AS - ONLINE, BC)
Music Education (AA - BC)
Physical Education (AS - BC)
Secondary Education (AA, AS - ONLINE, BC)
Special Education (AS - BC)

FINE AND PERFORMING ARTS

Art (AA - BC)
Art Education (AA - BC)
Dance (AA - BC)
Graphic Design (AA - BC)
Music (AA - BC)
Music Education (AA - BC)
Photography (AA - BC)
Theatre (AA - BC)

GENERAL STUDIES

General Studies (AGS - ONLINE, BC, FL, FR)
Military Studies Emphasis (AGS - GV)

HEALTH PROFESSIONS

Adv Emergency Med Tech AEMT (SAPP++ - BC)
Certified Medication Aide (SAPP++ - BC)
Certified Nurse Aide (SAPP++ - BC)
Dietary Management (AS - ONLINE)
Dietary Manager (CERT1 - ONLINE)
Dietetics (AS - ONLINE)
Emergency Medical Responder (SAPP++ - BC)
EMS Instructor Coordinator (SAPP++ - BC)
EMT (SAPP+ - GV)
Medical Admin Technology (AAS - ONLINE)
Medical Assistant (CERT2, AAS - BC)
Medical Coding (CERT2 - ONLINE)
Medical Lab Technician (AAS, ONLINE - BC)
Nursing - PN (CERT3 - BC)
Nursing - Transfer (AS - BC)
Nutrition and Health (AS - ONLINE, BC)
Paramedic (CERT3, AAS - BC, GV)
Pharmacy (AS - ONLINE, BC)
Pharmacy Technician (CERT1 - ONLINE)
Phlebotomy Training (SAPP+ - BC)
Physical Therapy (AS - ONLINE, BC)
Registered Nursing (AAS, BC)

HEALTH, PHYSICAL EDUCATION, RECREATION

Athletic Training (AS - BC)
Exercise Science (AS - BC)
Physical Education (AS - BC)
Sports Management (AS - BC)

HUMANITIES AND SOCIAL SCIENCES

Anthropology Cultural Studies (AA - ONLINE, BC)
History (AA - ONLINE, BC)
Philosophy (AA - BC)
Political Science (AA - ONLINE, BC)
Psychology (AS - ONLINE, BC)
Religion (AA - BC)
Sociology (AA - ONLINE, BC)

INDUSTRIAL/ENERGY TECHNOLOGY

Natural Gas Trans/Distrib Tech (CERT2, AAS - BC)
Scales Technician (CERT1 - BC)
Welding Technology (CERT1 - BC)

LIBERAL STUDIES

Liberal Studies (AA, AS - ONLINE, BC, FL, FR)

MILITARY STUDIES/LEADERSHIP

Military Leadership (CERT2++ - GV)
Military Logistics (CERT2++ - GV)
Military Dangerous Mat Handling (CERT2++ - GV)
Technical Studies (AAS++)

PRE-PROFESSIONAL

Architectural Engineering (AS - BC)
Architecture (AS - BC)
Chiropractic (AS - ONLINE, BC)
Dental Hygiene (AS - BC)
Dentistry (AS - ONLINE, BC)
Engineering Tech (AS - BC)
Health Information Mgmt (AS - ONLINE, BC)
Law (AA - ONLINE, BC)
Medicine (AS - ONLINE, BC)
Mortuary Science (AS - BC)
Occupational Therapy (AS - BC)
Optometry (AS - BC)
Pharmacy (AS - ONLINE, BC)
Physical Therapy (AS - ONLINE, BC)
Physical Therapy Asst (AS - BC)
Physicians Asst (AS - ONLINE, BC)
Radiology Tech (AS - ONLINE, BC)
Respiratory Therapy (AS - BC)
Social Work (AA - ONLINE, BC)
Veterinary Medicine (AS - ONLINE, BC)

PUBLIC SAFETY, CORRECTIONS & SECURITY

Adv Emergency Med Tech AEMT (SAPP++ - BC)
Corrections (CERT1, AAS - ONLINE)
Criminal Justice (AA, CERT3, AAS - BC)
Emerg Mgmt/Homeland Security (CERT2, AAS - ONLINE, GV)
EMT (SAPP+ - GV)
Hazardous Materials Mgmt (CERT2, AAS - ONLINE, GV)
Occupational Safety & Health (CERT1, AAS, SAPP++ - ONLINE, GV)
Paramedic (CERT3, AAS - BC, GV)

SCIENCE AND MATH

Biology (AS - ONLINE, BC)
Chemistry (AS - ONLINE, BC)
Engineering (AS - BC)
Geology (AS - BC)
Mathematics (AS - ONLINE, BC)
Physical Sciences (AS - ONLINE, BC)
Physics (AS - BC)
Wildlife Science (AS - ONLINE, BC)

Tours are scheduled Monday through Friday, 8:30 a.m. - 3 p.m. Tour times fill quickly, so don't delay!

Give us at least a week's notice, and we'll get your visit scheduled to fit YOUR needs!

Call (800) 722-6842 to schedule a tour today! bartonccc.edu/admissions

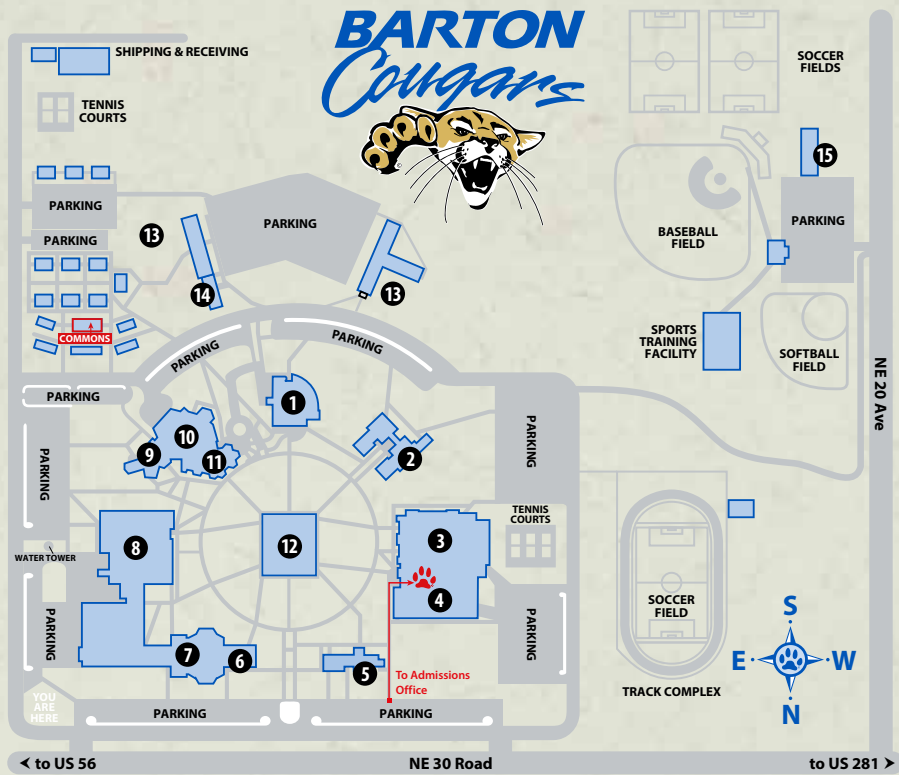

- | | |
|-----------------------------------|--|
| ① U-Building, Union | ⑨ F-30, Seminar Room |
| ② C-Building, Classroom | ⑩ F-Building, Fine Arts |
| ③ P-Building, Physical Education | ⑪ Shafer Gallery |
| ④ Kirkman Student Activity Center | ⑫ L-Building, Learning Resources Center |
| ⑤ A-Building, Administration | ⑬ Student Housing |
| ⑥ Planetarium | ⑭ Child Development Center |
| ⑦ S-Building, Science & Math | ⑮ Midwest Utility Pipeline Training Center |
| ⑧ T-Building, Technical Education | |

The Mission of Barton Community College is to provide quality educational opportunities that are accessible, affordable, continuously improving and student focused. Barton is driven to provide an educational system that is learning-centered, innovative, meets workforce needs, and strengthens communities.

BARTON

COMMUNITY COLLEGE

245 NE 30 RD • Great Bend, KS 67530
(800) 722-6842 • bartonccc.edu

About our campuses

GREAT BEND CAMPUS

bartonccc.edu

Barton's main campus is located high atop a hill on 160 acres three miles northeast of Great Bend. The main campus includes eight primary buildings, four phases of student housing, the Cougar fields, and the Midwest Utility Pipeline Training Center.

FORT RILEY CAMPUS

FR.bartonccc.edu

Barton's proud association with Fort Riley and the U.S. Army began in 1984 with a single training contract. The Fort Riley campus administration building is located in Building 211 on the main post of Fort Riley. The campus also provides instructional services for Troop School, BSEP and LSEC, which are located on Custer Hill.

Courses also are offered at a nearby outreach site located at Grandview Plaza, which is home to the Hazardous Materials Handling and Emergency Management, Emergency Medical Technician, and Paramedic programs.







FORT LEAVENWORTH CAMPUS

FL.bartonccc.edu

Barton opened a campus on Fort Leavenworth in 2012. With nearly three decades of experience operating a military-based campus at Fort Riley, Barton was well-equipped to hit the ground running. The Fort Leavenworth campus office is located in the basement of the Army Education Center at 120 Dickman Ave. Fort Leavenworth, KS 66027. The campus also provides instructional services for BSEP and LSEC and a criminal justice program.



Cougar Checklist

-  **Campus Tour** | A great way to see if Barton is the place for you!
-  **Admissions/Scholarship Application** | Application available online.
-  **Submit ACT Scores or other test scores** | Haven't taken any assessment tests? No problem! Just give us a call and we'll get you taken care of.
-  **Submit completed transcript** | Completed high school transcript must be mailed directly to Barton Community College to be official. Unofficial transcripts can be used for advising and obtaining academic information (GPA, ACT Scores, etc.)
-  **Housing Application** | Submit application and deposit early to get your first choice! Application available online.
-  **Financial Aid** | Cost should not be a reason to rule out college! Visit fafsa.ed.gov for federal assistance or call us for even more options!



Want to get started?

For more information, call the Admissions Office at (800) 722-6842 or (620) 792-9286

Directory Information

BARTON COUNTY CAMPUS

Local: (620) 792-2701
Toll-Free: (800) 748-7594
Address:
 245 NE 30 RD
 Great Bend, KS 67530
bartonccc.edu

FORT RILEY CAMPUS

Local: (785) 784-6606
Toll-Free: (877) 620-6606
Address:
 Bldg. 211 Custer Ave., P.O. Box 2463
 Fort Riley, KS 66442
FR.bartonccc.edu

FORT LEAVENWORTH CAMPUS

Local: (913) 684-9384
Toll-Free: (855) 509-3374
Address:
 120 Dickman Ave.
 Fort Leavenworth, KS 66027
FL.bartonccc.edu

GRANDVIEW PLAZA OUTREACH SITE

Local: (785) 238-8550
Toll-Free: (877) 771-0255
Address:
 100 Continental Ave.
 Grandview Plaza, KS 66441

ONLINE LEARNING OPPORTUNITIES

online.bartonccc.edu edukan.org
 (866) 455-2828 (877) 433-8526

Non-Discrimination Notice: To provide equal employment, advancement and learning opportunities to all individuals, employment and student admission decisions at Barton will be based on merit, qualifications, and abilities. Barton County Community College does not discriminate on the basis of any characteristic protected by law in all aspects of employment and admission in its education programs or activities. Any person having inquiries concerning Barton County Community College's non-discrimination compliance policy, including the application of Equal Opportunity Employment, Titles IV, VI, VII, IX, Section 504 and the implementing regulations, is directed to contact the College's Compliance Officer, Barton County Community College, Room A-123, Great Bend, Kansas 67530, (620) 792-2701. Any person may also contact the Director, Office of Civil Rights, U.S. Department of Education, Washington, DC 20201.

