

BARTON

COMMUNITY COLLEGE



2020-21 VIEWBOOK

GoBarton.com |      

Activities

Hawaiian Luau
\$3 Movie Nights
Free Shoulder Massages
Dance Nights
Bowling Nights
Mix and Mingle Bingo

Casino Night
Ice Cream Socials
Late Night Breakfasts
Mardi Gras Celebration
Cinco de Mayo
Skating and Laser Tag Nights

Barton has more than 50 fun student activities planned through the year!

JOIN

THE

FUN!





Free!

PARKING!

LUNCH!

SMILES!

T-SHIRT!

APPLICATION FOR ADMISSION!

Schedule a Tour!

Monday - Friday

8:30 a.m. - 3 p.m.

bartonccc.edu/admission

(800) 722-6842

Campus visit

We'd love to meet you!

Learning wherever you are

Get a jumpstart on your future with BARTonline!

FALL 2020

Session 1	8 weeks	Aug 10 - Oct 4
Session 2	16 weeks	Aug 17 - Dec 6
Session 3	6 weeks	Sept 7 - Oct 18
Session 4	8 weeks	Oct 12 - Dec 6
Session 5	6 weeks	Oct 26 - Dec 6
Intercession	4 weeks	Dec 7 - Jan 3

SPRING 2021

Session 1	8 weeks	Jan 18 - Mar 14
Session 2	16 weeks	Jan 25 - May 15
Session 3	6 weeks	Feb 8 - Mar 21
Session 4	8 weeks	Mar 22 - May 16
Session 5	6 weeks	Apr 5 - May 6
Intercession	4 weeks	Apr 19 - May 16

SUMMER 2021

Session 1	6 weeks	May 24 - Jul 4
Session 2	8 weeks	May 31 - Jul 25
Session 3	8 weeks	Jun 14 - Aug 8
Session 4	6 weeks	Jun 28 - Aug 8
Extended	12 weeks	May 24 - Aug 15



BARTonline

Dorm life rocks!

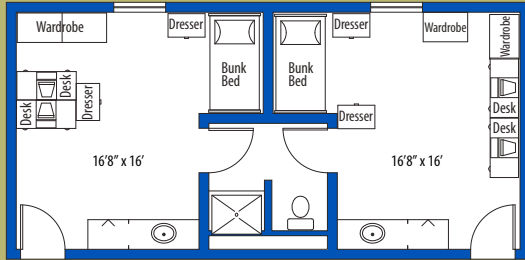

BLUESTEM HALL

Twin rooms, double occupancy - Shared bath.
Handicap accessible rooms available.

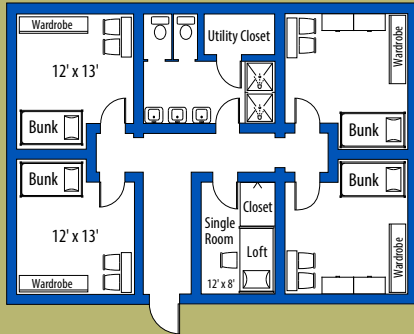

BISON HALLS

There will be some variation between units
"Community Style" (9 people per unit)

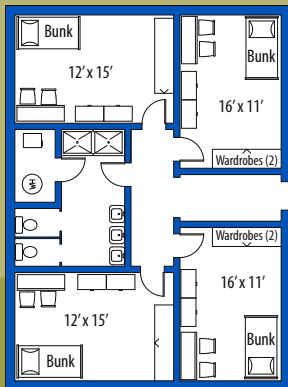

MEADOWLARK HALLS

There will be some variation between units
"Community Style" (6-8 people per unit)

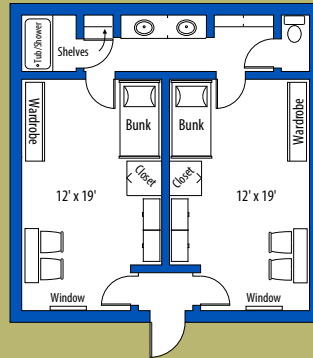

SUNFLOWER HALLS

Twin rooms, Double occupancy
Shared bath

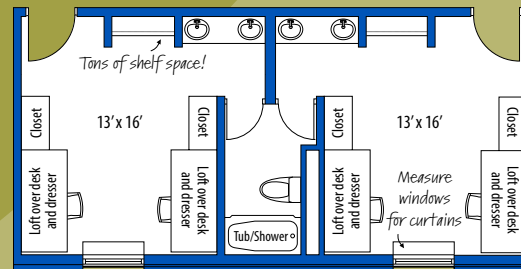

COTTONWOOD HALL

Twin rooms, Double occupancy - Shared bath
Handicap accessible rooms available

Features

- + Wireless internet campus-wide including student housing
- + Three FREE Laundromats
- + Meal plan includes 19 meals per week
- + Housing for 442 students
- + FREE cable and newly released movies available for streaming monthly
- + FREE student housing parking
- + Vending machines
- + Room furniture includes a desk, wardrobe, and extra long twin bed for each resident
- + Community meeting room with flat screen television
- + ADA compliant rooms
- + Community kitchen facilities available with stove, microwave, refrigerator and ice machine
- + Designated storm shelter areas
- + 24-hour security and camera surveillance
- + Eco-friendly drinking water stations

housing.bartonccc.edu



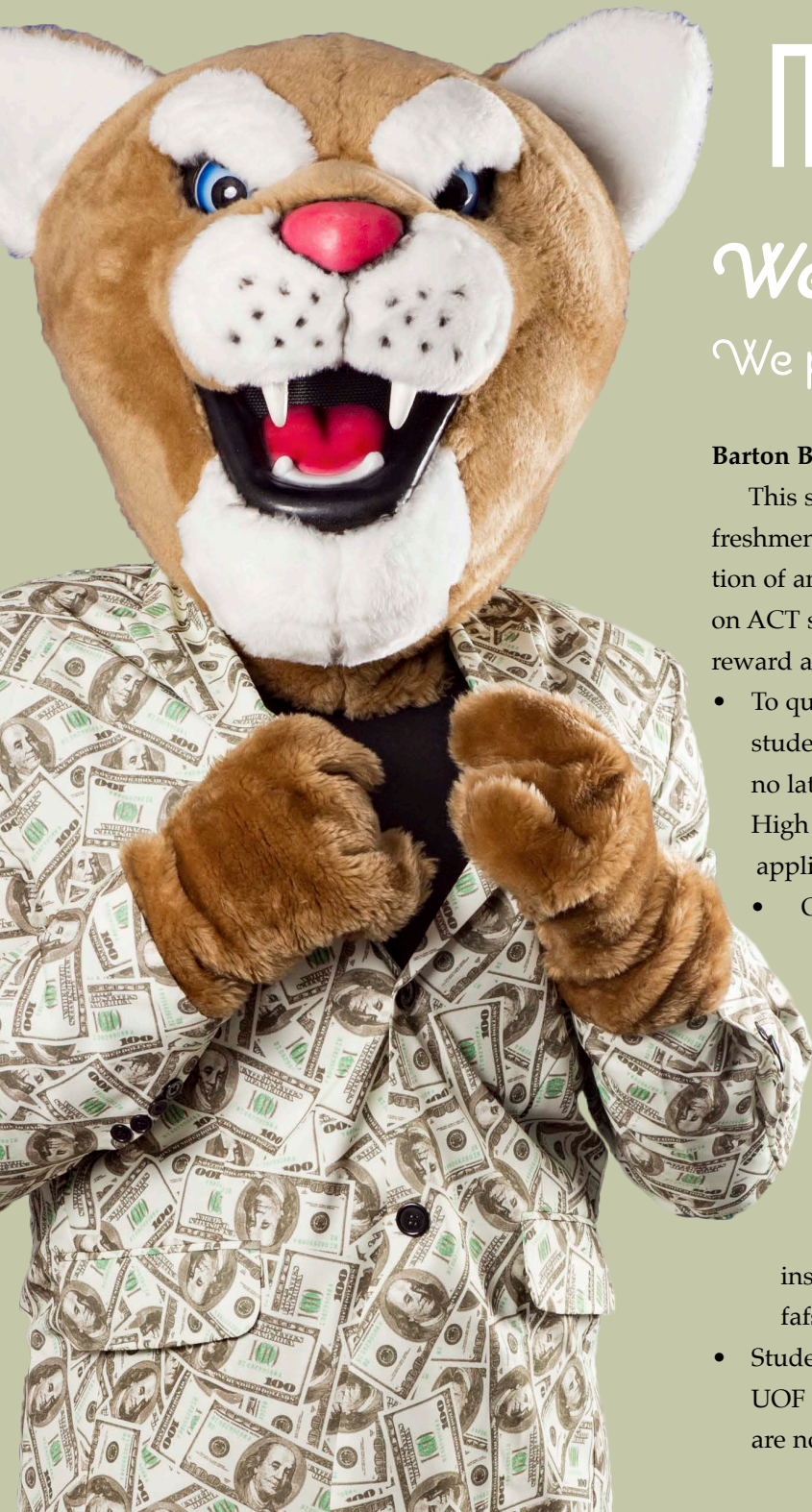

Make your dreams happen

We've got your back!

We paid out more than \$10 million in financial aid last year!

Barton Bound Scholarships

This scholarship is geared toward incoming freshmen. It is automatically applied upon completion of an Admissions Application and is based on ACT scores or GPA, whichever yields a higher reward amount. See the chart for the various levels.

- To qualify for a Barton Bound scholarship, students must submit an admissions application no later than May 1st. (Students graduating from High School in December have a December 1st application deadline.)
- Only full-time students (12 hours or more) are eligible to receive the Barton Bound scholarships.
 - The student will be offered the highest award possible based on their official HS transcript and/or ACT scores.
 - Students must complete a Free Application for Federal Student Aid (FAFSA) and send it to Barton before any institutional scholarships will be awarded. fafsa.gov - school code 004608
- Students taking courses that are covered by our UOF scholarships, such as LSEC, BSEP, TROOP, are not eligible for this scholarship.

Cost Information 2020-2021

- Fill out the free application for Federal Student Aid at fafsa.ed.gov (Barton's Code: 004608)
- Payment options also available

Cost per credit hour

In-District	\$111
In-State	\$118
Out-of-State	\$142
International	\$205

**Subject to change by the State of Kansas*

Online Costs

BARTonline	\$150 per semester credit hour
EduKan	\$150 per semester credit hour

Annual Cost Estimates - In-state

TOTAL COST** **\$10,279**

**based on 15 credit hours per semester x 2 semesters, estimated books cost and housing

Annual Cost Estimates - Out-of-state

TOTAL COST* **\$10,999**

**based on 15 credit hours per semester x 2 semesters, estimated books cost and housing

*The Barton Board of Trustees has the right to change tuition without notice.
**Cost is estimated based on basic charges and do not include other personal costs or costs associated with various classes nor cost of online courses.



- Barton institutional scholarships will not be applied toward any EduKan courses.
- The scholarship will be available up to six full-time semesters, automatically renewing based on enrollment and the students cumulative Barton GPA at the end of the spring semester. The student will not have to complete a new scholarship application for renewal of their award.
- Returning Barton students may not apply for an academic scholarship, only new /incoming students are eligible to apply.
- In addition to an academic scholarship, a student may receive federal, state, and local aid, and Barton performance or work study awards.
- Book scholarship recipients who fail to return their books by the established deadline will be charged the full price for the books. Additionally, failure to return the books to the Barton bookstore will result in the loss of the tuition/book scholarship during future semesters.

Campus Employment

Get an on-campus job that aligns with your career and education goals! Positions include photographer, office worker, bookstore employee, art gallery attendant, lifeguard, maintenance worker, computer lab monitor and more!

Activity and Departmental Scholarships

Get a scholarship for your skills or hobbies! Areas offering Activity and Departmental awards include: Admissions, Agriculture, Art, Band, Business, Cheer, Criminal Justice, Drama, Early Childhood, Engineering, EMS, HALO, Medical Assistant, MLT, Music, Natural Gas, Nursing, Networking and Student Senate.

Foundation Scholarships

Thanks to the generosity of many donors, endowments and annually funded scholarships with a wide variety of criteria are available to assist students.

Scholarship application priority deadline is June 1 prior to the academic year. The application can be found at bartoncccfoundation.org.

Barton Bound Scholarships

financialaid.bartonccc.edu

AWARD	AWARD AMOUNT	KANSAS HS GPA	OR	ACT SCORE
Excellence Award	Tuition & Books	3.6 and above	or	26+
Honor Award	\$1,000	3.0 - 3.59	or	24 - 25
Achievement Award	\$800	2.5 - 2.99	or	22 - 23

For more information, visit financialaid.bartonccc.edu

Are you ready to take the next step?



*Look what
you can do in
ONE day!*

- Meet with an academic advisor
- Plan and enroll for classes
- Meet with a Financial Aid Advisor
- Make payment arrangements with the Business Office
- Meet with Student Support Services
- Take assessment test (if needed)

Enrollment Days

Tuesday, April 20	1 p.m. & 6 p.m.	Wednesday, May 19	1 p.m.	Wednesday, July 14	1 p.m.
Wednesday, April 21	9 a.m. & 1 p.m.	Wednesday, May 26	1 p.m.	Wednesday, July 21	1 p.m.
Tuesday, April 27	1 p.m. & 6 p.m.	Wednesday, June 9	1 p.m.	Wednesday, July 28	1 p.m.
Wednesday, April 28	9 a.m. & 1 p.m.	Wednesday, June 16	1 p.m.		
Wednesday, May 5	1 p.m.	Wednesday, June 23	1 p.m.		

Sign up!

bartonccc.edu/admission

College is what you make of it

Have fun!

Enhance your college experience!

Get involved!

Meet new people!



Student Activities & Organizations

Alpha Sigma Lambda

Art Club

Barton Collegiate Farm Bureau

Barton Spark

Barton STEM

Barton Student Chapter of American
Choral Directors Association (ACDA)

Barton Theatre

Cheerleaders, Yell Leaders,
and Mascots

Christian Challenge

Community Student
Organization

Computer Club

Concert Band

Concert Choir

Contagious

Cougar Danz Force

Da Capo

Dante Deo

Dolce

Hilltop Singers

Hispanic American Leadership
Organization (HALO)

Jazz Band

Kappa Beta Chi Chapter

National Association for Music
Education (NAfME)

Non-Traditional National
Honor Society

Nursing Club

Orchestra

Pep Band

Phi Theta Kappa

Student Ambassadors

Student Government Association

Supporting you when you need it

Achieve Greatness
(We'll help!)



Academic Advising

Help select classes

Campus Security

24-hour security officers support a safe campus

TRiO

FREE services for eligible students

Tutoring

FREE peer and professional tutoring

Counseling Services

Professional and personal counseling

Health Services

FREE basic services

Career Center

Student Employment Opportunities

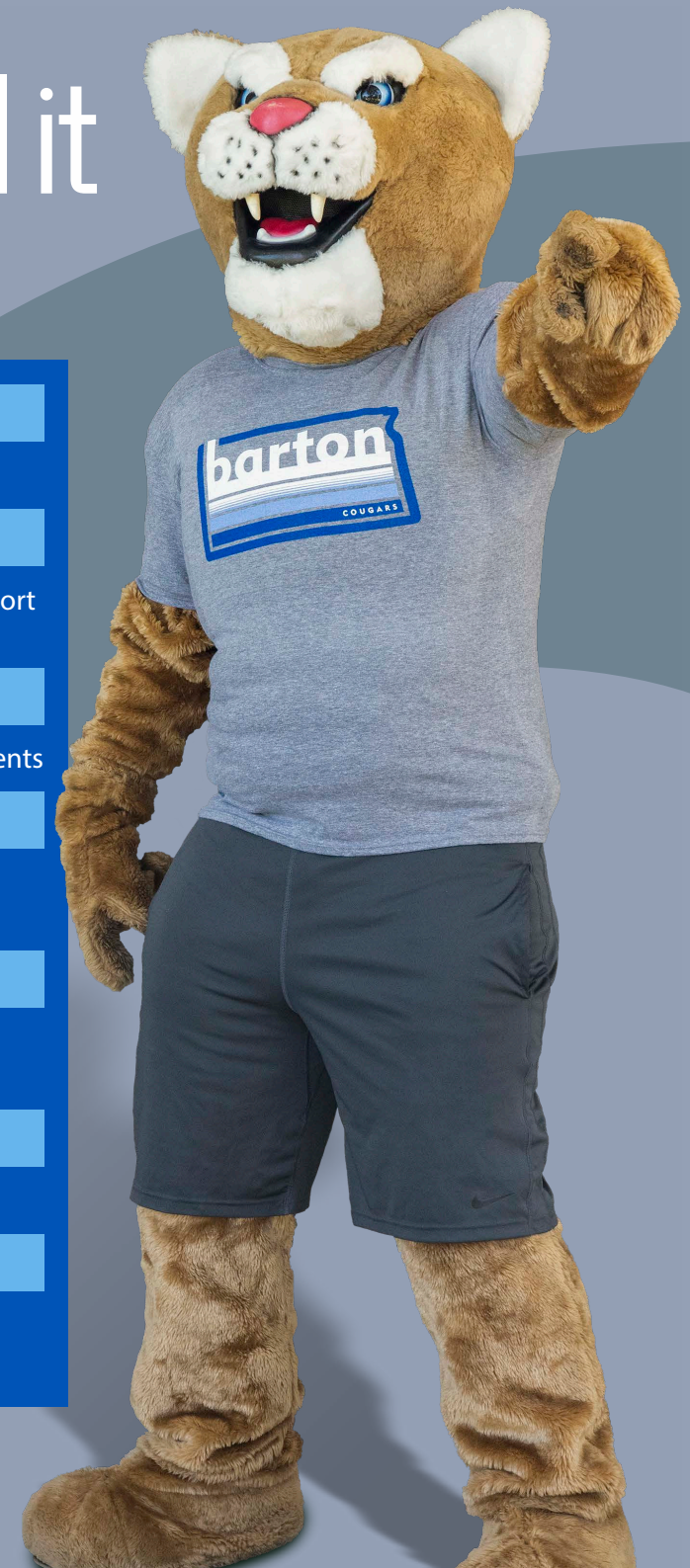



Men's Sports

BASEBALL

BASKETBALL

BOWLING

CROSS COUNTRY

ESPORTS

GOLF

SOCCER

SWIMMING

TENNIS

TRACK

WRESTLING

Women's Sports

BASKETBALL

BOWLING

CROSS COUNTRY

ESPORTS

GOLF

SOCCER

SOFTBALL

SWIMMING

TENNIS

TRACK

VOLLEYBALL

Striving for excellence

Home to 57 National Championships

BartonSports.com

Programs of Study

Transfer Programs

Transfer programs are designed to prepare you for transferring to a four-year college or university.

Career Programs

Career programs offer you an opportunity to pursue certificate and degree programs designed to prepare you for employment in the workplace and/or transfer to a university.

Location

Campus locations where program may be completed

BC = Barton County

FL = Ft. Leavenworth

FR = Ft. Riley

GV = Grandview Plaza

Outreach sites may be available

programs.bartonccc.edu

AGRICULTURE

Agribusiness (AS - BC)
Agricultural Economics (AS - BC)
Agricultural Education (AS - BC)
Agriculture Business Mgmt (AAS - BC)
Agriculture Communications (AS - BC)
Agriculture Transfer Option (AS - BC)
Agronomy (AS - BC)
Animal Science (AS - BC)
Beef Cattle Production (CERT1, CERT2 - BC)
Crop Protection (CERT1, CERT2, AAS - BC)
Food Science (AS - BC)
Forestry (AS - BC)
Golf Course Management (AS - BC)
Horticulture/Turf Management (AS - BC)
Milling Science (AS - BC)
Park Mgmt & Conservation (AS - BC)
Scales Technician (CERT1 - BC)

BUSINESS/ECONOMICS

Accounting (AS, ONLINE - BC)
Agribusiness (AS - BC)

Agricultural Economics (AS - BC)
Agriculture Business Mgmt (AAS - BC)
Bus Mgmt & Leadership (CERT1, AAS - ONLINE, BC, FR)
Business (AS - ONLINE, BC)
Business Admin Technology (AAS - ONLINE, BC)
Economics (AS - ONLINE, BC)
Finance (AS - ONLINE, BC)
Golf Course Management (AS - BC)
Management (AS - ONLINE, BC)
Marketing (AS - ONLINE, BC)
Park Mgmt & Conservation (AS - BC)
Public Administration (AS - BC)
Tech Accounting Specialist (AAS - ONLINE, BC)

COMMUNICATION

English (AA - ONLINE, BC)
Journalism (AA - BC)
Modern Languages (AA - BC)
Speech Communications (AA - BC)

COMPUTER/INFORMATION TECHNOLOGY

Computer Information Systems (AS - BC)
Computer Science (AS - BC)
Networking Specialist (CERT2, AAS - ONLINE)

EARLY CHILDHOOD

Child Development (CERT1 - ONLINE, BC)
Early Childhood (AAS - ONLINE, BC)
Early Childhood Education (AS - ONLINE, BC)

EDUCATION

Art Education (AA - BC)
Early Childhood Education (AS - ONLINE, BC)
Elementary Education (AS - BC)
Math Education (AS - ONLINE, BC)
Music Education (AA - BC)
Physical Education (AS - BC)
Secondary Education (AA, AS - ONLINE, BC)
Special Education (AS - BC)

FINE AND PERFORMING ARTS

Art (AA - BC)
Art Education (AA - BC)
Dance (AA - BC)
Digital Design (AA - BC)
Digital Photography (AA - BC)
Music (AA - BC)
Music Education (AA - BC)
Theatre (AA - BC)

GENERAL STUDIES

General Studies (AGS - ONLINE, BC, FL, FR)
Military Studies Emphasis (AGS - GV)

HEALTH PROFESSIONS

Adv Emergency Med Tech AEMT (SAPP++ - BC)
Certified Medication Aide (SAPP++ - BC)
Certified Nurse Aide (SAPP++ - BC)
Dietary Management (AS - ONLINE)
Dietary Manager (CERT1 - ONLINE)
Dietetics (AS - ONLINE)
Emergency Medical Responder (SAPP++ - BC)
EMS Instructor Coordinator (SAPP++ - BC)
EMT (SAPP+ - GV)
Medical Admin Technology (AAS - ONLINE)
Medical Assistant (CERT2, AAS - BC)
Medical Coding (CERT2 - ONLINE)
Medical Lab Technician (AAS, ONLINE - BC)
Nursing - PN (CERT3 - BC)
Nursing - Transfer (AS - BC)
Nutrition and Health (AS - ONLINE, BC)
Paramedic (CERT3, AAS - BC, GV)
Pharmacy (AS - ONLINE, BC)
Pharmacy Technician (CERT1 - ONLINE)
Phlebotomy Training (SAPP+ - BC)
Physical Therapy (AS - ONLINE, BC)
Registered Nursing (AAS, BC)

HEALTH, PHYSICAL EDUCATION, RECREATION

Athletic Training (AS - BC)
Exercise Science (AS - BC)
Physical Education (AS - BC)
Sports Management (AS - BC)

HUMANITIES AND SOCIAL SCIENCES

Anthropology Cultural Studies (AA - ONLINE, BC)
History (AA - ONLINE, BC)
Philosophy (AA - BC)
Political Science (AA - ONLINE, BC)
Psychology (AS - ONLINE, BC)
Religion (AA - BC)
Sociology (AA - ONLINE, BC)

INDUSTRIAL/ENERGY TECHNOLOGY

Gas Measurement (CERT2++ - BC)
Natural Gas Trans/Distrib Tech (CERT2, AAS - BC)
Scales Technician (CERT1 - BC)
Welding Technology (CERT1 - BC)

LIBERAL STUDIES

Liberal Studies (AA, AS - ONLINE, BC, FL, FR)

MILITARY STUDIES/LEADERSHIP

Military Leadership (CERT2++ - GV)
Military Logistics (CERT2++ - GV)
Military Dangerous Mat Handling (CERT2++ - GV)
Technical Studies (AAS++)

PRE-PROFESSIONAL

Architectural Engineering (AS - BC)
Architecture (AS - BC)
Chiropractic (AS - ONLINE, BC)
Dental Hygiene (AS - BC)
Dentistry (AS - ONLINE, BC)
Engineering Tech (AS - BC)
Health Information Mgmt (AS - ONLINE, BC)
Law (AA - ONLINE, BC)
Medicine (AS - ONLINE, BC)
Mortuary Science (AS - BC)
Occupational Therapy (AS - BC)
Optometry (AS - BC)
Pharmacy (AS - ONLINE, BC)
Physical Therapy (AS - ONLINE, BC)
Physical Therapy Asst (AS - BC)
Physicians Asst (AS - ONLINE, BC)
Radiology Tech (AS - ONLINE, BC)
Respiratory Therapy (AS - BC)
Social Work (AA - ONLINE, BC)
Veterinary Medicine (AS - ONLINE, BC)

PUBLIC SAFETY, CORRECTIONS & SECURITY

Adv Emergency Med Tech AEMT (SAPP++ - BC)
Corrections (CERT1, AAS - ONLINE)
Criminal Justice (AA, CERT3, AAS - BC)
Emerg Mgmt/Homeland Security (CERT2, AAS - ONLINE, GV)
EMT (SAPP+ - GV)
Hazardous Materials Mgmt (CERT2, AAS - ONLINE, GV)
Occupational Safety & Health (CERT1, AAS, SAPP - ONLINE, GV)
Paramedic (CERT3, AAS - BC, GV)

SCIENCE AND MATH

Biology (AS - ONLINE, BC)
Chemistry (AS - ONLINE, BC)
Engineering (AS - BC)
Geology (AS - BC)
Mathematics (AS - ONLINE, BC)
Physical Sciences (AS - ONLINE, BC)
Physics (AS - BC)
Wildlife Science (AS - ONLINE, BC)

Come visit us!

Tours are scheduled Monday through Friday, 8:30 a.m. - 3 p.m. Tour times fill quickly, so don't delay! Give us at least a week's notice, and we'll get your visit scheduled to fit YOUR needs!

Call (800) 722-6842 to schedule a tour today! bartonccc.edu/admission

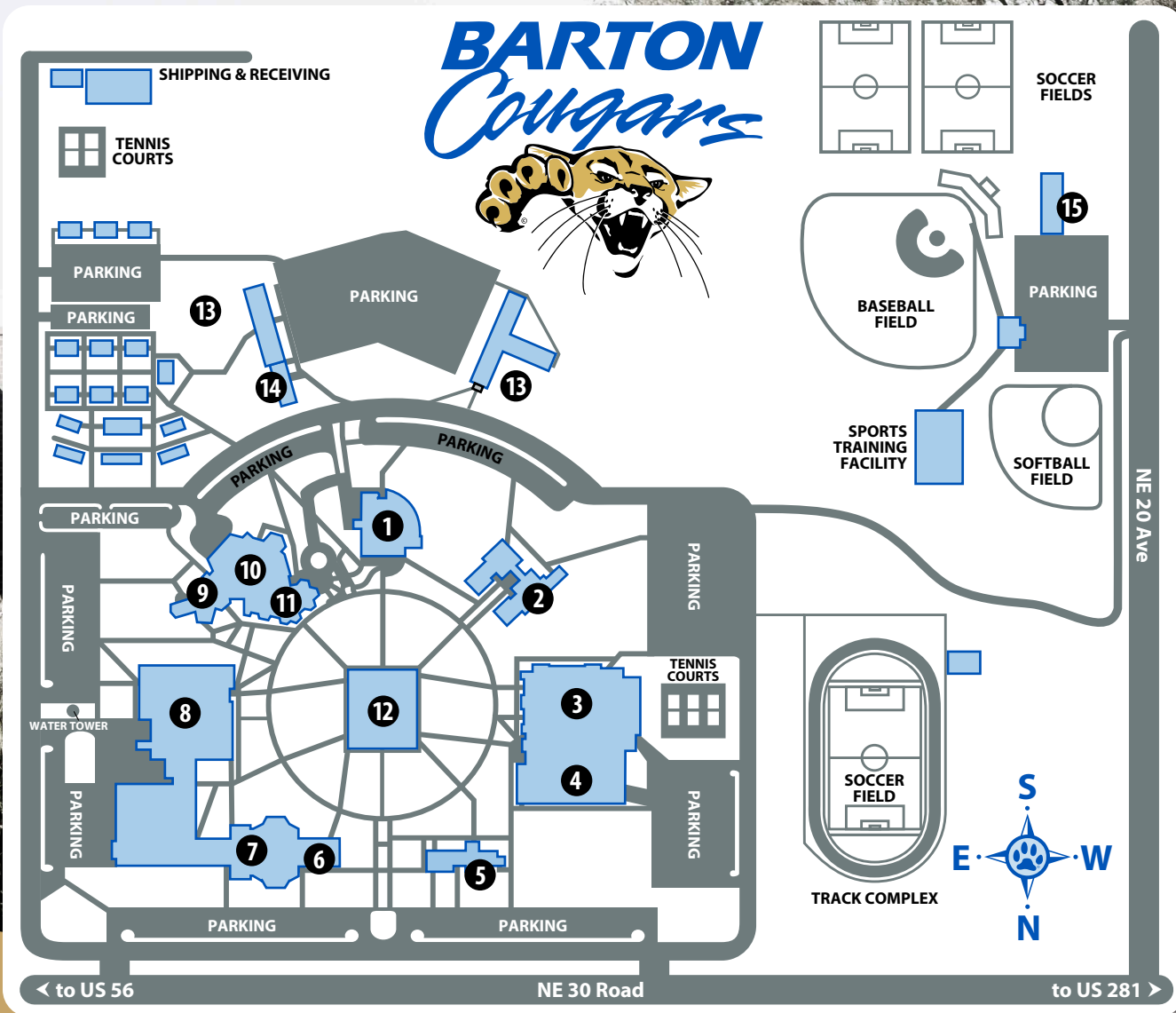

Great Bend campus



- ① U-Building, Union
- ② C-Building, Classroom
- ③ P-Building, Physical Education
- ④ Kirkman Student Activity Center
- ⑤ A-Building, Administration
- ⑥ Planetarium
- ⑦ S-Building, Science & Math
- ⑧ T-Building, Technical Education
- ⑨ F-30, Seminar Room
- ⑩ F-Building, Fine Arts
- ⑪ Shafer Gallery
- ⑫ L-Building, Learning Resources Center
- ⑬ Student Housing
- ⑭ Child Development Center
- ⑮ Midwest Utility Pipeline Training Center

About our campuses



GREAT BEND CAMPUS

bartonccc.edu

Barton's main campus is located high atop a hill on 160 acres three miles northeast of Great Bend. The main campus includes eight primary buildings, four phases of student housing, the Cougar fields, and the Midwest Utility Pipeline Training Center.

FORT RILEY CAMPUS

FR.bartonccc.edu

Barton's proud association with Fort Riley and the U.S. Army began in 1984 with a single training contract. The Fort Riley campus administration building is located in Building 211 on the main post of Fort Riley. The campus also provides instructional services for Troop School, BSEP and LSEC, which are located on Custer Hill.

Courses also are offered at a nearby outreach site located at Grandview Plaza, which is home to the Hazardous Materials Handling and Emergency Management, Emergency Medical Technician, and Paramedic programs.

FORT LEAVENWORTH CAMPUS

FL.bartonccc.edu

Barton opened a campus on Fort Leavenworth in 2012. With nearly three decades of experience operating a military-based campus at Fort Riley, Barton was well-equipped to hit the ground running. The Fort Leavenworth campus office is located in the basement of the Army Education Center at 120 Dickman Ave. Fort Leavenworth, KS 66027. The campus also provides instructional services for BSEP and LSEC and College Program evening courses.

Cougar checklist

- ✓ **Campus Tour** | A great way to see if Barton is the place for you!
- ✓ **Admissions/Scholarship Application** | Application available online.
- ✓ **Submit ACT Scores or other test scores** | Haven't taken any assessment tests? No problem! Just give us a call and we'll get you taken care of.
- ✓ **Submit completed transcript** | Completed high school transcript must be mailed directly to Barton Community College to be official. Unofficial transcripts can be used for advising and obtaining academic information (GPA, ACT Scores, etc.)
- ✓ **Housing Application** | Submit application and deposit early to get your first choice! Application available online.
- ✓ **Financial Aid** | Cost should not be a reason to rule out college! Visit fafsa.ed.gov for federal assistance or call us for even more options!



Want to get started? |

For more information, call the Admissions Office at (800) 722-6842 or (620) 792-9286

Directory information

BARTON COUNTY CAMPUS

Local: (620) 792-2701
Toll-Free: (800) 748-7594
Address:
245 NE 30 RD
Great Bend, KS 67530
bartonccc.edu

FORT RILEY CAMPUS

Local: (785) 784-6606
Toll-Free: (877) 620-6606
Address:
Bldg. 211 Custer Ave., P.O. Box 2463
Fort Riley, KS 66442
FR.bartonccc.edu

FORT LEAVENWORTH CAMPUS

Local: (913) 684-9384
Toll-Free: (855) 509-3374
Address:
120 Dickman Ave.
Fort Leavenworth, KS 66027
FL.bartonccc.edu

GRANDVIEW PLAZA OUTREACH SITE

Local: (785) 238-8550
Toll-Free: (877) 771-0255
Address:
100 Continental Ave.
Grandview Plaza, KS 66441
hmesi.bartonccc.edu

ONLINE LEARNING OPPORTUNITIES

online.bartonccc.edu
(866) 455-2828
edukan.org
(877) 433-8526

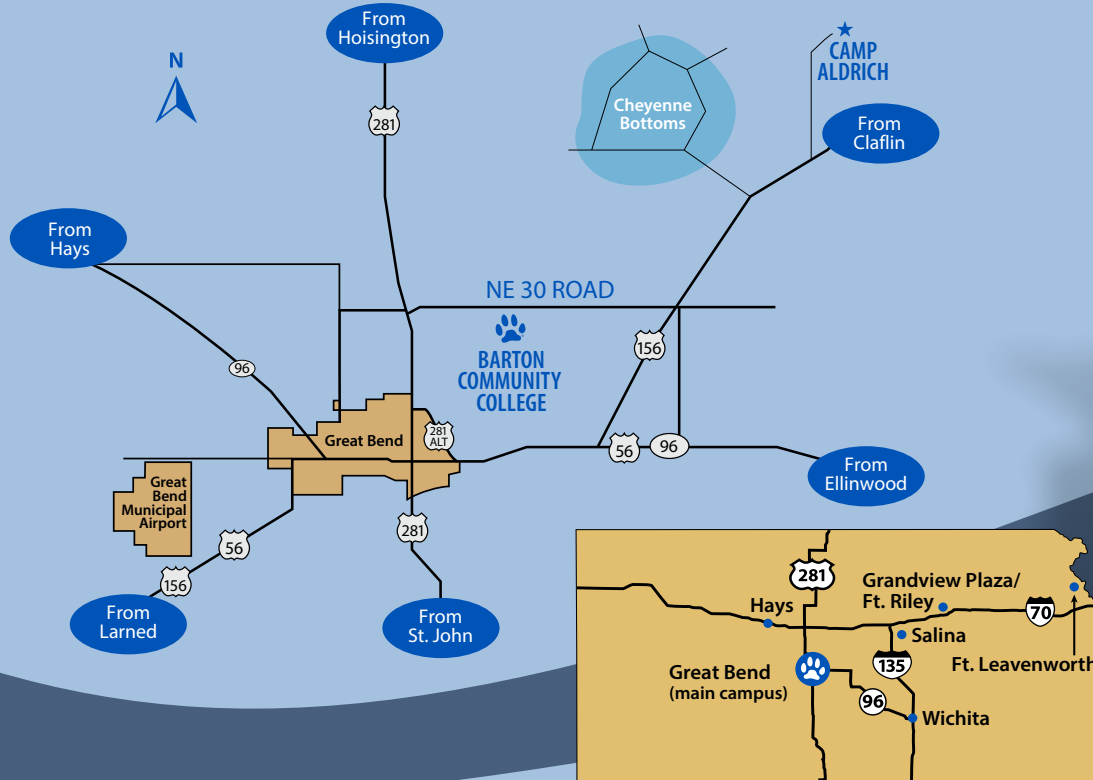

Non-Discrimination Notice: To provide equal employment, advancement and learning opportunities to all individuals, employment and student admission decisions at Barton will be based on merit, qualifications, and abilities. Barton County Community College does not discriminate on the basis of any characteristic protected by law in all aspects of employment and admission in its education programs or activities. Any person having inquiries concerning Barton County Community College's non-discrimination compliance policy, including the application of Equal Opportunity Employment, Titles IV, VI, VII, IX, Section 504 and the implementing regulations, is directed to contact the College's Compliance Officer, Barton County Community College, Room A-123, Great Bend, Kansas 67530, (620) 792-2701. Any person may also contact the Director, Office of Civil Rights, U.S. Department of Education, Washington, DC 20201.