



WELCOME

50th Anniversary Open House Celebration September 28, 2019

11 a.m. - 4 p.m.	Family friendly activities - explore campus!
11 a.m.	Food trucks open
Noon	Welcome: President Dr. Carl Heilman (Food Court)
1 - 3 p.m.	Program Expo (Schedule on page 4)
3 p.m.	Fine and Performing Arts Concert
4 pm.	Event concludes

Cheer on Barton Athletics!

Women's Soccer vs Garden City | 2 p.m.

Men's Soccer vs Garden City | 4:30 p.m.

#Barton50

*Look for our volunteers wearing lanyards if you need
directions or help with anything!*

CAMPUS MAP

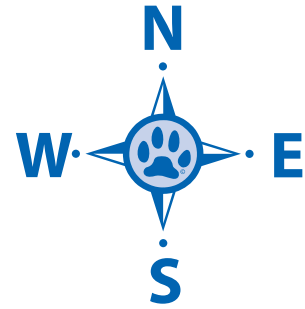

TRACK COMPLEX



LEGEND	
Seating	
Building closed to the public	
Restrooms	

ACTIVITIES	TIME	LOCATION
Welcome Stations	All day	
Photo Op with Bart & Miss Kitty	11 a.m. - 1 p.m.	Food Court
Women's Soccer Men's Soccer	2 p.m. 4:30 p.m.	Soccer Field
Barton Family Tree	All day	
Bounce Houses	All day	
Coloring, Pumpkin painting, Crafts, Face painting	All day	
Get your FREEbies at the prize table! Prize ticket in tote bag	All day	
Giant Lawn Games, Haybale Maze	All day	
Learn About Barton's History	All day	Learning Resource Center



In the event of rain, all activities will be moved indoors to the nearest building.

PROGRAM EXPO

1-3 p.m.

SCIENCE & TECHNICAL BUILDING

PROGRAM	TIME	LOCATION
Active Learning Classroom	1-3 p.m.	C150
Adult Education	1-3 p.m.	T177
Adult Healthcare	1-3 p.m.	T119
Automotive Technology	1-3 p.m.	T174
BARTonline	1-3 p.m.	Lobby
Business	1-3 p.m.	T103
Ceramics Demo	1-3 p.m.	T151
College Advantage (High School Dual Credit Opportunities)	1-3 p.m.	Lobby
Corrections	1-3 p.m.	T111 and T115
Criminal Justice	1-3 p.m.	T107
Developmental Education Lab	1-3 p.m.	C107 & C108
Dietary Manager	1-3 p.m.	T97 and T98
Early Childhood	1-3 p.m.	T147
Essential Workplace Skills	1-3 p.m.	T117
Fine and Performing Arts Concert	3 p.m.	Auditorium, Fine Arts Building (pg. 7)
Fort Riley & Fort Leavenworth Campuses	1-3 p.m.	T185
Grandivew Plaza (OSHA + HAZMAT + EMHS + Military Schools)	1-3 p.m.	T184
K-State@Barton	1-3 p.m.	S106
Medical Support Programs	1-3 p.m.	T143
Medical Laboratory Technician	1-3 p.m.	S116
Nursing	1-3 p.m.	T98 and T99
Pharmacy Technician	1-3 p.m.	T97 and T98
Planetarium - "50 Years Since Apollo 11"	11:20 a.m. 1 p.m. 2 p.m.	S101
Scales Technician	1-3 p.m.	T163
STEM / Maker Lab / KSU grant	1-3 p.m.	S112
Touch-A-Truck: Ag, Case-New Holland, CDL, Emergency Medical Services, Hot Rod, Natural Gas, Hazardous Materials	All day	North Science Building parking lot
Life Sciences (Ultrasound/EKG)	1-3 p.m.	S120
Upward Bound	1-3 p.m.	S106
Welding	1-3 p.m.	T172

FOOD VENDORS - T186 FOOD COURT	
Adas Fruitland	Shaved Ice, Fruit Water, Fruit Cups
Bubba's Grub Kitchens	Philly Sandwiches and Deep Fried Sweets
Papa Murphy's	Pizza by the Slice
Plum Crazy	BBQ
Sabores De Mexico Briseno	Tacos
Sue Roberts	Roasted Corn
The Spread Catering Company	Big City Flavor, Hometown Love

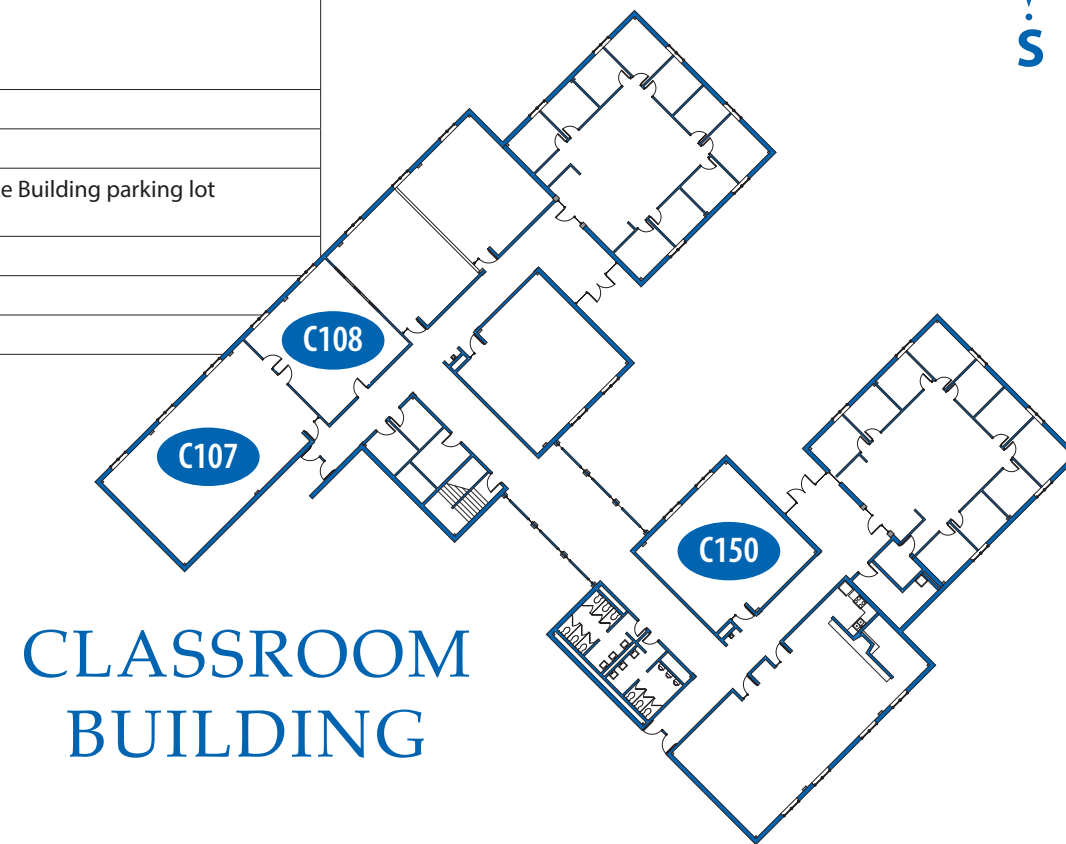
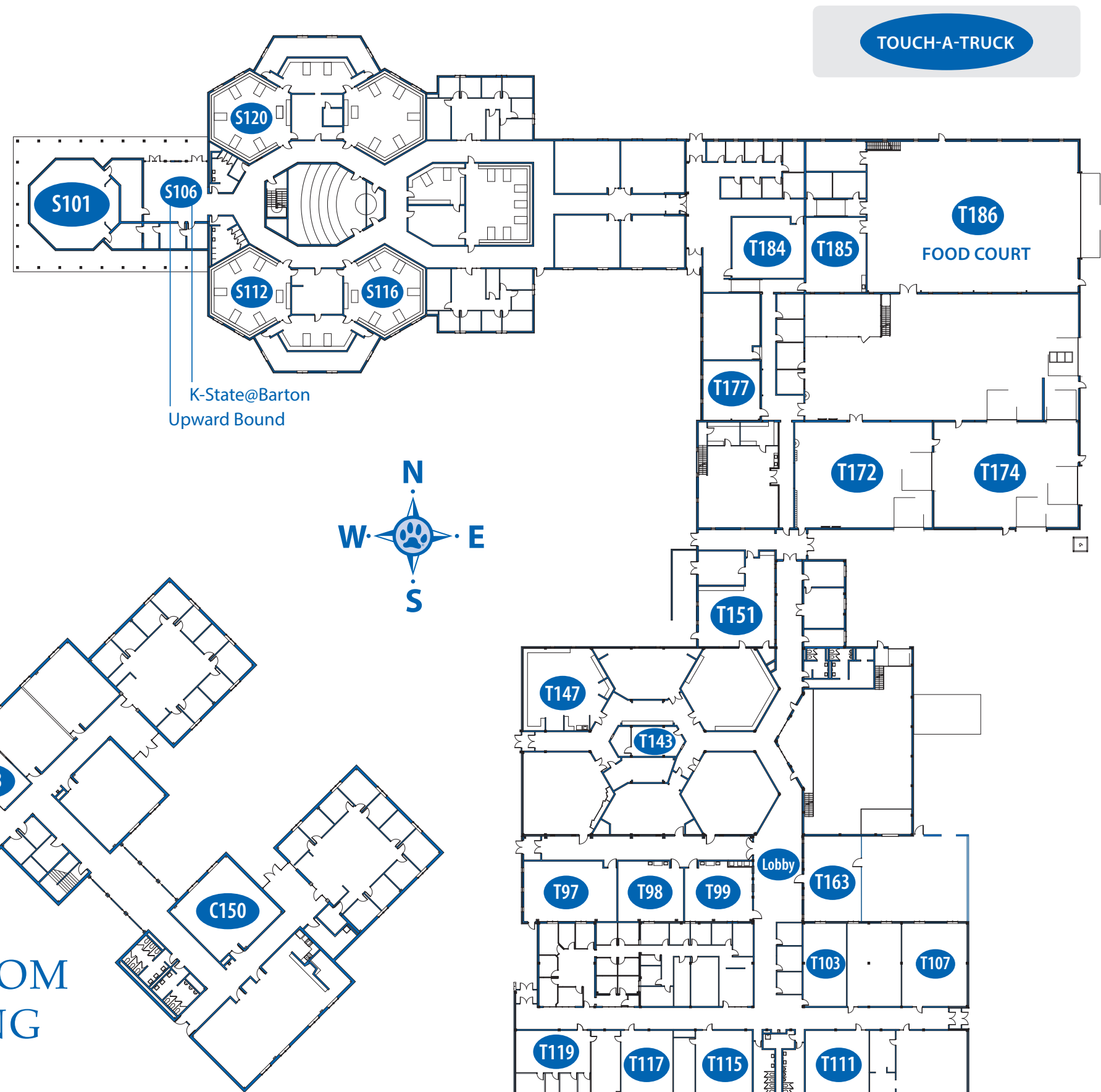

KIRKMAN STUDENT ACTIVITY CENTER

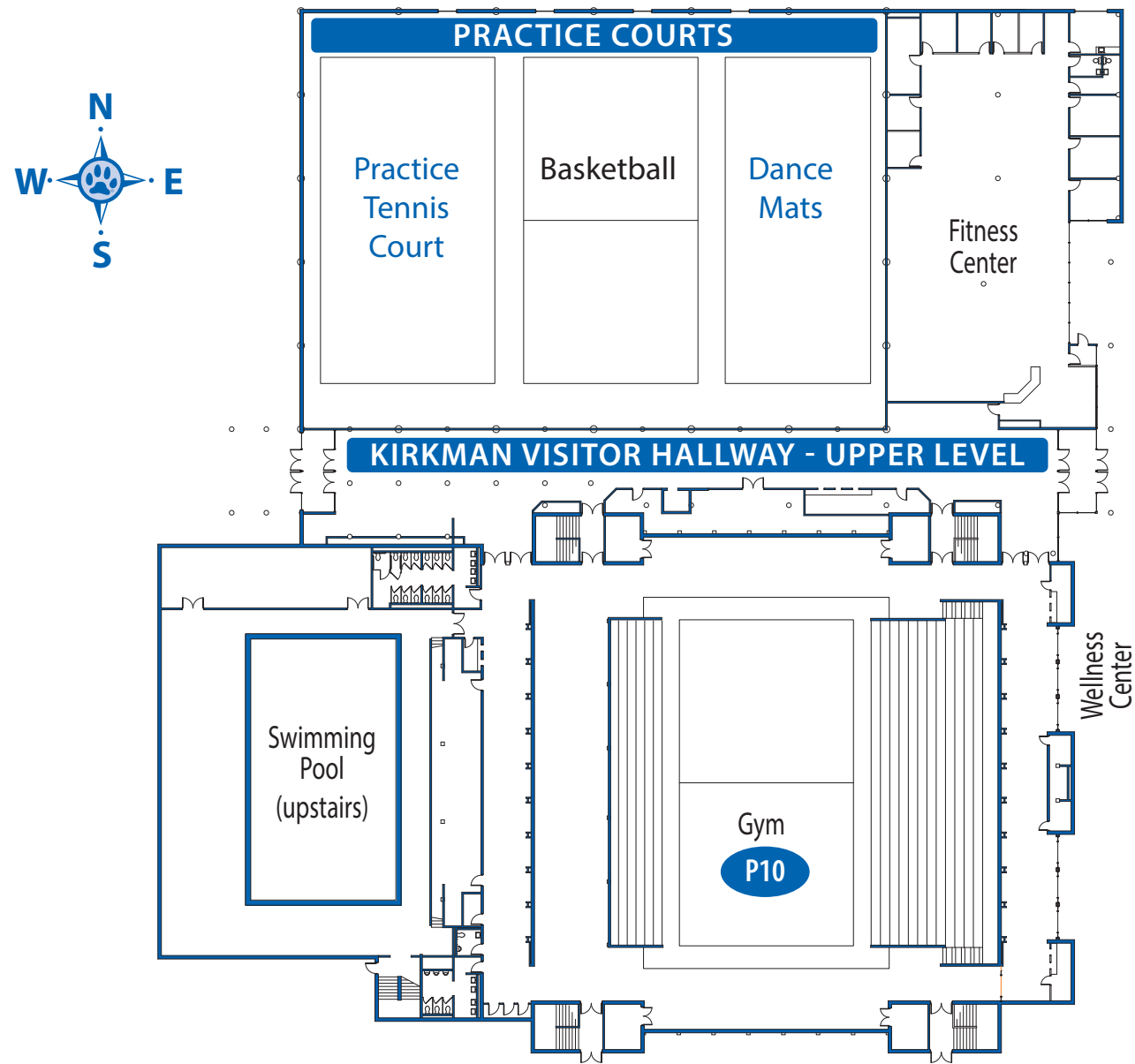

EVENT	LOCATION	TIME
Sign up for a campus tour or apply for a chance to win a scholarship Employment Opportunities What's New@Barton Prize Table	Kirkman Visitor Hallway - upper level	All day
Cougar Booster Club	Kirkman Visitor Hallway - upper level	1 -3 p.m.
Dancing Through 50 Decades (Movement activity)	Dance Mats	11:20 a.m. 12:20 p.m.
Free Throw and Hot Shot Contests	Gym, P10	12:30 - 2 p.m.
Children's swimming activities - bring your suit and towel!	Swimming Pool	12:30 - 2 p.m.
Tennis activity	Practice Tennis Court	12:30 - 2 p.m.

FINE ARTS BUILDING

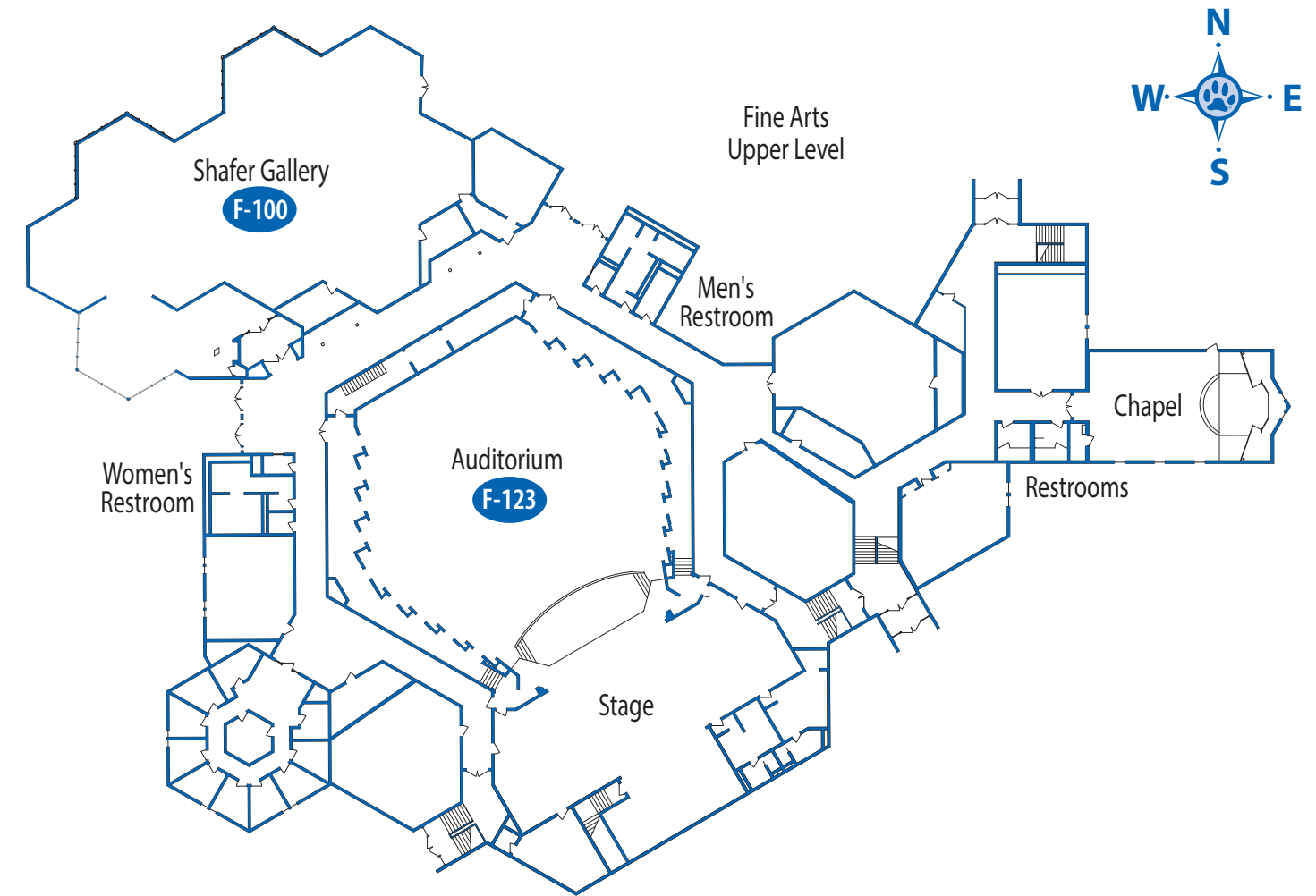

EVENT	LOCATION	TIME
The Light of Future Past: Photography by Blair Hayes exhibit	Shafer Gallery, F-100	All day
Hands-on Art Projects	Shafer Gallery, F-100	1 - 3 p.m.
50th Anniversary Fine and Performing Arts Concert (open to the public) All Barton 50th Anniversary visitors are invited to cap off the day with featured live performances by the Barton Jazz Ensemble, Barton Art Program, Barton Dance Theatre, Barton Theatre, and the Hilltop Singers featuring the Hilltop Singer Alumni Choir!	Auditorium, F-123	3 - 4:15 p.m.

****NOTE: No food or drinks are allowed in Fine Arts Building.**

LEARNING RESOURCE CENTER

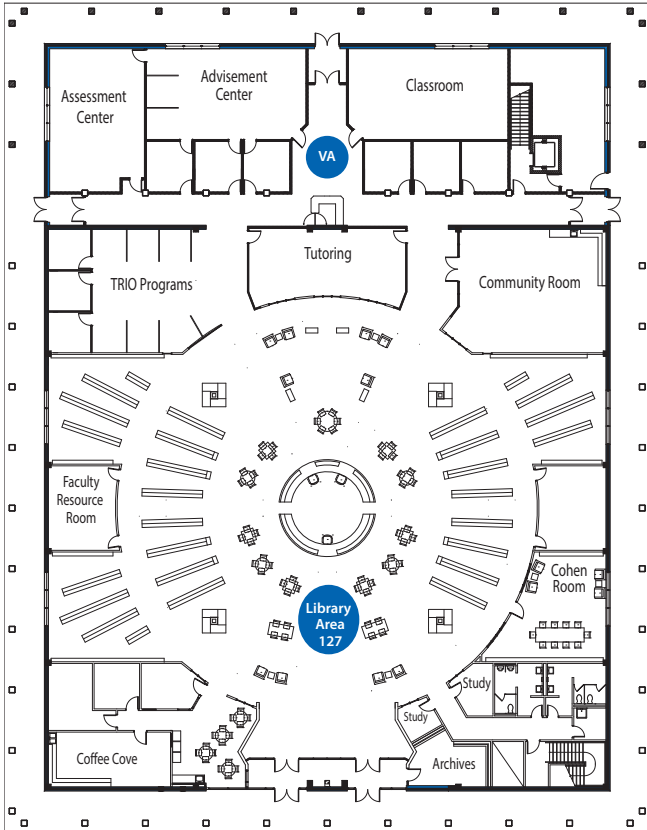

EVENT	LOCATION	TIME
Can you find me? Interactive yearbook display	L127	All day
Who am I? Interactive display of College history	L127	All day
Get to Know Your Library! Interactive Card Catalog	L127	All day
50th Anniversary College history display	L127	All day
Veterans Assistance information	VA	Noon - 3 p.m.

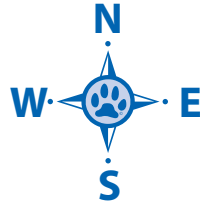

STUDENT UNION

Student Union
Upper Level

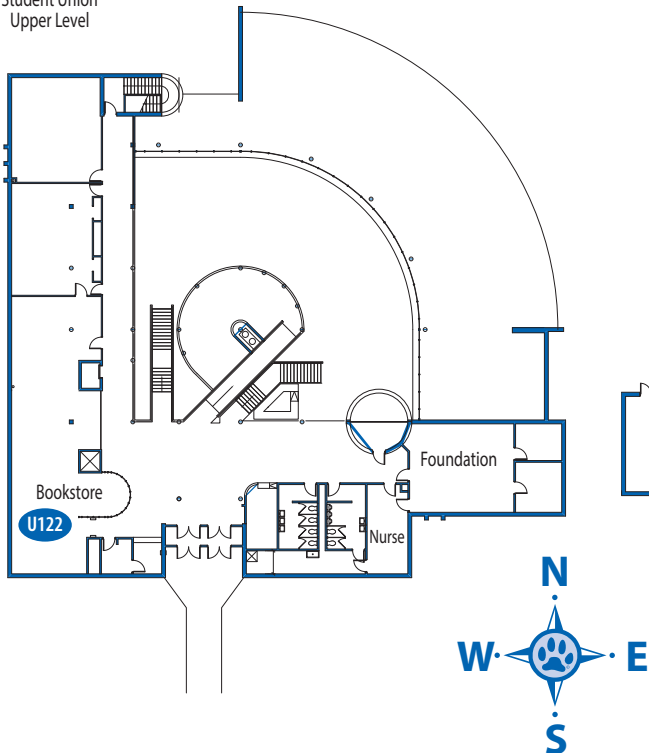

EVENT	LOCATION	TIME
Barton merchandise	Bookstore, U122	1-3 p.m.

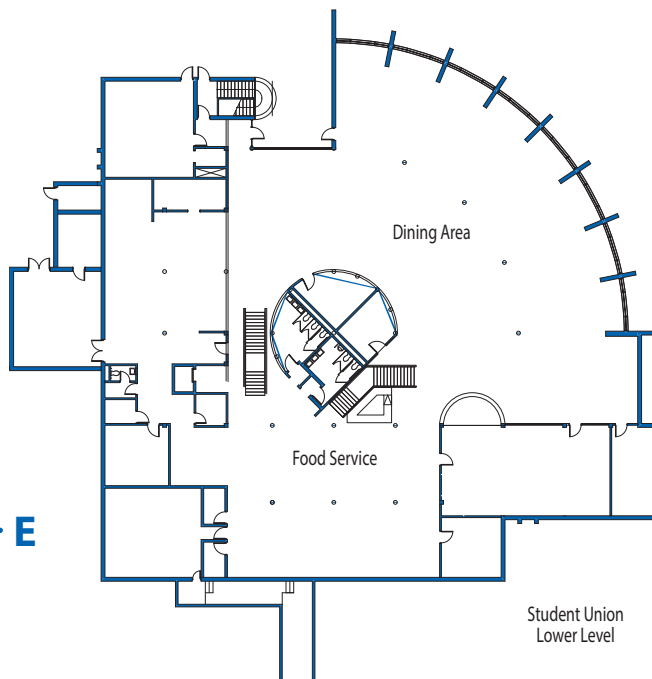

Student Union
Lower Level